

INSTRUCTIONS FOR SIMTAP™ SHELL CUTTERS AND HOLESAWS

Refer to the Ford® website (www.fordmeterbox.com) for additional and most recent installation instructions and product information.

For general machine operation and other cutter types, refer to the instructions supplied with the Ford Simtap™ Drilling Machine.

1. A practice cut in the shop is advised to ensure familiarity with these instructions and to develop a feel for the cutter's operating characteristics.
2. Handle the cutter with care to ensure the carbide teeth are not damaged. Place the cutter in the supplied protective container whenever it is not in use.
3. The Pilot Drill coupon retaining wire should extend 1/16" minimum beyond the cutter (see illustration).

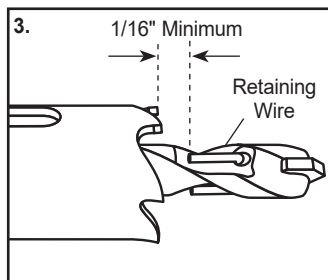

over

4. When drilling ductile iron pipe, we recommend using a low viscosity, food-grade lubricant or grease. Do not use grease or lubricant that will allow chips to adhere to the cutters.

5. To start the cutting process, LOWER THE PILOT BIT AND CUTTER GENTLY onto the pipe; rough handling will damage the carbide teeth.

6. Make sure the cutter rotates in the cutting (clockwise) direction only. Rotating in the reverse direction will damage the carbide teeth. ALWAYS ROTATE CLOCKWISE.

7. Begin cutting the pipe with a SLOW SPEED and light force to allow the cutter to engage the pipe properly. Once all the cutter's teeth begin cutting the pipe, apply slightly more force. Allow the tool to cut at a moderate rate.

8. When nearing the end of the cut, reduce the force to allow the cutter to finish the cut cleanly. This will prevent pushing through the pipe and breaking the cutter's teeth. A clean cut will provide better coupon retention.



The Ford Meter Box Company, Inc.

P.O. Box 443,

Wabash, IN 46992-0443

Ph: 260-563-3171 / FAX: 800-826-3487

www.fordmeterbox.com

020474

09/2025

4. When drilling ductile iron pipe, we recommend using a low viscosity, food-grade lubricant or grease. Do not use grease or lubricant that will allow chips to adhere to the cutters.

5. To start the cutting process, LOWER THE PILOT BIT AND CUTTER GENTLY onto the pipe; rough handling will damage the carbide teeth.

6. Make sure the cutter rotates in the cutting (clockwise) direction only. Rotating in the reverse direction will damage the carbide teeth. ALWAYS ROTATE CLOCKWISE.

7. Begin cutting the pipe with a SLOW SPEED and light force to allow the cutter to engage the pipe properly. Once all the cutter's teeth begin cutting the pipe, apply slightly more force. Allow the tool to cut at a moderate rate.

8. When nearing the end of the cut, reduce the force to allow the cutter to finish the cut cleanly. This will prevent pushing through the pipe and breaking the cutter's teeth. A clean cut will provide better coupon retention.

INSTRUCTIONS FOR SIMTAP™ SHELL CUTTERS AND HOLESAWS

Refer to the Ford® website (www.fordmeterbox.com) for additional and most recent installation instructions and product information.

For general machine operation and other cutter types, refer to the instructions supplied with the Ford Simtap™ Drilling Machine.

1. A practice cut in the shop is advised to ensure familiarity with these instructions and to develop a feel for the cutter's operating characteristics.

2. Handle the cutter with care to ensure the carbide teeth are not damaged. Place the cutter in the supplied protective container whenever it is not in use.

3. The Pilot Drill coupon retaining wire should extend 1/16" minimum beyond the cutter (see illustration).

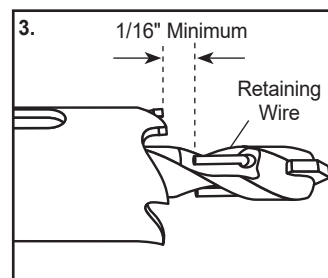

over



The Ford Meter Box Company, Inc.

P.O. Box 443,

Wabash, IN 46992-0443

Ph: 260-563-3171 / FAX: 800-826-3487

www.fordmeterbox.com

020474

09/2025

INSTRUCTIONS FOR SIMTAP™ SHELL CUTTERS AND HOLESAWS

Refer to the Ford® website (www.fordmeterbox.com) for additional and most recent installation instructions and product information.

For general machine operation and other cutter types, refer to the instructions supplied with the Ford Simtap™ Drilling Machine.

1. A practice cut in the shop is advised to ensure familiarity with these instructions and to develop a feel for the cutter's operating characteristics.
2. Handle the cutter with care to ensure the carbide teeth are not damaged. Place the cutter in the supplied protective container whenever it is not in use.
3. The Pilot Drill coupon retaining wire should extend 1/16" minimum beyond the cutter (see illustration).

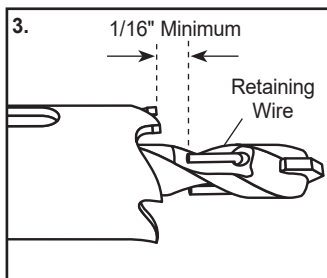

over

4. When drilling ductile iron pipe, we recommend using a low viscosity, food-grade lubricant or grease. Do not use grease or lubricant that will allow chips to adhere to the cutters.

5. To start the cutting process, LOWER THE PILOT BIT AND CUTTER GENTLY onto the pipe; rough handling will damage the carbide teeth.

6. Make sure the cutter rotates in the cutting (clockwise) direction only. Rotating in the reverse direction will damage the carbide teeth. ALWAYS ROTATE CLOCKWISE.

7. Begin cutting the pipe with a SLOW SPEED and light force to allow the cutter to engage the pipe properly. Once all the cutter's teeth begin cutting the pipe, apply slightly more force. Allow the tool to cut at a moderate rate.

8. When nearing the end of the cut, reduce the force to allow the cutter to finish the cut cleanly. This will prevent pushing through the pipe and breaking the cutter's teeth. A clean cut will provide better coupon retention.



The Ford Meter Box Company, Inc.

P.O. Box 443,
Wabash, IN 46992-0443

Ph: 260-563-3171 / FAX: 800-826-3487

www.fordmeterbox.com

020474

09/2025

4. When drilling ductile iron pipe, we recommend using a low viscosity, food-grade lubricant or grease. Do not use grease or lubricant that will allow chips to adhere to the cutters.

5. To start the cutting process, LOWER THE PILOT BIT AND CUTTER GENTLY onto the pipe; rough handling will damage the carbide teeth.

6. Make sure the cutter rotates in the cutting (clockwise) direction only. Rotating in the reverse direction will damage the carbide teeth. ALWAYS ROTATE CLOCKWISE.

7. Begin cutting the pipe with a SLOW SPEED and light force to allow the cutter to engage the pipe properly. Once all the cutter's teeth begin cutting the pipe, apply slightly more force. Allow the tool to cut at a moderate rate.

8. When nearing the end of the cut, reduce the force to allow the cutter to finish the cut cleanly. This will prevent pushing through the pipe and breaking the cutter's teeth. A clean cut will provide better coupon retention.



The Ford Meter Box Company, Inc.

P.O. Box 443,
Wabash, IN 46992-0443

Ph: 260-563-3171 / FAX: 800-826-3487

www.fordmeterbox.com

020474

09/2025

INSTRUCTIONS FOR SIMTAP™ SHELL CUTTERS AND HOLESAWS

Refer to the Ford® website (www.fordmeterbox.com) for additional and most recent installation instructions and product information.

For general machine operation and other cutter types, refer to the instructions supplied with the Ford Simtap™ Drilling Machine.

1. A practice cut in the shop is advised to ensure familiarity with these instructions and to develop a feel for the cutter's operating characteristics.

2. Handle the cutter with care to ensure the carbide teeth are not damaged. Place the cutter in the supplied protective container whenever it is not in use.

3. The Pilot Drill coupon retaining wire should extend 1/16" minimum beyond the cutter (see illustration).

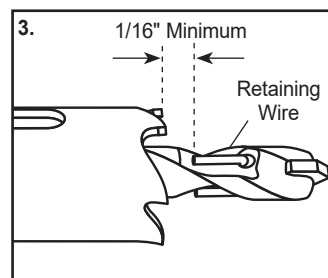

over