

FORD METER BOXES

SECTION C

METER BOX TYPE		OPTIONS	
CB	= Crescent Box	G	= Grip Joint Connections
DG	= Double Gulfbox	K	= "Linesaver" Upper Body Casting
DGHC	= Long Double Gulfbox with Cartridge Dual Check Valves	LL	= Lockless Lid
G	= Gulfbox	P	= Plastic Lid
GHC	= Long Gulfbox with Cartridge Dual Check Valve	PB	= Plastic Lid with ERT Bracket (bracket option not for "YS" Yokebox)
LYLB	= Single Ball Valve Long Yokebox with Cartridge Dual Check Valve ◇	PLB	= Plastic Lid with large ERT Bracket (bracket option not for "YS" Yokebox)
LYLBB	= Double Ball Valve Long Yokebox with Cartridge Dual Check Valve ◇	P4	= 4" Plastic Riser
LYLV	= Single Key Valve Long Yokebox with Cartridge Dual Check Valve ◇	RL	= Reading Lid (hinged cast iron flap)
LYLVV	= Double Key Valve Long Yokebox with Cartridge Dual Check Valve ◇	RW	= Reclaimed Water Lettering on Lid
YL	= Shallow Yokebox ◇ ▲	RWC	= Reclaimed Water Lettering on Purple Lid
YLB	= Shallow Ball Valve Yokebox ◇ ▲	SP	= Spacer in Lieu of Dual Check Valve for Long Yokebox
YLBHC	= Shallow Ball Valve Yokebox with Cartridge Dual Check Valve ◇ ▲	T	= Electronic Meter Reading Lid, 2" Hole
YLHC	= Shallow Yokebox with Cartridge Dual Check Valve ◇ ▲	TP	= Electronic Meter Reading Lid, 2" Hole With Removable Plug
YM	= Deep Yokebox ▲	U-NA	= Ultra-Tite Compression (not assembled)
YMB	= Deep Ball Valve Yokebox ▲		
YMBHC	= Deep Ball Valve Yokebox with Cartridge Dual Check Valve ▲		
YMHC	= Deep Yokebox with Cartridge Dual Check Valve ▲		
YS	= Extra Shallow Key Valve Yokebox		
YSB	= Extra Shallow Ball Valve Yokebox		
YSBHC	= Extra Shallow Ball Valve Yokebox with Cartridge Dual Check Valve		

Optional Enlarged Plastic Upper Section and Lid (YL or YM Yokebox only)
▲ JP = Add "-JP" to end of alpha code and insert "-P" into the catalog number.
Example: YLJPxxx-xxx-P-NL
◇ P = Optional Plastic Upper Section, Shallow Box (LYL or YL Yokebox only)
Example: LYLBPxxx-xxx-NL

YLB

JP

122

-

233

-

PB

-

NL

NO-LEAD

SERVICE LINE POSITION	TYPE OF INLET - OUTLET	METER SIZE	SIZE OF INLET - OUTLET
1 = Straight Inlet and Outlet	1 = Female Iron Pipe Threads or Double Purpose (inlet only)*	1 = 5/8"	1 = 1/2"
2 = Angle Inlet and Straight Outlet	2 = Flare Copper Tube Nut	2 = 5/8" x 3/4"	2 = 5/8"
3 = Angle Inlet and Outlet	4 = Pack Joint for Plastic or Copper*	3 = 3/4"	3 = 3/4"
4 = Straight Inlet and Angle Outlet	5 = Pack Joint for Iron Pipe	4 = 1"	4 = 1"
	6 = Pack Joint for PE Pipe		
	7 = Pack Joint for PVC/IPS PE** Pipe		
	8 = Male Iron Pipe Threads		

* Only straight key valves have double purpose service line connections
Note: See item listings in catalog section to ensure that desired sizes and options are available.

* Ford Pack, Quick and Grip Joint compression connections, when used on copper, are designed for Type K or Type L copper only.
** Schedule 40 and 80 or DR9 and DR11 IPS PE

FORD ELECTRONIC METER READING COVER OPTION

Special lids for Ford Yokeboxes and Gulfboxes are available with precast holes for electronic meter reading modules. This option is designated with a "-T" for a single hole cover and "-NPR" for a Maxi Pit Pro Read. For an optional 2" hole plug, removable for future electronic meter reading module installation, use "-TP". For the "-TP" option add \$ 15.30
Example: YMB122-233-TP-NL

For plastic plug, use "-PTP". For the "-PTP" option add \$ 16.90
Example: YMB122-233-PTP-NL

For plastic plug with AMR bracket, use "-PTP-BR". For the "-PTP-BR" option add \$ 21.45
Example: YMB122-233-PTP-BR-NL

FORD LONG YOKEBOXES FOR 5/8" METERS

Center Line of Meter 8" Below Grade

Straight Inlet - Straight Outlet

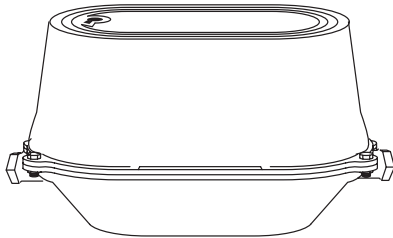

STRAIGHT BALL VALVE INLET - STRAIGHT OUTLET

CATALOG NUMBER	DESCRIPTION		APPROX. WT. LBS.	LIST PRICE
	INLET	OUTLET		
LYLB111-133-NL	3/4" Female Iron Pipe Threads	3/4" Female Iron Pipe Threads	47.0	\$ 600.91
LYLB122-133-NL	3/4" Flare Copper	3/4" Flare Copper	47.0	626.92
►LYLB141-133-NL	3/4" Pack Joint for Copper or Plastic Tubing (CTS)*	3/4" Female Iron Pipe Threads	47.0	619.96
►LYLB144-133-NL	3/4" Pack Joint for Copper or Plastic Tubing (CTS)*	3/4" Pack Joint for Copper or Plastic Tubing (CTS)*	47.0	640.00

STRAIGHT BALL VALVE INLET - STRAIGHT BALL VALVE OUTLET

CATALOG NUMBER	DESCRIPTION		APPROX. WT. LBS.	LIST PRICE
	INLET	OUTLET		
LYLBB111-133-NL	3/4" Female Iron Pipe Threads	3/4" Female Iron Pipe Threads	48.0	\$ 700.88
LYLBB122-133-NL	3/4" Flare Copper	3/4" Flare Copper	48.0	733.05
►LYLBB141-133-NL	3/4" Pack Joint for Copper or Plastic Tubing (CTS)*	3/4" Female Iron Pipe Threads	48.0	723.22
►LYLBB144-133-NL	3/4" Pack Joint for Copper or Plastic Tubing (CTS)*	3/4" Pack Joint for Copper or Plastic Tubing (CTS)*	48.0	741.66

STRAIGHT KEY VALVE INLET - STRAIGHT OUTLET

CATALOG NUMBER	DESCRIPTION		APPROX. WT. LBS.	LIST PRICE
	INLET	OUTLET		
LYLV111-133-NL	3/4" Double Purpose**	3/4" Female Iron Pipe Threads	47.0	\$ 599.29
LYLV122-133-NL	3/4" Flare Copper	3/4" Flare Copper	47.0	609.20
►LYLV141-133-NL	3/4" Pack Joint for Copper or Plastic Tubing (CTS)*	3/4" Female Iron Pipe Threads	47.0	591.41
►LYLV144-133-NL	3/4" Pack Joint for Copper or Plastic Tubing (CTS)*	3/4" Pack Joint for Copper or Plastic Tubing (CTS)*	47.0	613.79

STRAIGHT KEY VALVE INLET - STRAIGHT KEY VALVE OUTLET

CATALOG NUMBER	DESCRIPTION		APPROX. WT. LBS.	LIST PRICE
	INLET	OUTLET		
LYLVV111-133-NL	3/4" Double Purpose**	3/4" Double Purpose**	48.0	\$ 694.59
LYLVV122-133-NL	3/4" Flare Copper	3/4" Flare Copper	48.0	694.59
►LYLVV141-133-NL	3/4" Pack Joint for Copper or Plastic Tubing (CTS)*	3/4" Double Purpose**	48.0	686.55
►LYLVV144-133-NL	3/4" Pack Joint for Copper or Plastic Tubing (CTS)*	3/4" Pack Joint for Copper or Plastic Tubing (CTS)*	48.0	689.31

Note: Ford Pack, Quick and Grip Joint compression connections, when used on copper, are designed for Type K or Type L copper only.

All Ford Long Yokeboxes include an ASSE 1024 approved
cartridge style dual check valve contained completely within the Yokebox.

Ordering Information

Plastic lid option: Insert "P" into the catalog number for locking plastic lid.....no additional charge

Example: YSxxx-xxx-P-NL

Insert "PB" into the catalog number for locking plastic lid with ERT bracket, add to price.....\$ 7.86

Example: LYLVVxxx-xxx-PB-NL

Insert "PLB" into the catalog number for locking plastic lid with large ERT bracket, add to price.....\$ 30.84

Example: LYLVVxxx-xxx-PLB-NL

* **Grip Joint** can be ordered by inserting "-G" into the catalog number. Example: LYLB141-133-G-NL

► Ultra-Tite is available. Insert "-U-NA" into the catalog number (shipped unassembled). Contact factory for pricing and availability.
Example: LYLB141-133-U-NA-NL

** **The double purpose coupling** connects to either 3/4" threaded iron pipe or 3/4" flared copper tubing.

Gaskets are furnished – Flat gaskets for valve and outlet saddles; beveled and flat gaskets for expansion connections.

Ford Long Yokeboxes have a locking iron lid as standard. An optional lockless iron lid can be ordered by inserting "-LL" into the catalog number. Example: LYLVV122-133-LL-NL

A lockable expansion connection is available. See pages 9 and 10.

Plastic Upper Section (7" high) for all LYL Long Yokeboxes. Insert the letter "P" into the catalog number. Example: LYLVP111-133-NL
Deduct 17 lbs from approximate shipping weight and deduct \$ -81.62 from the list price above.

FORD LONG YOKEBOXES FOR 5/8" METERS
Center Line of Meter 8" Below Grade
Angle Inlet - Straight Outlet

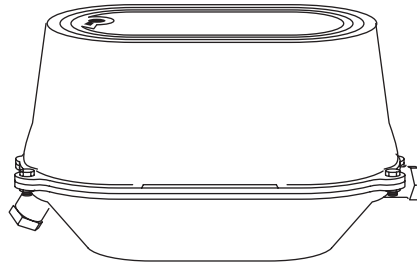

C

ANGLE KEY VALVE INLET - STRAIGHT OUTLET

CATALOG NUMBER	DESCRIPTION		APPROX. WT. LBS.	LIST PRICE
	INLET	OUTLET		
LYLV222-133-NL	3/4" Flare Copper	3/4" Flare Copper	47.0	\$ 588.81
►LYLV241-133-NL	3/4" Pack Joint for Copper or Plastic Tubing (CTS)*	3/4" Female Iron Pipe Threads	47.0	576.60
►LYLV244-133-NL	3/4" Pack Joint for Copper or Plastic Tubing (CTS)*	3/4" Pack Joint for Copper or Plastic Tubing (CTS)*	47.0	598.18

ANGLE KEY VALVE INLET - STRAIGHT KEY VALVE OUTLET

CATALOG NUMBER	DESCRIPTION		APPROX. WT. LBS.	LIST PRICE
	INLET	OUTLET		
LYLVV222-133-NL	3/4" Flare Copper	3/4" Flare Copper	48.0	\$ 681.30
►LYLVV241-133-NL	3/4" Pack Joint for Copper or Plastic Tubing (CTS)*	3/4" Double Purpose**	48.0	671.35
►LYLVV244-133-NL	3/4" Pack Joint for Copper or Plastic Tubing (CTS)*	3/4" Pack Joint for Copper or Plastic Tubing (CTS)*	48.0	688.06

Note: Ford Pack, Quick and Grip Joint compression connections, when used on copper, are designed for Type K or Type L copper only.

All Ford Long Yokeboxes include an ASSE 1024 approved cartridge style dual check valve contained completely within the Yokebox.

Ordering Information

Plastic lid option: Insert "-P" into the catalog number for locking plastic lid.....no additional charge
Example: LYL^Vxxx-xxx-P-NL
Insert "-PB" into the catalog number for locking plastic lid with ERT bracket, add to price.....\$ 7.86
Example: LYL^Vxxx-xxx-PB-NL
Insert "-PLB" into the catalog number for locking plastic lid with large ERT bracket, add to price.....\$ 30.84
Example: LYL^Vxxx-xxx-PLB-NL

* **Grip Joint** can be ordered by inserting "-G" into the catalog number. Example: LYL^V241-133-G-NL

► Ultra-Tite is available. Insert "-U-NA" into the catalog number (shipped unassembled). Contact factory for pricing and availability.
Example: LYL^V241-133-U-NA-NL

** **The double purpose coupling** connects to either 3/4" threaded iron pipe or 3/4" flared copper tubing.

Gaskets are furnished – Flat gaskets for valve and outlet saddles; beveled and flat gaskets for expansion connections.

Ford Long Yokeboxes have a locking iron lid as standard. An optional lockless iron lid can be ordered by inserting "-LL" into the catalog number. Example: LYL^{VV}241-133-LL-NL

A lockable expansion connection is available. See pages 9 and 10.

Plastic Upper Section (7" high) for all LYL Long Yokeboxes. Insert the letter "P" into the catalog number. Example: LYL^P111-133-NL
Deduct 17 lbs from approximate shipping weight and deduct \$ -81.62 from the list price above.

FORD LONG YOKEBOXES FOR 5/8" METERS

Center Line of Meter 8" Below Grade

Angle Inlet - Angle Outlet

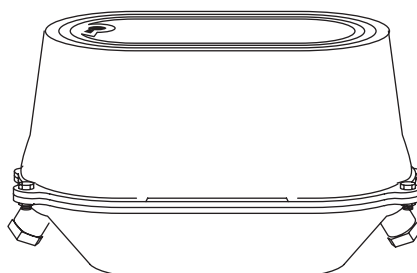

ANGLE KEY VALVE INLET - ANGLE OUTLET

CATALOG NUMBER	DESCRIPTION		APPROX. WT. LBS.	LIST PRICE
	INLET	OUTLET		
LYLV322-133-NL	3/4" Flare Copper	3/4" Flare Copper	47.0	\$ 589.89
►LYLV344-133-NL	3/4" Pack Joint for Copper or Plastic Tubing (CTS)*	3/4" Pack Joint for Copper or Plastic Tubing (CTS)*	47.0	595.47

ANGLE KEY VALVE INLET - ANGLE KEY VALVE OUTLET

CATALOG NUMBER	DESCRIPTION		APPROX. WT. LBS.	LIST PRICE
	INLET	OUTLET		
LYLVV322-133-NL	3/4" Flare Copper	3/4" Flare Copper	48.0	\$ 647.58
►LYLVV344-133-NL	3/4" Pack Joint for Copper or Plastic Tubing (CTS)*	3/4" Pack Joint for Copper or Plastic Tubing (CTS)*	48.0	648.11

Note: Ford Pack, Quick and Grip Joint compression connections, when used on copper, are designed for Type K or Type L copper only.

All Ford Long Yokeboxes include an ASSE 1024 approved
cartridge style dual check valve contained completely within the Yokebox.

Ordering Information

Plastic lid option: Insert "-P" into the catalog number for locking plastic lid.....no additional charge
Example: LYL^Vxxx-xxx-P-NL
Insert "-PB" into the catalog number for locking plastic lid with ERT bracket, add to price..... \$ 7.86
Example: LYL^Vxxx-xxx-PB-NL
Insert "-PLB" into the catalog number for locking plastic lid with large ERT bracket, add to price..... \$ 30.84
Example: LYL^Vxxx-xxx-PLB-NL

* **Grip Joint** can be ordered by inserting "-G" into the catalog number. Example: LYL^V344-133-G-NL

► **Ultra-Tite** is available. Insert "-U-NA" into the catalog number (shipped unassembled). Contact factory for pricing and availability.
Example: LYL^V344-133-U-NA-NL

Gaskets are furnished – Flat gaskets for valve and outlet saddles; beveled and flat gaskets for expansion connections.

Ford Long Yokeboxes have a locking iron lid as standard. An optional lockless iron lid can be ordered by inserting "-LL" into the catalog number.
Example: LYL^VV322-133-LL-NL

A lockable expansion connection is available. See pages 9 and 10.

Plastic Upper Section (7" high) for all LYL Long Yokeboxes. Insert the letter "P" into the catalog number. Example: LYL^VP322-133-NL
Deduct 17 lbs from approximate shipping weight and deduct \$ -81.62 from the list price above.

FORD LONG YOKEBOXES FOR 5/8" x 3/4" METERS
Center Line of Meter 8" Below Grade
Straight Inlet - Straight Outlet

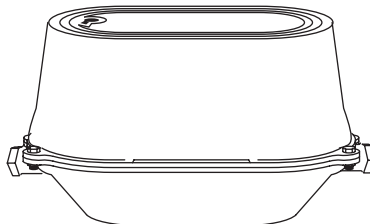

STRAIGHT BALL VALVE INLET - STRAIGHT OUTLET

CATALOG NUMBER	DESCRIPTION		APPROX. WT. LBS.	LIST PRICE
	INLET	OUTLET		
LYLB111-233-NL	3/4" Female Iron Pipe Threads	3/4" Female Iron Pipe Threads	46.2	\$ 604.86
LYLB122-233-NL	3/4" Flare Copper	3/4" Flare Copper	47.0	630.90
► LYLB141-233-NL	3/4" Pack Joint for Copper or Plastic Tubing (CTS)*	3/4" Female Iron Pipe Threads	46.6	627.22
► LYLB144-233-NL	3/4" Pack Joint for Copper or Plastic Tubing (CTS)*	3/4" Pack Joint for Copper or Plastic Tubing (CTS)*	46.8	644.01
LYLB171-233-NL	3/4" Pack Joint for PVC/IPS PE	3/4" Female Iron Pipe Threads	47.0	673.73

STRAIGHT BALL VALVE INLET - STRAIGHT BALL VALVE OUTLET

CATALOG NUMBER	DESCRIPTION		APPROX. WT. LBS.	LIST PRICE
	INLET	OUTLET		
LYLBB111-233-NL	3/4" Female Iron Pipe Threads	3/4" Female Iron Pipe Threads	48.0	\$ 704.81
LYLBB122-233-NL	3/4" Flare Copper	3/4" Flare Copper	48.0	727.06
► LYLBB141-233-NL	3/4" Pack Joint for Copper or Plastic Tubing (CTS)*	3/4" Female Iron Pipe Threads	48.0	727.20
► LYLBB144-233-NL	3/4" Pack Joint for Copper or Plastic Tubing (CTS)*	3/4" Pack Joint for Copper or Plastic Tubing (CTS)*	47.3	745.68
LYLBB171-233-NL	3/4" Pack Joint for PVC/IPS PE	3/4" Female Iron Pipe Threads	48.0	756.95
LYLBB177-233-NL	3/4" Pack Joint for PVC/IPS PE	3/4" Pack Joint for PVC/IPS PE	47.7	805.09

STRAIGHT KEY VALVE INLET - STRAIGHT OUTLET

CATALOG NUMBER	DESCRIPTION		APPROX. WT. LBS.	LIST PRICE
	INLET	OUTLET		
LYLV111-233-NL	3/4" Double Purpose**	3/4" Female Iron Pipe Threads	47.0	\$ 603.30
LYLV122-233-NL	3/4" Flare Copper	3/4" Flare Copper	47.0	613.22
► LYL141-233-NL	3/4" Pack Joint for Copper or Plastic Tubing (CTS)*	3/4" Female Iron Pipe Threads	47.0	595.41
► LYL141-243-NL	1" Pack Joint for Copper or Plastic Tubing (CTS)*	3/4" Female Iron Pipe Threads	48.7	624.96
► LYL144-233-NL	3/4" Pack Joint for Copper or Plastic Tubing (CTS)*	3/4" Pack Joint for Copper or Plastic Tubing (CTS)*	47.0	617.76
► LYL161-233-NL	3/4" Pack Joint for PE Pipe*	3/4" Female Iron Pipe Threads	47.0	614.46
LYLV171-233-NL	3/4" Pack Joint for PVC/IPS PE Pipe	3/4" Female Iron Pipe Threads	47.0	614.46

STRAIGHT KEY VALVE INLET - STRAIGHT KEY VALVE OUTLET

CATALOG NUMBER	DESCRIPTION		APPROX. WT. LBS.	LIST PRICE
	INLET	OUTLET		
LYLVV111-233-NL	3/4" Double Purpose**	3/4" Double Purpose**	48.0	\$ 698.66
LYLVV122-233-NL	3/4" Flare Copper	3/4" Flare Copper	48.0	698.66
► LYL141-233-NL	3/4" Pack Joint for Copper or Plastic Tubing (CTS)*	3/4" Double Purpose**	48.0	690.49
► LYL144-233-NL	3/4" Pack Joint for Copper or Plastic Tubing (CTS)*	3/4" Pack Joint for Copper or Plastic Tubing (CTS)*	48.0	693.28

Note: Ford Pack, Quick and Grip Joint compression connections, when used on copper, are designed for Type K or Type L copper only.

All Ford Long Yokeboxes include an ASSE 1024 approved cartridge style dual check valve contained completely within the Yokebox.

Ordering Information

Plastic lid option: Insert "-P" into the catalog number for locking plastic lid.....no additional charge
Example: LYLBxxx-xxx-P-NL
Insert "-PB" into the catalog number for locking plastic lid with ERT bracket, add to price.....\$ 7.86
Example: LYLBxxx-xxx-PB-NL
Insert "-PLB" into the catalog number for locking plastic lid with large ERT bracket, add to price.....\$ 30.84
Example: LYLBxxx-xxx-PLB-NL

* **Grip Joint** can be ordered by inserting "-G" into the catalog number. Example: LYLB141-233-G-NL

► Ultra-Tite is available. Insert "-U-NA" into the catalog number (shipped unassembled). Contact factory for pricing and availability.
Example: LYLB141-233-U-NA-NL

** **The double purpose coupling** connects to either 3/4" threaded iron pipe or 3/4" flared copper tubing.

Gaskets are furnished – Flat gaskets for valve and outlet saddles; beveled and flat gaskets for expansion connections.

Ford Long Yokeboxes have a locking iron lid as standard. An optional lockless iron lid can be ordered by inserting "-LL" into the catalog number.
Example: LYL122-233-LL-NL

A lockable expansion connection is available. See pages 9 and 10.

Plastic Upper Section (7" high) for all LYL Long Yokeboxes. Insert the letter "P" into the catalog number. Example: LYL111-233-NL
Deduct 17 lbs from approximate shipping weight and deduct \$ -81.62 from the list price above.

FORD LONG YOKEBOXES FOR 5/8" X 3/4" METERS

Center Line of Meter 8" Below Grade

Angle Inlet - Straight Outlet

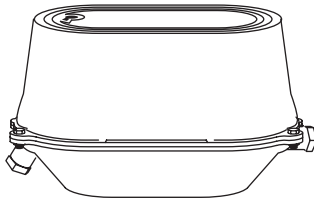

ANGLE BALL VALVE INLET - STRAIGHT OUTLET

CATALOG NUMBER	DESCRIPTION		APPROX. WT. LBS.	LIST PRICE
	INLET	OUTLET		
LYLB222-233-NL	3/4" Flare Copper	3/4" Flare Copper	47.0	\$ 676.35
► LYLB241-233-NL	3/4" Pack Joint for Copper or Plastic Tubing (CTS)*	3/4" Female Iron Pipe Threads	47.0	672.68
LYLB241-243-NL	1" Pack Joint for Copper or Plastic Tubing (CTS)*	3/4" Female Iron Pipe Threads	47.0	698.93
► LYLB244-233-NL	3/4" Pack Joint for Copper or Plastic Tubing (CTS)*	3/4" Pack Joint for Copper or Plastic Tubing (CTS)*	47.0	691.06
► LYLB261-233-NL	3/4" Pack Joint for PE Pipe*	3/4" Female Iron Pipe Threads	46.9	684.40
► LYLB266-233-NL	3/4" Pack Joint for PE Pipe*	3/4" Pack Joint for PE Pipe*	47.0	711.72

ANGLE BALL VALVE INLET - STRAIGHT BALL VALVE OUTLET

CATALOG NUMBER	DESCRIPTION		APPROX. WT. LBS.	LIST PRICE
	INLET	OUTLET		
LYLBB222-233-NL	3/4" Flare Copper	3/4" Flare Copper	48.0	\$ 808.95
► LYLBB241-233-NL	3/4" Pack Joint for Copper or Plastic Tubing (CTS)*	3/4" Female Iron Pipe Threads	48.0	797.53
LYLBB241-243-NL	1" Pack Joint for Copper or Plastic Tubing (CTS)*	3/4" Female Iron Pipe Threads	48.0	823.81
► LYLBB244-233-NL	3/4" Pack Joint for Copper or Plastic Tubing (CTS)*	3/4" Pack Joint for Copper or Plastic Tubing (CTS)*	48.0	816.04
► LYLBB261-233-NL	3/4" Pack Joint for PE Pipe*	3/4" Female Iron Pipe Threads	48.0	809.35

ANGLE KEY VALVE INLET - STRAIGHT OUTLET

CATALOG NUMBER	DESCRIPTION		APPROX. WT. LBS.	LIST PRICE
	INLET	OUTLET		
LYLV221-233-NL	3/4" Flare Copper	3/4" Female Iron Pipe Threads	47.0	\$ 582.95
LYLV222-233-NL	3/4" Flare Copper	3/4" Flare Copper	47.0	592.82
► LYL241-233-NL	3/4" Pack Joint for Copper or Plastic Tubing (CTS)*	3/4" Female Iron Pipe Threads	47.0	585.25
LYLV241-243-NL	1" Pack Joint for Copper or Plastic Tubing (CTS)*	3/4" Female Iron Pipe Threads	47.0	616.72
► LYL244-233-NL	3/4" Pack Joint for Copper or Plastic Tubing (CTS)*	3/4" Pack Joint for Copper or Plastic Tubing (CTS)*	47.0	602.10
► LYL261-233-NL	3/4" Pack Joint for PE Pipe*	3/4" Female Iron Pipe Threads	48.4	598.59
LYLV261-243-NL	1" Pack Joint for PE Pipe*	3/4" Female Iron Pipe Threads	47.0	646.73

ANGLE KEY VALVE INLET - STRAIGHT KEY VALVE OUTLET

CATALOG NUMBER	DESCRIPTION		APPROX. WT. LBS.	LIST PRICE
	INLET	OUTLET		
LYLVV221-233-NL	3/4" Flare Copper	3/4" Double Purpose**	47.0	\$ 674.76
LYLVV222-233-NL	3/4" Flare Copper	3/4" Flare Copper	48.0	685.23
► LYL241-233-NL	3/4" Pack Joint for Copper or Plastic Tubing (CTS)*	3/4" Double Purpose**	48.0	675.39
► LYL244-233-NL	3/4" Pack Joint for Copper or Plastic Tubing (CTS)*	3/4" Pack Joint for Copper or Plastic Tubing (CTS)*	48.0	692.13
► LYL261-233-NL	3/4" Pack Joint for PE Pipe*	3/4" Double Purpose**	48.0	693.36
LYLVV261-243-NL	1" Pack Joint for PE Pipe*	3/4" Double Purpose**	48.0	789.65

Note: Ford Pack, Quick and Grip Joint compression connections, when used on copper, are designed for Type K or Type L copper only.

All Ford Long Yokeboxes include an ASSE 1024 approved cartridge style dual check valve contained completely within the Yokebox.

Ordering Information

Plastic lid option: Insert "-P" into the catalog number for locking plastic lid Example: LYLBxxx-xxx-P-NL..... **no additional charge**
 Insert "-PB" into the catalog number for locking plastic lid with ERT bracket, add to price..... **\$ 7.86**
 Example: LYLBxxx-xxx-PB-NL
 Insert "-PLB" into the catalog number for locking plastic lid with large ERT bracket, add to price..... **\$ 30.84**
 Example: LYLBxxx-xxx-PLB-NL

* **Grip Joint** can be ordered by inserting "-G" into the catalog number. Example: LYLB241-233-G-NL

► **Ultra-Tite** is available. Insert "-U-NA" into the catalog number (shipped unassembled). Contact factory for pricing and availability.
 Example: LYL241-233-U-NA-NL

** **The double purpose coupling** connects to either 3/4" threaded iron pipe or 3/4" flared copper tubing.

Gaskets are furnished – Flat gaskets for valve and outlet saddles; beveled and flat gaskets for expansion connections.

Ford Long Yokeboxes have a locking iron lid as standard. An optional lockless iron lid can be ordered by inserting "-LL" into the catalog number.
 Example: LYL241-233-LL-NL

A lockable expansion connection is available. See pages 9 and 10.

Plastic Upper Section (7" high) for all LYL Long Yokeboxes. Insert the letter "P" into the catalog number. Example: LYL241-233-P-NL

Deduct 17 lbs from approximate shipping weight and deduct **\$ -81.62** from the list price above.

FORD LONG YOKEBOXES FOR 5/8" X 3/4" METERS

Center Line of Meter 8" Below Grade

Angle Inlet - Angle Outlet

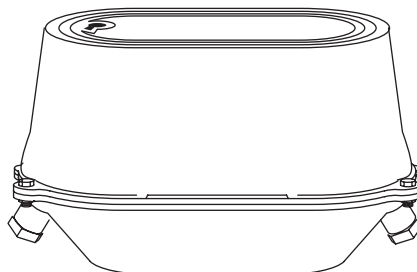

ANGLE BALL VALVE INLET - ANGLE BALL VALVE OUTLET

C

CATALOG NUMBER	DESCRIPTION		APPROX. WT. LBS.	LIST PRICE
	INLET	OUTLET		
LYLBB322-233-NL	3/4" Flare Copper	3/4" Flare Copper	48.0	\$ 811.51
► LYLBB344-233-NL	3/4" Pack Joint for Copper or Plastic Tubing (CTS)*	3/4" Pack Joint for Copper or Plastic Tubing (CTS)*	48.0	812.21
LYLBB344-243-NL	1" Pack Joint for Copper or Plastic Tubing (CTS)*	3/4" Pack Joint for Copper or Plastic Tubing (CTS)*	48.0	838.44
► LYLBB344-244-NL	1" Pack Joint for Copper or Plastic Tubing (CTS)*	1" Pack Joint for Copper or Plastic Tubing (CTS)*	48.0	864.65
► LYLBB366-233-NL	3/4" Pack Joint for PE Pipe*	3/4" Pack Joint for PE Pipe*	48.0	835.71

ANGLE KEY VALVE INLET - ANGLE OUTLET

CATALOG NUMBER	DESCRIPTION		APPROX. WT. LBS.	LIST PRICE
	INLET	OUTLET		
LYLV322-233-NL	3/4" Flare Copper	3/4" Flare Copper	47.0	\$ 593.88
► LYL344-233-NL	3/4" Pack Joint for Copper or Plastic Tubing (CTS)*	3/4" Pack Joint for Copper or Plastic Tubing (CTS)*	48.4	599.45
LYLV344-243-NL	1" Pack Joint for Copper or Plastic Tubing (CTS)*	3/4" Pack Joint for Copper or Plastic Tubing (CTS)*	48.0	613.99

ANGLE KEY VALVE INLET - ANGLE KEY VALVE OUTLET

CATALOG NUMBER	DESCRIPTION		APPROX. WT. LBS.	LIST PRICE
	INLET	OUTLET		
LYLVV322-233-NL	3/4" Flare Copper	3/4" Flare Copper	48.0	\$ 651.45
► LYL344-233-NL	3/4" Pack Joint for Copper or Plastic Tubing (CTS)*	3/4" Pack Joint for Copper or Plastic Tubing (CTS)*	48.0	652.20
► LYL366-233-NL	3/4" Pack Joint for PE Pipe*	3/4" Pack Joint for PE Pipe*	48.0	681.12

Note: Ford Pack, Quick and Grip Joint compression connections, when used on copper, are designed for Type K or Type L copper only.

All Ford Long Yokeboxes include an ASSE 1024 approved
cartridge style dual check valve contained completely within the Yokebox.

Ordering Information

Plastic lid option: Insert "-P" into the catalog number for locking plastic lid.....no additional charge
Example: LYLBBxxx-xxx-P-NL
Insert "-PB" into the catalog number for locking plastic lid with ERT bracket, add to price..... \$ 7.86
Example: LYLBBxxx-xxx-PB-NL
Insert "-PLB" into the catalog number for locking plastic lid with large ERT bracket, add to price..... \$ 30.84
Example: LYLBBxxx-xxx-PLB-NL

* **Grip Joint** can be ordered by inserting "-G" into the catalog number. Example: LYLBB344-233-G-NL

► Ultra-Tite is available. Insert "-U-NA" into the catalog number (shipped unassembled). Contact factory for pricing and availability.
Example: LYLBB344-233-U-NA-NL

** **The double purpose coupling** connects to either 3/4" threaded iron pipe or 3/4" flared copper tubing.

Gaskets are furnished – Flat gaskets for valve and outlet saddles; beveled and flat gaskets for expansion connections.

Ford Long Yokeboxes have a locking iron lid as standard. An optional lockless iron lid can be ordered by inserting "-LL" into the catalog number.
Example: LYL322-233-LL-NL

A lockable expansion connection is available. See pages 9 and 10.

Plastic Upper Section (7" high) for all LYL Long Yokeboxes. Insert the letter "P" into the catalog number. Example: LYLVP322-233-NL
Deduct 17 lbs from approximate shipping weight and deduct \$ -81.62 from the list price above.

FORD LONG YOKEBOXES FOR 3/4" METERS
Center Line of Meter 8" Below Grade
Angle Inlet - Straight Outlet

All Ford Long Yokeboxes for 3/4" meters have an angle inlet key valve.

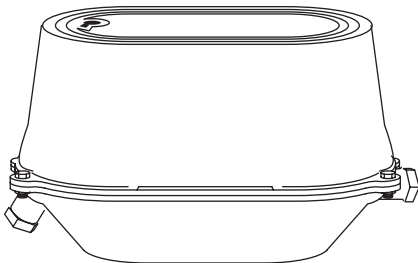

CATALOG NUMBER	DESCRIPTION		APPROX. WT. LBS.	LIST PRICE
	ANGLE VALVE INLET	STRAIGHT OUTLET		
LYLV221-344-NL	1" Flare Copper	1" Female Iron Pipe Threads	47.0	\$ 673.03
► LYL224-344-NL	1" Flare Copper	1" Pack Joint for Copper or Plastic Tubing (CTS)*	47.0	688.17
► LYL241-344-NL	1" Pack Joint for Copper or Plastic Tubing (CTS)*	1" Female Iron Pipe Threads	47.0	680.11
► LYL244-344-NL	1" Pack Joint for Copper or Plastic Tubing (CTS)*	1" Pack Joint for Copper or Plastic Tubing (CTS)*	47.0	693.36

Note: Ford Pack, Quick and Grip Joint compression connections, when used on copper, are designed for Type K or Type L copper only.

All Ford Long Yokeboxes include an ASSE 1024 approved cartridge style dual check valve contained completely within the Yokebox.

All parts, options and accessories for 5/8", 5/8" x 3/4" and 3/4" Long Yokeboxes are listed on pages C-9, C-10 and C-11.

Ordering Information

Plastic lid option: Insert "-P" into the catalog number for locking plastic lid.....no additional charge
Example: LYLxxx-xxx-P-NL
Insert "-PB" into the catalog number for locking plastic lid with ERT bracket, add to price.....\$ 7.86
Example: LYLxxx-xxx-PB-NL
Insert "-PLB" into the catalog number for locking plastic lid with large ERT bracket, add to price.....\$ 30.84
Example: LYLxxx-xxx-PLB-NL

- * **Grip Joint** can be ordered by inserting "-G" into the catalog number. Example: LYL241-344-G-NL
 - Ultra-Tite is available. Insert "-U-NA" into the catalog number (shipped unassembled). Contact factory for pricing and availability.
Example: LYL224-344-U-NA-NL
 - ** **The double purpose coupling** connects to either 3/4" threaded iron pipe or 3/4" flared copper tubing.
- Gaskets** are furnished – Flat gaskets for valve and outlet saddles; beveled and flat gaskets for expansion connections.
- Ford Long Yokeboxes have a locking iron lid as standard. An optional lockless iron lid can be ordered by inserting "-LL" into the catalog number.
Example: LYL244-344-LL-NL
- A lockable expansion connection is available. See page 10.
- Plastic Upper Section** (7" high) for all LYL Long Yokeboxes. Insert the letter "P" into the catalog number. Example: LYLVP224-344-NL
Deduct 17 lbs from approximate shipping weight and deduct \$ -81.62 from the list price above.

FORD LONG YOKEBOX OPTIONS AND ACCESSORIES

for 5/8", 5/8" x 3/4" Long Yokeboxes

OPTIONS AND ACCESSORIES FOR LONG YOKEBOXES

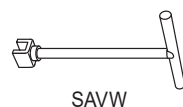

SAVV



MBVW



9503

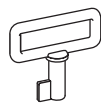

MBLK



MBUK



YEW-3

CATALOG NUMBER	DESCRIPTION	LIST PRICE
LYGA	Grade Adjuster for Long Yokebox	\$ 145.65
LYPR-4	4" Plastic Riser for Long Yokebox	49.86
LYIR-2	2" Iron Riser for Long Yokebox with Mounting Hardware	72.40
LYIR-4	4" Iron Riser for Long Yokebox with Mounting Hardware	153.49
LYIR-6	6" Iron Riser for Long Yokebox with Mounting Hardware	185.17
TP	Removable Cast Iron Plug (with cotter pin) for Electronic Meter Reading Module Hole	9.97
SAVV	Ball Valve Yokebox Wrench	20.98
MBVW	Yokebox Key Valve Wrench (18" long)	73.33
9503	Padlock Plate for Key Valve, Angle or Straight	4.72
FLYB-AVLP	Padlock Plate for Angle Ball Valve for Long Yokebox	12.10
FLYB-BVLP	Padlock Plate for Straight Ball Valve for Long Yokebox	12.10
FLYB-BVLP-R	Padlock Plate for Ball Valve Long Yokebox with Plastic Riser	16.01
FYBKVLP-AV-SV	Padlock Plate for Straight or Angle Key Valve with or without Plastic Riser	16.01
MBLK	Yokebox Lid Key	20.33
MBUK	Meter Box Universal Key for Locking Lids, Lockless Lids and Yokebox Valves	60.97
PTP	Removable Plastic Plug / Nut for Electronic Meter Reading Lid Hole	11.58
PTP-BR	Removable Plastic Plug for Electronic Meter Reading Lid Hole with ERT Bracket	16.12
PBR-YL-LYL	Plastic ERT Bracket with (3) Stainless Steel Clips (field installation only on plastic lid)	9.68
PLBR-YL-LYL	Plastic Large ERT Bracket w/ (3) Stainless Steel Clips (field installation only on plastic lid)	32.64
9505	Combination Yokebox / Dallas Lid Key	80.13
YEW-1	5/8" Expansion Connection Wrench	20.58
YEW-3	5/8" x 3/4" Expansion Connection Wrench	22.67
9508	Combination Yokebox - Pentagon Bolt Key	102.84
Insert "P" into Catalog Number	Plastic Shallow Type (YL) Upper Section (7" high) Example: LYLB222-233-NL	Deduct from Price -81.62
Insert "-PB" into Catalog Number	Plastic Locking Lid with ERT Bracket Example: LYLB222-233-PB-NL	7.86
Insert "-PLB" into Catalog Number	Plastic Locking Lid with Large ERT Bracket Example: LYLB222-233-PLB-NL	30.84
Insert "-PTP" into Catalog Number	Removable Plastic Plug / Nut for Electronic Meter Reading Lid Hole Example: LYLB222-233-PTP-NL	16.90
Insert "-PTP-BR" into Catalog Number	Removable Plastic Plug for Electronic Meter Reading Lid Hole with ERT Bracket Example: LYLB222-233-PTP-BR-NL	21.45
Insert "-T" into Catalog Number	Electronic Meter Read Feature on Lid (2" hole) Example: LYLB222-233-T-NL	Add to Price 5.31
Insert "-TP" into Catalog Number	Electronic Meter Read Feature on Lid (2" hole), with Removable Iron Plug Example: LYLB222-233-TP-NL	Add to Price 15.30
Insert "-G" into Catalog Number	Grip Joint for CTS Example: LYLB244-233-G-NL	Add to Price 0.00
Insert "-SP" into Catalog Number	Spacer in Lieu of Dual Check Valve Example: LYLB244-233-SP-NL	Deduct from Price -88.19
Insert "-LL" into Catalog Number	Lockless Lid on Long Yokebox Example: LYLVV122-233-LL-NL	No Charge 0.00
Insert "P4" into Catalog Number	4" Polystyrene Riser Attached Between Base and Upper Section Example: LYLB244-233-P4-NL	49.86

INSERT INTO THE CATALOG NUMBER	DESCRIPTION	5/8" METER SIZE ADD TO PRICE	5/8" x 3/4" METER SIZE ADD TO PRICE
Insert "-XA" into Catalog Number	Locking Expansion Connection without Ford Security Screw Example: LYLB244-233-XA-NL	\$ 39.03	\$ 44.31
Insert "-XB" into Catalog Number	Locking Expansion Connection with Ford Security Screw Example: LYLB244-233-XB-NL	45.54	50.82

CHECK VALVES, UPPER SECTIONS, LIDS AND GASKETS FOR LONG YOKEBOXES

CATALOG NUMBER	DESCRIPTION	LIST PRICE
LYL	Iron Locking Lid for Long Yokebox	\$ 48.70
LYLL	Iron Lockless Lid for Long Yokebox	48.70
LYL-T	Iron Locking Electronic Read Lid with 2" Hole (for Long Yokebox)	54.03
LYLP	Plastic Long Yokebox Lid	48.70
LYLP-BR	Plastic Long Yokebox Lid with ERT Bracket	56.57
LYLP-LBR	Plastic Long Yokebox Lid with Large ERT Bracket	79.55
LYIB	Shallow Type (LYL) Upper Casting (7" high) (for Long Yokebox)	167.85
LYPB	Shallow Plastic Type (LYL) Upper Section (7" high) (for Long Yokebox)	86.26
GT-112	5/8" Rubber Gaskets for Valve and Outlet Saddles	0.49
GT-118	5/8" x 3/4" Rubber Gaskets for Valve and Outlet Saddles	0.65
9500	(Each) Stainless Steel Bolt and Nut for Connecting Upper and Base Castings (4 required)	1.34
9510	Lock Assembly (bolt, spring and rivet)	10.57
HHCI33-311-NL	Cartridge Style Dual Check Valve for Long Yokebox, for 5/8" Meter	141.10
HHCI33-322-3-5-PE-NL	Cartridge Style Dual Check Valve for Double Valve Type Long Yokebox, for 5/8" x 3/4" Meter, Plain End Outlet	141.10
HHCI33-322-NL	Cartridge Style Dual Check Valve for Single Valve Type Long Yokebox, for 5/8" x 3/4" Meter	141.10

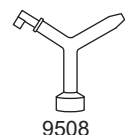

9508

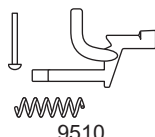

9510

C

EXPANSION CONNECTION OPTIONS

for 5/8" and 5/8" x 3/4" Long Yokeboxes

CATALOG NUMBER	DESCRIPTION	LIST PRICE
EC-1-NL	Expansion Connection for 5/8" Meter	\$ 42.33
ECL-1-NL	Locking Expansion Connection for 5/8" Meter without Security Screw	81.36
ECL-1-SSF-NL	Locking Expansion Connection for 5/8" Meter with Security Screw	87.87
EC-23-NL	Expansion Connection for 5/8" x 3/4" Meter	47.96
ECL-23-NL	Locking Expansion Connection for 5/8" x 3/4" Meter without Security Screw	92.26
ECL-23-SSF-NL	Locking Expansion Connection for 5/8" x 3/4" Meter with Security Screw	98.79
GT-32	5/8" Beveled Expansion Connection Gasket	1.37
GT-33	5/8" x 3/4" Beveled Expansion Connection Gasket	1.67
GT-210	5/8" Flat Expansion Connection Gasket	1.23
GT-196	5/8" x 3/4" Flat Expansion Connection Gasket	1.58
BOLT-800998-SSF	Security Screw (fits all locking expansions)	7.26
KEY-800999-SSF	Security Key / Tip Only for Locking Expansion Connection	83.34
NUT-DR-040072-SSF	Magnetic Nut Driver Less Key / Tip	43.58

FORD KEY VALVE LONG YOKEBOX PARTS

for 5/8" and 5/8" x 3/4" Long Yokeboxes

VALVES, OUTLETS AND BASE FOR KEY VALVE TYPE LONG YOKEBOX for 5/8" and 5/8" x 3/4" METER

CATALOG NUMBER	DESCRIPTION	LIST PRICE
LYBC-KV	Base (or bottom) Casting for Key Valve Long Yokebox	\$ 116.12
YBAO23-31-NL	Angle Outlet for 5/8" Meter with 3/4" Flare Copper Connection	49.56
YBAO23-32-NL	Angle Outlet for 5/8" x 3/4" Meter with 3/4" Flare Copper Connection	49.56
► YBAO43-32-NL	Angle Outlet for 5/8" x 3/4" Meter with Pack Joint for 3/4" Copper or Plastic Tube (CTS)*	58.81
YBAV23-31-NL	Angle Valve for 5/8" Meter, Inlet for 3/4" Flare Copper	109.38
► YBAV43-31-NL	Angle Valve for 5/8" Meter, Inlet Pack Joint for 3/4" Copper or Plastic Tube (CTS)*	112.89
YBAV43-42-NL	Angle Valve for 5/8" x 3/4" Meter, Inlet Pack Joint for 1" Copper or Plastic Tube (CTS)*	132.61
YBAV23-32-NL	Angle Valve for 5/8" x 3/4" Meter, Inlet for 3/4" Flare Copper	109.38
► YBAV43-32-NL	Angle Valve for 5/8" x 3/4" Meter, Inlet Pack Joint for 3/4" Copper or Plastic Tube (CTS)*	112.89
► YBAV63-32-NL	Angle Valve for 5/8" x 3/4" Meter, Inlet Pack Joint for 3/4" PE Pipe*	132.61
YBAV63-42-NL	Angle Valve for 5/8" x 3/4" Meter, Inlet Pack Joint for 1" PE Pipe*	189.60
YBSV23-11-NL	Straight Valve for 5/8" Meter, Inlet for 1/2" Flare Copper	121.02
YBSV43-11-NL	Straight Valve for 5/8" Meter Inlet Pack Joint for 1/2" Copper or Plastic Tube (CTS)	123.17
YBSV13-31-NL	Straight Valve for 5/8" Meter, 3/4" Double Purpose Coupling Inlet	132.99
► YBSV43-31-NL	Straight Valve for 5/8" Meter, Inlet Pack Joint for 3/4" Copper or Plastic Tube (CTS)*	136.70
YBSV13-32-NL	Straight Valve for 5/8" x 3/4" Meter, 3/4" Double Purpose Coupling	132.99
YBSV23-32-NL	Straight Valve for 5/8" x 3/4" Meter, Inlet for 3/4" Flare Copper	132.71
► YBSV43-32-NL	Straight Valve for 5/8" x 3/4" Meter, Inlet Pack Joint for 3/4" Copper or Plastic Tube (CTS)*	136.70
YBSV43-42-NL	Straight Valve for 5/8" x 3/4" Meter, Inlet Pack Joint for 1" Copper or Plastic Tube (CTS)*	162.08
► YBSV63-32-NL	Straight Valve for 5/8" x 3/4" Meter, Inlet Pack Joint for 3/4" PE Pipe*	162.08
YBSV73-32-NL	Straight Valve for 5/8" x 3/4" Meter, Inlet Pack Joint for 3/4" PVC Pipe	162.08
YBSV83-32-NL	Straight Valve for 5/8" x 3/4" Meter, Inlet for 3/4" Male Iron Pipe Threads	132.71
YBSO13-31-NL	Straight Outlet for 5/8" Meter with 3/4" Female Iron Pipe Threads	34.96
YBSO83-31-NL	Straight Outlet for 5/8" Meter with 3/4" Male Iron Pipe Threads	38.20
► YBSO43-31-NL	Straight Outlet for 5/8" Meter with Pack Joint for 3/4" Copper or Plastic Tube (CTS)*	57.59
YBSO23-11-NL	Straight Outlet for 5/8" Meter with 1/2" Flare Copper Connection	43.35
YBSO43-11-NL	Straight Outlet for 5/8" Meter with Pack Joint for 1/2" Copper or Plastic Tube (CTS)	45.52
YBSO23-31-NL	Straight Outlet for 5/8" Meter with 3/4" Flare Copper Connection	48.36
YBSO13-32-NL	Straight Outlet for 5/8" x 3/4" Meter with 3/4" Female Iron Pipe Threads	34.96
YBSO23-32-NL	Straight Outlet for 5/8" x 3/4" Meter with 3/4" Flare Copper Connection	48.36
YBSO83-32-NL	Straight Outlet for 5/8" x 3/4" Meter with 3/4" Male Iron Pipe Threads	38.20
► YBSO43-32-NL	Straight Outlet for 5/8" x 3/4" Meter with Pack Joint for 3/4" Copper or Plastic Tube (CTS)*	57.59
YBSO43-42-NL	Straight Outlet for 5/8" x 3/4" Meter with Pack Joint for 1" Copper or Plastic Tube (CTS)*	72.01
YBSO73-32-NL	Straight Outlet for 5/8" x 3/4" Meter with Pack Joint for 3/4" PVC/IPS PE	72.01
► YBSO63-32-NL	Straight Outlet for 5/8" x 3/4" Meter with Pack Joint for 3/4" PE Pipe*	72.01

NOTE: Ford Pack Joints for PVC are recommended for Schedule 40 and Schedule 80 pipe and IPS PE DR9 and DR11.

NOTE: Ford Pack, Quick and Grip Joint compression connections, when used on copper, are designed for Type K or Type L copper only.

* **Grip Joint** can be ordered by inserting "-G" into the catalog number. Example: YBAO43-32-G-NL

► Ultra-Tite is available. Insert "-U-NA" into the catalog number (shipped unassembled). Contact factory for pricing and availability.
Example: YBAO43-32-U-NA-NL

NOTE: Installation screws are included with Yokebox valves and outlet pieces.

FORD BALL VALVE LONG YOKEBOX PARTS

for 5/8" and 5/8" x 3/4" Long Yokeboxes

VALVES, OUTLETS AND BASE FOR BALL VALVE TYPE LONG YOKEBOXES FOR 5/8" AND 5/8" X 3/4" METER

CATALOG NUMBER	DESCRIPTION	LIST PRICE
LYBC-BV	Base (or Bottom) Casting for Ball Valve Long Yokebox	\$ 116.12
LYABV23-232-NL	5/8" x 3/4" Angle Ball Valve for Long Yokebox, 3/4" Flare Copper	217.80
◆ LYABV43-232-NL	5/8" x 3/4" Angle Ball Valve for Long Yokebox, 3/4" CTS *	221.32
LYABV43-242-NL	5/8" x 3/4" Angle Ball Valve for Long Yokebox, 1" CTS *	256.87
► LYABV63-232-NL	5/8" x 3/4" Angle Ball Valve for Long Yokebox, 3/4" PE Pipe *	237.30
LYSOB31-13-NL	Straight Outlet for 5/8" Meter Ball Valve Long Yokebox, 3/4" FIP	44.79
LYSOB31-23-NL	Straight Outlet for 5/8" x 3/4" Meter Ball Valve Long Yokebox, 3/4" FIP	44.79
LYSOB32-13-NL	Straight Outlet for 5/8" Meter Ball Valve Long Yokebox, 3/4" Flare Copper	53.23
LYSOB32-23-NL	Straight Outlet for 5/8" x 3/4" Meter Ball Valve Long Yokebox, 3/4" Flare Copper	53.23
► LYSOB34-23-NL	Straight Outlet for 5/8" x 3/4" Meter Ball Valve Long Yokebox, 3/4" CTS *	69.79
► LYSOB36-23-NL	Straight Outlet for 5/8" x 3/4" Meter Ball Valve Long Yokebox, 3/4" PE Pipe *	82.46
YBBVL13-231-NL	Straight 5/8" YB Ball Valve for 3/4" Female Iron Pipe	170.45
YBBV13-232-NL	Straight 5/8" x 3/4" YB Ball Valve for 3/4" Female Iron Pipe	170.45
YBBV13-242-NL	Straight 5/8" x 3/4" YB Ball Valve for 1" Female Iron Pipe	188.36
YBBVL23-231-NL	Straight 5/8" YB Ball Valve for 3/4" Flare Copper	192.34
YBBV23-232-NL	Straight 5/8" x 3/4" YB Ball Valve for 3/4" Flare Copper	192.34
► YBBVL43-231-NL	Straight 5/8" YB Ball Valve for 3/4" CTS *	195.52
◆ YBBV43-232-NL	Straight 5/8" x 3/4" YB Ball Valve for 3/4" CTS *	195.52
YBBV43-242-NL	Straight 5/8" x 3/4" YB Ball Valve for 1" CTS *	230.70
YBBV63-232-NL	Straight 5/8" x 3/4" YB Ball Valve for 3/4" PE Pipe*	230.70
YBBV73-232-NL	Straight 5/8" x 3/4" YB Ball Valve for 3/4" PVC/IPS PE	230.70

* **Grip Joint** can be ordered by inserting "-G" into the catalog number. Example: LYABV43-232-G-NL

◆ **Quick Joint** is available. Insert "-Q" into the catalog number. Example: YBBV43-232-Q-NL

► **Ultra-Tite** is available. Insert "-U-NA" into the catalog number (shipped unassembled). Contact factory for pricing and availability. Example: LYABV43-232-U-NA-NL

NOTE: Installation screws are included with Yokebox valves and outlet pieces.

NOTE: Ford Pack, Quick and Grip Joint compression connections, when used on copper, are designed for Type K or Type L copper only.

FORD KEY VALVE LONG YOKEBOX PARTS

for 3/4" Long Yokeboxes

VALVES, OUTLETS AND BASE FOR KEY VALVE TYPE LONG YOKEBOXES, FOR 3/4" METER

CATALOG NUMBER	DESCRIPTION	LIST PRICE
LYBC-KV3	Base (or bottom) Casting for 3/4" Key Valve Long Yokebox	\$ 169.18
EC-23-SF-NL	2-Part Expansion Connection for 3/4" Meter	61.42
HHCI33-322-NL	Cartridge Style Dual Check Valve for Single Valve Type 3/4" Meter Long Yokebox	141.10
GGAV23-343-NL	Angle Valve for 3/4" Meter, Inlet for 1" Flare Copper	134.78
► GGAV43-343-NL	Angle Valve for 3/4" Meter, Inlet Pack Joint for 1" Copper or Plastic Tube (CTS)*	141.70
GGO13-343-NL	Straight Outlet for 3/4" Meter with 1" Female Iron Pipe Threads	55.77
► GGO43-343-NL	Straight Outlet for 3/4" Meter with Pack Joint for 1" Copper or Plastic Tube (CTS)*	68.44

* **Grip Joint** can be ordered by inserting "-G" into the catalog number. Example: GGAV43-343-G-NL

► **Ultra-Tite** is available. Insert "-U-NA" into the catalog number (shipped unassembled). Contact factory for pricing and availability. Example: GGAV43-343-U-NA-NL

NOTE: Installation screws are included with Yokebox valves and outlet pieces.

NOTE: Ford Pack, Quick and Grip Joint compression connections, when used on copper, are designed for Type K or Type L copper only.

FORD LONG YOKEBOX FOR 1" METERS
Center Line of Meter 9" Below Grade
Straight Inlet - Straight Outlet

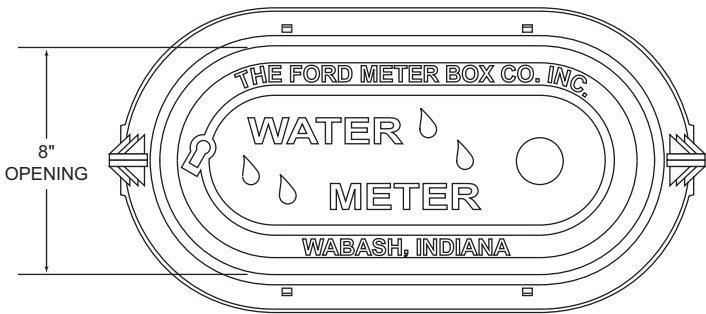

The Long Yokebox for 1" meters has a two-piece body and a locking lid. A straight ball valve on the inlet and outlet is standard.

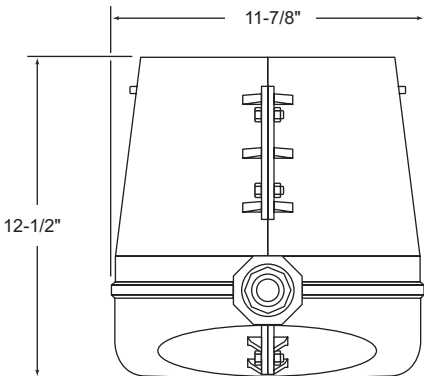
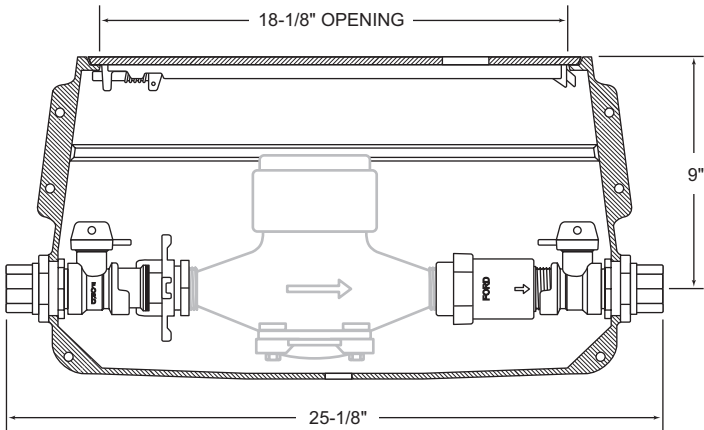

LONG YOKEBOXES FOR 1" METERS

CATALOG NUMBER	DESCRIPTION		APPROX. WT. LBS.	LIST PRICE
	STRAIGHT INLET	STRAIGHT OUTLET		
LYLBB111-444-NL	1" Female Iron Pipe Threads	1" Female Iron Pipe Threads	78.4	\$ 1032.43
LYLBB121-444-NL	1" Flare Copper Tube Nut	1" Female Iron Pipe Threads	78.9	1056.09
LYLBB122-444-NL	1" Flare Copper Tube Nut	1" Flare Copper Tube Nut	79.4	1079.74
►♦ LYLBB141-444-NL	1" Pack Joint for Plastic or Copper Tubing (CTS)*	1" Female Iron Pipe Threads	78.7	1062.29
►♦ LYLBB144-444-NL	1" Pack Joint for Copper or Plastic Tubing (CTS)*	1" Pack Joint for Copper or Plastic Tubing (CTS)*	79.0	1092.24

NOTE: Ford Pack, Quick and Grip Joint compression connections, when used on copper, are designed for Type K or Type L copper only.

All Ford Long Yokeboxes include an ASSE 1024 approved
cartridge style dual check valve contained completely within the Yokebox.

Ordering Information

Plastic lid option: Insert "-P" into the catalog number for locking plastic lid.....no additional charge
Example: LYLBBxxx-xxx-P-NL
Insert "-PB" into the catalog number for locking plastic lid with ERT bracket, add to price.....\$ 7.86
Example: LYLBBxxx-xxx-PB-NL
Insert "-PLB" into the catalog number for locking plastic lid with large ERT bracket, add to price.....\$ 30.84
Example: LYLBBxxx-xxx-PLB-NL

- * Grip Joint can be ordered by inserting "-G" into the catalog number. Example: LYLBB141-444-G-NL
- ♦ Quick Joint is available. Insert "-Q" into the catalog number. Example: LYLBB141-444-Q-NL
- Ultra-Tite is available by inserting "-U-NA" into the catalog number (shipped unassembled). Contact factory for pricing and availability.
Example: LYLBB141-444-U-NA-NL

Gaskets are furnished – Flat gaskets for valve and outlet saddles; beveled and flat gaskets for expansion connections.
Ford 1" Long Yokeboxes have a locking iron lid as standard.
A lockable expansion connection is available. See page 13.
The ball valve inlet and outlet attach to the 1" Long Yokebox by using a brass lock nut. Brass components are not assembled to box in order to prevent damage during shipping, storage and handling.

FORD LONG YOKE BOX OPTIONS AND ACCESSORIES

For 1" Long Yokeboxes

EXPANSION CONNECTIONS OPTIONS FOR 1" LONG YOKEBOXES

CATALOG NUMBER	DESCRIPTION	LIST PRICE
EC-4-NL	Expansion Connection for 1" Meter	\$ 80.57
ECL-4-NL	Locking Expansion Connection for 1" Meter without Security Screw	139.71
ECL-4-SSF-NL	Locking Expansion Connection for 1" Meter with Security Screw	146.22
GT-211	1" Flat Expansion Connection Gasket	1.84
GT-123	1" Rubber Gasket for Saddle	0.75
GT-34	1" Beveled Expansion Connection Gasket	2.18
BOLT-800998-SSF	Security Screw (fits all Ford locking expansions)	7.26
KEY-800999-SSF	Security Key / Tip Only for Locking Expansion Connection	83.34
NUT-DR-040072-SSF	Magnetic Nut Driver Less Key / Tip	43.58

VALVES AND PARTS FOR 1" LONG YOKEBOXES

CATALOG NUMBER	DESCRIPTION	APPROX. WT. LBS.	LIST PRICE
HHCI33-444-3-937PE-NL	Cartridge Style Dual Check Valve for 1" Long Yokebox	2.8	\$ 321.75
LYBB-4	Body Assembly for 1" Long Yokebox	57.2	262.44
LY4GA	Iron Grade Adjuster for 1" Long Yokebox	19.4	174.84
LY4IR-2	2" Iron Riser for 1" Long Yokebox	12.2	155.04
LYL-4	Iron Locking Lid for 1" Long Yokebox	11.0	106.78
LYLP-4	Plastic Locking Lid for 1" Long Yokebox	2.4	106.78
LYLP-4-BR	Plastic Locking Lid with ERT Bracket for 1" Long Yokebox	2.6	114.66
LYLP-4-LBR	Plastic Locking Lid with Large ERT Bracket for 1" Long Yokebox	2.8	137.61
PBR-YJ	Plastic ERT Bracket with (3) Stainless Steel Clips (field installation only on plastic lids)	0.1	9.68
YBBV13-344W-NL	1" Long Yokebox Ball Valve for 1" FIP	3.1	197.75
YBBV43-344W-NL	1" Long Yokebox Ball Valve with Pack Joint for 1" CTS	3.4	239.32
YBBV43-344W-G-NL	1" Long Yokebox Ball Valve with Grip Joint for 1" CTS	3.4	239.32
YBBV43-344W-Q-NL	1" Long Yokebox Ball Valve with Quick Joint for 1" CTS	3.5	239.32
YBBV23-344W-NL	1" Long Yokebox Ball Valve for 1" Flare Copper	3.6	223.13

NOTE: "W" indicates valve is available only with padlock wings.

NOTE: Ford Pack, Quick and Grip Joint compression connections, when used on copper, are designed for Type K or Type L copper only.

OPTIONS AND ACCESSORIES FOR 1" LONG YOKEBOXES

CATALOG NUMBER	DESCRIPTION	LIST PRICE
PTP	Removable Plastic Plug / Nut for Electronic Meter Reading Lid Hole	\$ 11.58
PTP-BR	Removable Plastic Plug for Electronic Meter Reading Lid Hole with ERT Bracket	16.12
MBLK	Yokebox Lid Key	20.33
MBUK	Meter Box Universal Key for Locking Lids, Lockless Lids and Yokebox Valves	60.97
TP	Removable Cast Iron Plug for Electronic Meter Reading Module Hole (with cotter pin)	9.97
TP-PIN-800846	Cotter Pin only for Cast Iron Plug	1.02
Insert "-SP" into Catalog Number	Spacer in Lieu of Dual Check Valve Example: LYLB141-444-SP-NL	Deduct from Price -205.83
Insert "P" into Catalog Number	Plastic Locking Lid Example: LYLB141-444-P-NL	No Charge 0.00
Insert "-PB" into Catalog Number	Plastic Locking Lid with ERT Bracket Example: LYLB141-444-PB-NL	7.86
Insert "-PTP" into Catalog Number	Removable Plastic Plug / Nut for Electronic Meter Reading Lid Hole Example: LYLB141-444-PTP-NL	16.90
Insert "-PTP-BR" into Catalog Number	Removable Plastic Plug for Electronic Meter Reading Lid Hole with ERT Bracket Example: LYLB141-444-PTP-BR-NL	21.45
Insert "-T" into Catalog Number	Electronic Read Iron Lid (2" hole) Example: LYLB141-444-T-NL	5.31
Insert "-TP" into Catalog Number	Electronic Read Iron Lid (2" hole), with Removable Plug Example: LYLB141-111-TP-NL	15.30
Insert "-XA" into Catalog Number	Locking Expansion Connection without Ford Security Screw Example: LYLB141-444-XA-NL	59.13
Insert "-XB" into Catalog Number	Locking Expansion Connection with Ford Security Screw Example: LYLB141-444-XB-NL	65.64
Insert "-XC" into Catalog Number	Expansion Connection with Single Check for 1" Long Yokeboxes Example: LYLB141-444-XC-NL	45.49

YOKEBOXES FOR 5/8" METER

Extra Shallow Type For Modern Magnetic or Multi-Jet Meters
(center line of meter 5" below grade)

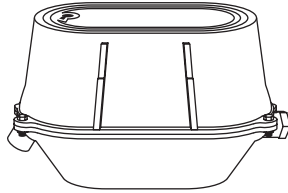

STRAIGHT BALL VALVE INLET - STRAIGHT OUTLET

CATALOG NUMBER	DESCRIPTION		APPROX. WT. LBS.	LIST PRICE
	INLET	OUTLET		
YSB111-133-NL	3/4" Female Iron Pipe Threads	3/4" Female Iron Pipe Threads	27.1	\$ 369.60
YSB122-133-NL	3/4" Flare Copper	3/4" Flare Copper	27.9	374.33
► YSB141-133-NL	3/4" Pack Joint for Copper or Plastic Tubing (CTS)*	3/4" Female Iron Pipe Threads	29.0	386.09
► YSB144-133-NL	3/4" Pack Joint for Copper or Plastic Tubing (CTS)*	3/4" Pack Joint for Copper or Plastic Tubing (CTS)*	29.0	401.89

STRAIGHT KEY VALVE INLET - STRAIGHT OUTLET

CATALOG NUMBER	DESCRIPTION		APPROX. WT. LBS.	LIST PRICE
	INLET	OUTLET		
YS111-133-NL	3/4" Double Purpose**	3/4" Female Iron Pipe Threads	29.0	\$ 345.37
YS112-133-NL	3/4" Double Purpose**	3/4" Flare Copper	29.0	354.54
YS122-111-NL	1/2" Flare Copper	1/2" Flare Copper	27.0	341.22
► YS141-133-NL	3/4" Pack Joint for Copper or Plastic Tubing (CTS)*	3/4" Female Iron Pipe Threads	28.0	347.34
YS144-111-NL	1/2" Pack Joint for Copper or Plastic Tubing (CTS)	1/2" Pack Joint for Copper or Plastic Tubing (CTS)	29.0	345.72
► YS144-133-NL	3/4" Pack Joint for Copper or Plastic Tubing (CTS)*	3/4" Pack Joint for Copper or Plastic Tubing (CTS)*	28.0	363.11

STRAIGHT BALL VALVE INLET - STRAIGHT DUAL CHECK OUTLET

CATALOG NUMBER	DESCRIPTION		APPROX. WT. LBS.	LIST PRICE
	INLET	OUTLET		
YSBHC111-133-NL	3/4" Female Iron Pipe Threads	3/4" Female Iron Pipe Threads	30.0	\$ 459.35
YSBHC122-133-NL	3/4" Flare Copper	3/4" Flare Copper	30.0	464.05
► YSBHC141-133-NL	3/4" Pack Joint for Copper or Plastic Tubing (CTS)*	3/4" Female Iron Pipe Threads	30.0	475.71
► YSBHC144-133-NL	3/4" Pack Joint for Copper or Plastic Tubing (CTS)*	3/4" Pack Joint for Copper or Plastic Tubing (CTS)*	30.0	488.34

ANGLE KEY VALVE INLET - STRAIGHT OUTLET

CATALOG NUMBER	DESCRIPTION		APPROX. WT. LBS.	LIST PRICE
	INLET	OUTLET		
YS221-133-NL	3/4" Flare Copper	3/4" Female Iron Pipe Threads	28.0	\$ 328.06
YS222-133-NL	3/4" Flare Copper	3/4" Flare Copper	27.0	337.06
► YS241-133-NL	3/4" Pack Joint for Copper or Plastic Tubing (CTS)*	3/4" Female Iron Pipe Threads	28.0	330.59
► YS242-133-NL	3/4" Pack Joint for Copper or Plastic Tubing (CTS)*	3/4" Flare Copper	28.0	340.21
► YS244-133-NL	3/4" Pack Joint for Copper or Plastic Tubing (CTS)*	3/4" Pack Joint for Copper or Plastic Tubing (CTS)*	28.0	346.41

ANGLE KEY VALVE INLET - ANGLE OUTLET

CATALOG NUMBER	DESCRIPTION		APPROX. WT. LBS.	LIST PRICE
	INLET	OUTLET		
YS322-133-NL	3/4" Flare Copper	3/4" Flare Copper	28.0	\$ 338.22
► YS342-133-NL	3/4" Pack Joint for Copper or Plastic Tubing (CTS)*	3/4" Flare Copper	28.0	340.72

NOTE: Ford Pack, Quick and Grip Joint compression connections, when used on copper, are designed for Type K or Type L copper only.

Ordering Information

Insert "-P" into the catalog number for locking plastic lid. Example: YSBxxx-xxx-P-NL..... **no additional charge**

* **Grip Joint** can be ordered by inserting "-G" into the catalog number. Example: YSB141-133-G-NL

► Ultra-Tite is available. Insert "-U-NA" into the catalog number (shipped unassembled). Contact factory for pricing and availability.
Example: YSB141-133-U-NA-NL

** **The double purpose coupling** connects to either 3/4" threaded iron pipe or 3/4" flared copper tubing.

Gaskets are furnished – Flat gaskets for valve and outlet saddles; beveled and flat gaskets for expansion connections.

Special expansion connection options are available. See page 22.

Ford Long Yokeboxes have a locking iron lid as standard. An optional lockless iron lid can be ordered by inserting "-LL" into the catalog number.
Example: YSB111-133-LL-NL

YOKEBOXES FOR 5/8" METER (CONTINUED)

Shallow Type (center line of meter 8" below grade)

STRAIGHT BALL VALVE INLET - STRAIGHT OUTLET

CATALOG NUMBER	DESCRIPTION		APPROX. WT. LBS.	LIST PRICE
	INLET	OUTLET		
YLB111-133-NL	3/4" Female Iron Pipe Threads	3/4" Female Iron Pipe Threads	29.9	\$ 394.05
YLB122-133-NL	3/4" Flare Copper	3/4" Flare Copper	35.0	398.82
► YLB141-133-NL	3/4" Pack Joint for Copper or Plastic Tubing (CTS)*	3/4" Female Iron Pipe Threads	30.3	410.44
► YLB144-133-NL	3/4" Pack Joint for Copper or Plastic Tubing (CTS)*	3/4" Pack Joint for Copper or Plastic Tubing (CTS)*	30.6	426.27

STRAIGHT KEY VALVE INLET - STRAIGHT OUTLET

CATALOG NUMBER	DESCRIPTION		APPROX. WT. LBS.	LIST PRICE
	INLET	OUTLET		
YL111-133-NL	3/4" Double Purpose**	3/4" Female Iron Pipe Threads	35.0	\$ 369.63
YL112-133-NL	3/4" Double Purpose**	3/4" Flare Copper	36.0	379.47
YL122-111-NL	1/2" Flare Copper	1/2" Flare Copper	34.0	366.16
► YL141-133-NL	3/4" Pack Joint for Copper or Plastic Tubing (CTS)*	3/4" Female Iron Pipe Threads	35.0	372.25
YL144-111-NL	1/2" Pack Joint for Copper or Plastic Tubing (CTS)	1/2" Pack Joint for Copper or Plastic Tubing (CTS)	35.0	370.15
► YL144-133-NL	3/4" Pack Joint for Copper or Plastic Tubing (CTS)*	3/4" Pack Joint for Copper or Plastic Tubing (CTS)*	35.0	388.11

STRAIGHT BALL VALVE INLET - STRAIGHT DUAL CHECK OUTLET

CATALOG NUMBER	DESCRIPTION		APPROX. WT. LBS.	LIST PRICE
	INLET	DUAL CHECK OUTLET		
YLBHC111-133-NL	3/4" Female Iron Pipe Threads	3/4" Female Iron Pipe Threads	36.0	\$ 483.71
YLBHC122-133-NL	3/4" Flare Copper	3/4" Flare Copper	36.0	488.45
► YLBHC141-133-NL	3/4" Pack Joint for Copper or Plastic Tubing (CTS)*	3/4" Female Iron Pipe Threads	36.0	500.25
► YLBHC144-133-NL	3/4" Pack Joint for Copper or Plastic Tubing (CTS)*	3/4" Pack Joint for Copper or Plastic Tubing (CTS)*	36.0	512.78

STRAIGHT KEY VALVE INLET - STRAIGHT DUAL CHECK OUTLET

CATALOG NUMBER	DESCRIPTION		APPROX. WT. LBS.	LIST PRICE
	INLET	DUAL CHECK OUTLET		
► YLHC141-133-NL	3/4" Pack Joint for Copper or Plastic Tubing (CTS)*	3/4" Female Iron Pipe Threads	39.0	\$ 475.30

ANGLE KEY VALVE INLET - STRAIGHT OUTLET

CATALOG NUMBER	DESCRIPTION		APPROX. WT. LBS.	LIST PRICE
	INLET	OUTLET		
YL221-133-NL	3/4" Flare Copper	3/4" Female Iron Pipe Threads	35.0	\$ 353.13
YL222-133-NL	3/4" Flare Copper	3/4" Flare Copper	34.0	361.99
► YL241-133-NL	3/4" Pack Joint for Copper or Plastic Tubing (CTS)*	3/4" Female Iron Pipe Threads	35.0	355.48
► YL242-133-NL	3/4" Pack Joint for Copper or Plastic Tubing (CTS)*	3/4" Flare Copper	35.0	365.19
► YL244-133-NL	3/4" Pack Joint for Copper or Plastic Tubing (CTS)*	3/4" Pack Joint for Copper or Plastic Tubing (CTS)*	35.0	371.39

ANGLE KEY VALVE INLET - STRAIGHT DUAL CHECK OUTLET

CATALOG NUMBER	DESCRIPTION		APPROX. WT. LBS.	LIST PRICE
	INLET	DUAL CHECK OUTLET		
YLHC221-133-NL	3/4" Flare Copper	3/4" Female Iron Pipe Threads	39.0	\$ 452.67
YLHC222-133-NL	3/4" Flare Copper	3/4" Flare Copper	39.0	465.65
► YLHC241-133-NL	3/4" Pack Joint for Copper or Plastic Tubing (CTS)*	3/4" Female Iron Pipe Threads	39.0	455.23
► YLHC244-133-NL	3/4" Pack Joint for Copper or Plastic Tubing (CTS)*	3/4" Pack Joint for Copper or Plastic Tubing (CTS)*	39.0	474.55

ANGLE KEY VALVE INLET - ANGLE OUTLET

CATALOG NUMBER	DESCRIPTION		APPROX. WT. LBS.	LIST PRICE
	INLET	OUTLET		
YL322-133-NL	3/4" Flare Copper	3/4" Flare Copper	36.0	\$ 363.90
► YL342-133-NL	3/4" Pack Joint for Copper or Plastic Tubing (CTS)*	3/4" Flare Copper	36.0	365.62

NOTE: Ford Pack, Quick and Grip Joint compression connections, when used on copper, are designed for Type K or Type L copper only.

Ordering Information

Plastic lid option: Insert "-P" into the catalog number for locking plastic lid.....no additional charge

Example: YLxxx-xxx-P-NL

Insert "-PB" into the catalog number for locking plastic lid with ERT bracket, add to price.....\$ 7.86

Example: YLxxx-xxx-PB-NL

Add "-PLB" into the catalog number for locking plastic lid with large ERT bracket, add to price\$ 30.84

Example: YLxxx-xxx-PLB-NL

* **Grip Joint** can be ordered by inserting "-G" into the catalog number. Example: YL241-133-G-NL

► Ultra-Tite is available. Insert "-U-NA" into the catalog number (shipped unassembled). Contact factory for pricing and availability.

Example: YL241-133-U-NA-NL

** **The double purpose coupling** connects to either 3/4" threaded iron pipe or 3/4" flared copper tubing.

Special expansion connection options are available. See page 22.

Ford Long Yokeboxes have a locking iron lid as standard. An optional lockless iron lid can be ordered by inserting "-LL" into the catalog number.

Example: YLB111-133-LL-NL

Add "**JP**" to the end of the alpha code and insert "**-P**" into the catalog number on a YL Yokebox requiring a plastic enlarged upper section and plastic lid. Example: YLB**JP**xxx-xxx-P-NL. Deduct from price\$ -15.54

YOKEBOXES FOR 5/8" METER (CONTINUED)*Deep Type (center line of meter 10" below grade)***STRAIGHT BALL VALVE INLET - STRAIGHT OUTLET**

CATALOG NUMBER	DESCRIPTION		APPROX. WT. LBS.	LIST PRICE
	INLET	OUTLET		
YMB111-133-NL	3/4" Female Iron Pipe Threads	3/4" Female Iron Pipe Threads	33.0	\$ 415.77
YMB122-133-NL	3/4" Flare Copper	3/4" Flare Copper	35.0	420.80
► YMB141-133-NL	3/4" Pack Joint for Copper or Plastic Tubing (CTS)*	3/4" Female Iron Pipe Threads	35.0	436.41
► YMB144-133-NL	3/4" Pack Joint for Copper or Plastic Tubing (CTS)*	3/4" Pack Joint for Copper or Plastic Tubing (CTS)*	33.7	448.34

STRAIGHT KEY VALVE INLET - STRAIGHT OUTLET

CATALOG NUMBER	DESCRIPTION		APPROX. WT. LBS.	LIST PRICE
	INLET	OUTLET		
YM111-133-NL	3/4" Double Purpose**	3/4" Female Iron Pipe Threads	35.0	\$ 391.49
YM112-133-NL	3/4" Double Purpose**	3/4" Flare Copper	35.0	401.01
YM122-111-NL	1/2" Flare Copper	1/2" Flare Copper	35.0	388.90
► YM141-133-NL	3/4" Pack Joint for Copper or Plastic Tubing (CTS)*	3/4" Female Iron Pipe Threads	35.0	394.37
YM144-111-NL	1/2" Pack Joint for Copper or Plastic Tubing (CTS)	1/2" Pack Joint for Copper or Plastic Tubing (CTS)	35.0	392.23
► YM144-133-NL	3/4" Pack Joint for Copper or Plastic Tubing (CTS)*	3/4" Pack Joint for Copper or Plastic Tubing (CTS)*	35.0	410.22

STRAIGHT BALL VALVE INLET - STRAIGHT DUAL CHECK VALVE OUTLET

CATALOG NUMBER	DESCRIPTION		APPROX. WT. LBS.	LIST PRICE
	INLET	OUTLET		
YMBHC111-133-NL	3/4" Female Iron Pipe Threads	3/4" Female Iron Pipe Threads	35.5	\$ 505.43
YMBHC122-133-NL	3/4" Flare Copper	3/4" Flare Copper	36.0	510.58
► YMBHC141-133-NL	3/4" Pack Joint for Copper or Plastic Tubing (CTS)*	3/4" Female Iron Pipe Threads	36.0	522.37
► YMBHC144-133-NL	3/4" Pack Joint for Copper or Plastic Tubing (CTS)*	3/4" Pack Joint for Copper or Plastic Tubing (CTS)*	36.0	534.81

STRAIGHT KEY VALVE INLET - STRAIGHT DUAL CHECK OUTLET

CATALOG NUMBER	DESCRIPTION		APPROX. WT. LBS.	LIST PRICE
	INLET	DUAL CHECK OUTLET		
YMHC141-133-NL	3/4" Pack Joint for Copper or Plastic Tubing (CTS)*	3/4" Female Iron Pipe Threads	40.0	\$ 496.84

ANGLE KEY VALVE INLET - STRAIGHT OUTLET

CATALOG NUMBER	DESCRIPTION		APPROX. WT. LBS.	LIST PRICE
	INLET	OUTLET		
YM221-133-NL	3/4" Flare Copper	3/4" Female Iron Pipe Threads	35.0	\$ 375.16
YM222-133-NL	3/4" Flare Copper	3/4" Flare Copper	35.0	384.52
► YM241-133-NL	3/4" Pack Joint for Copper or Plastic Tubing (CTS)*	3/4" Female Iron Pipe Threads	35.0	377.76
► YM242-133-NL	3/4" Pack Joint for Copper or Plastic Tubing (CTS)*	3/4" Flare Copper	35.0	387.04
► YM244-133-NL	3/4" Pack Joint for Copper or Plastic Tubing (CTS)*	3/4" Pack Joint for Copper or Plastic Tubing (CTS)*	35.0	393.50

ANGLE KEY VALVE INLET - STRAIGHT DUAL CHECK OUTLET

CATALOG NUMBER	DESCRIPTION		APPROX. WT. LBS.	LIST PRICE
	INLET	DUAL CHECK OUTLET		
YMHC221-133-NL	3/4" Flare Copper	3/4" Female Iron Pipe Threads	40.0	\$ 477.27
YMHC222-133-NL	3/4" Flare Copper	3/4" Flare Copper	40.0	486.94
► YMHC241-133-NL	3/4" Pack Joint for Copper or Plastic Tubing (CTS)*	3/4" Female Iron Pipe Threads	40.0	480.31
► YMHC244-133-NL	3/4" Pack Joint for Copper or Plastic Tubing (CTS)*	3/4" Pack Joint for Copper or Plastic Tubing (CTS)*	40.0	496.08

ANGLE KEY VALVE INLET - ANGLE OUTLET

CATALOG NUMBER	DESCRIPTION		APPROX. WT. LBS.	LIST PRICE
	INLET	OUTLET		
YM322-133-NL	3/4" Flare Copper	3/4" Flare Copper	35.0	\$ 385.25
► YM344-133-NL	3/4" Pack Joint for Copper or Plastic Tubing (CTS)*	3/4" Pack Joint for Copper or Plastic Tubing (CTS)*	35.0	387.82

NOTE: Ford Pack, Quick and Grip Joint compression connections, when used on copper, are designed for Type K or Type L copper only.

Ordering Information

Plastic lid option: Insert "-P" into the catalog number for locking plastic lid.....no additional charge

Example: YMxxx-xxx-P-NL

Insert "-PB" into the catalog number for locking plastic lid with ERT bracket, add to price \$ 7.86

Example: YMxxx-xxx-PB-NL

Insert "-PLB" into the catalog number for locking plastic lid with large ERT bracket, add to price \$ 30.84

Example: YMxxx-xxx-PLB-NL

* **Grip Joint** can be ordered by inserting "-G" into the catalog number. Example: YM241-133-G-NL

► **Ultra-Tite** is available. Insert "-U-NA" into the catalog number (shipped unassembled). Contact factory for pricing and availability.

Example: YM241-133-U-NA-NL

** **The double purpose coupling** connects to either 3/4" threaded iron pipe or 3/4" flared copper tubing.

Special expansion connection options are available. See page 22.

Ford Yokeboxes have a locking iron lid as standard. An optional lockless iron lid can be ordered by inserting "-LL" into the catalog number.

Example: YM244-133-LL-NL

Add "**JP**" to the end of the alpha code and insert "-P" into the catalog number on a YM Yokebox requiring a plastic enlarged upper section and plastic lid. Example: YMB**JP**xxx-xxx-P-NL. Deduct from price \$ -23.81

YOKEBOXES FOR 5/8" X 3/4" METER

Extra Shallow Type for Modern Magnetic or Multi-Jet Meters

(center line of meter 5" below grade)

STRAIGHT BALL VALVE INLET - STRAIGHT OUTLET

CATALOG NUMBER	DESCRIPTION		APPROX. WT. LBS.	LIST PRICE
	INLET	OUTLET		
YSB111-233-NL	3/4" Female Iron Pipe Threads	3/4" Female Iron Pipe Threads	29.0	\$ 373.67
YSB122-233-NL	3/4" Flare Copper	3/4" Flare Copper	29.0	378.48
▶ YSB141-233-NL	3/4" Pack Joint for Copper or Plastic Tubing (CTS)*	3/4" Female Iron Pipe Threads	29.0	390.12
▶ YSB144-233-NL	3/4" Pack Joint for Copper or Plastic Tubing (CTS)*	3/4" Pack Joint for Copper or Plastic Tubing (CTS)*	29.0	406.05
YSB171-233-NL	3/4" Pack Joint for PVC/IPS PE	3/4" Female Iron Pipe Threads	29.0	419.84
YSB177-233-NL	3/4" Pack Joint for PVC/IPS PE	3/4" Pack Joint for PVC/IPS PE	29.0	447.97

STRAIGHT KEY VALVE INLET - STRAIGHT OUTLET

CATALOG NUMBER	DESCRIPTION		APPROX. WT. LBS.	LIST PRICE
	INLET	OUTLET		
YS111-233-NL	3/4" Double Purpose **	3/4" Female Iron Pipe Threads	29.0	\$ 349.24
YS112-233-NL	3/4" Double Purpose **	3/4" Flare Copper	29.0	358.68
YS141-233-NL	3/4" Pack Joint for Copper or Plastic Tubing (CTS)*	3/4" Female Iron Pipe Threads	28.0	351.39
YS141-243-NL	1" Pack Joint for Copper or Plastic Tubing (CTS)*	3/4" Female Iron Pipe Threads	27.0	368.63
▶ YS144-233-NL	3/4" Pack Joint for Copper or Plastic Tubing (CTS)*	3/4" Pack Joint for Copper or Plastic Tubing (CTS)*	28.0	367.25
▶ YS161-233-NL	3/4" Pack Joint for PE Pipe*	3/4" Female Iron Pipe Threads	27.0	368.63
▶ YS164-233-NL	3/4" Pack Joint for PE Pipe*	3/4" Pack Joint for Copper or Plastic Tubing (CTS)*	28.0	384.96
YS171-233-NL	3/4" Pack Joint for PVC/IPS PE Pipe	3/4" Female Iron Pipe Threads	28.0	369.15
YS177-233-NL	3/4" Pack Joint for PVC/IPS PE Pipe	3/4" Pack Joint for PVC/IPS PE Pipe	27.0	394.52

STRAIGHT BALL VALVE INLET - STRAIGHT DUAL CHECK OUTLET

CATALOG NUMBER	DESCRIPTION		APPROX. WT. LBS.	LIST PRICE
	INLET	OUTLET		
YSBHC111-233-NL	3/4" Female Iron Pipe Threads	3/4" Female Iron Pipe Threads	30.0	\$ 463.32
YSBHC122-233-NL	3/4" Flare Copper	3/4" Flare Copper	30.0	468.12
▶ YSBHC141-233-NL	3/4" Pack Joint for Copper or Plastic Tubing (CTS)*	3/4" Female Iron Pipe Threads	30.0	479.71
▶ YSBHC144-233-NL	3/4" Pack Joint for Copper or Plastic Tubing (CTS)*	3/4" Pack Joint for Copper or Plastic Tubing (CTS)*	30.0	492.43
YSBHC147-233-NL	3/4" Pack Joint for Copper or Plastic Tubing (CTS)*	3/4" Pack Joint for PVC/IPS PE Pipe	30.0	510.88
YSBHC171-233-NL	3/4" Pack Joint for PVC/IPS PE	3/4" Female Iron Pipe Threads	30.0	509.40
YSBHC177-233-NL	3/4" Pack Joint for PVC/IPS PE	3/4" Pack Joint for PVC/IPS PE	30.0	540.63

ANGLE KEY VALVE INLET - STRAIGHT OUTLET

CATALOG NUMBER	DESCRIPTION		APPROX. WT. LBS.	LIST PRICE
	INLET	OUTLET		
YS221-233-NL	3/4" Flare Copper	3/4" Female Iron Pipe Threads	28.0	\$ 332.11
YS222-233-NL	3/4" Flare Copper	3/4" Flare Copper	27.0	341.10
▶ ♦ YS241-233-NL	3/4" Pack Joint for Copper or Plastic Tubing (CTS)*	3/4" Female Iron Pipe Threads	27.7	334.63
YS241-243-NL	1" Pack Joint for Copper or Plastic Tubing (CTS)*	3/4" Female Iron Pipe Threads	27.0	348.11
▶ ♦ YS242-233-NL	3/4" Pack Joint for Copper or Plastic Tubing (CTS)*	3/4" Flare Copper	28.0	344.12
▶ YS244-233-NL	3/4" Pack Joint for Copper or Plastic Tubing (CTS)*	3/4" Pack Joint for Copper or Plastic Tubing (CTS)*	28.0	350.60
▶ YS261-233-NL	3/4" Pack Joint for PE Pipe*	3/4" Female Iron Pipe Threads	27.0	348.11
YS261-243-NL	1" Pack Joint for PE Pipe*	3/4" Female Iron Pipe Threads	27.0	390.98
▶ YS262-233-NL	3/4" Pack Joint for PE Pipe*	3/4" Flare Copper	28.0	358.03
YS262-243-NL	1" Pack Joint for PE Pipe*	3/4" Flare Copper	28.0	400.91
▶ YS264-233-NL	3/4" Pack Joint for PE Pipe*	3/4" Pack Joint for Copper or Plastic Tubing (CTS)*	28.0	364.63
YS264-243-NL	1" Pack Joint for PE Pipe*	3/4" Pack Joint for Copper or Plastic Tubing (CTS)*	28.0	407.51

ANGLE KEY VALVE INLET - ANGLE OUTLET

CATALOG NUMBER	DESCRIPTION		APPROX. WT. LBS.	LIST PRICE
	INLET	OUTLET		
YS322-233-NL	3/4" Flare Copper	3/4" Flare Copper	28.0	\$ 342.28
▶ ♦ YS342-233-NL	3/4" Pack Joint for Copper or Plastic Tubing (CTS)*	3/4" Flare Copper	28.0	344.94
▶ YS344-233-NL	3/4" Pack Joint for Copper or Plastic Tubing (CTS)*	3/4" Pack Joint for Copper or Plastic Tubing (CTS)*	28.0	351.36

NOTE: Ford Pack, Quick and Grip Joint compression connections, when used on copper, are designed for Type K or Type L copper only.

Ordering Information

Plastic lid option: Insert "-P" into the catalog number for locking plastic lid **no additional charge**
Example: YSxxx-xxx-P-NL

* **Grip Joint** for CTS and PEP (3/4" and 1") can be ordered by inserting "-G" into the catalog number. Example: YSB141-233-G-NL

♦ **Quick Joint** is available. Insert "-Q" into the catalog number. Example: YS241-233-Q-NL

▶ **Ultra-Tite** is available. Insert "-U-NA" into the catalog number (shipped unassembled). Contact factory for pricing and availability.
Example: YS241-233-U-NA-NL

** **The double purpose coupling** connects to either 3/4" threaded iron pipe or 3/4" flared copper tubing.

Special expansion connection options are available. See page 22.

Ford Yokeboxes have a locking iron lid as standard. An optional lockless iron lid can be ordered by inserting "-LL" into the catalog number.

Example: YSB111-233-LL-NL

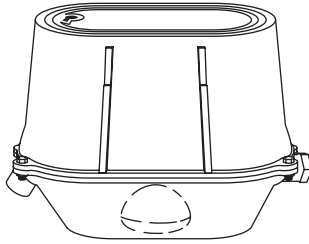
YOKEBOXES FOR 5/8" X 3/4" METER (CONTINUED)*Shallow Type (center line of meter 8" below grade)***STRAIGHT BALL VALVE INLET - STRAIGHT OUTLET**

CATALOG NUMBER	DESCRIPTION		APPROX. WT. LBS.	LIST PRICE
	INLET	OUTLET		
YLB111-233-NL	3/4" Female Iron Pipe Threads	3/4" Female Iron Pipe Threads	30.2	\$ 397.87
YLB122-233-NL	3/4" Flare Copper	3/4" Flare Copper	35.0	416.47
► YLB141-233-NL	3/4" Pack Joint for Copper or Plastic Tubing (CTS)*	3/4" Female Iron Pipe Threads	30.5	428.09
► YLB144-233-NL	3/4" Pack Joint for Copper or Plastic Tubing (CTS)*	3/4" Pack Joint for Copper or Plastic Tubing (CTS)*	46.8	430.41
YLB171-233-NL	3/4" Pack Joint for PVC/IPS PE	3/4" Female Iron Pipe Threads	35.0	457.81
YLB177-233-NL	3/4" Pack Joint for PVC/IPS PE	3/4" Pack Joint for PVC/IPS PE	35.0	472.34

STRAIGHT KEY VALVE INLET - STRAIGHT OUTLET

CATALOG NUMBER	DESCRIPTION		APPROX. WT. LBS.	LIST PRICE
	INLET	OUTLET		
YL111-233-NL	3/4" Double Purpose**	3/4" Female Iron Pipe Threads	31.3	\$ 374.19
YL112-233-NL	3/4" Double Purpose**	3/4" Flare Copper	36.0	383.65
► YL141-233-NL	3/4" Pack Joint for Copper or Plastic Tubing (CTS)*	3/4" Female Iron Pipe Threads	30.9	389.88
► YL141-243-NL	1" Pack Joint for Copper or Plastic Tubing (CTS)*	3/4" Female Iron Pipe Threads	31.0	393.51
► YL144-233-NL	3/4" Pack Joint for Copper or Plastic Tubing (CTS)*	3/4" Pack Joint for Copper or Plastic Tubing (CTS)*	35.0	392.23
► YL161-233-NL	3/4" Pack Joint for PE Pipe*	3/4" Female Iron Pipe Threads	31.0	393.51
► YL164-233-NL	3/4" Pack Joint for PE Pipe*	3/4" Pack Joint for Copper or Plastic Tubing (CTS)*	35.0	409.99
YL171-233-NL	3/4" Pack Joint for PVC/IPS PE Pipe	3/4" Female Iron Pipe Threads	31.1	394.20
YL177-233-NL	3/4" Pack Joint for PVC/IPS PE Pipe	3/4" Pack Joint for PVC/IPS PE Pipe	31.5	419.50

STRAIGHT BALL VALVE INLET - STRAIGHT DUAL CHECK OUTLET

CATALOG NUMBER	DESCRIPTION		APPROX. WT. LBS.	LIST PRICE
	INLET	DUAL CHECK OUTLET		
YLBHC111-233-NL	3/4" Female Iron Pipe Threads	3/4" Female Iron Pipe Threads	32.4	\$ 487.60
YLBHC122-233-NL	3/4" Flare Copper	3/4" Flare Copper	36.0	506.08
► YLBHC141-233-NL	3/4" Pack Joint for Copper or Plastic Tubing (CTS)*	3/4" Female Iron Pipe Threads	32.8	517.81
► YLBHC144-233-NL	3/4" Pack Joint for Copper or Plastic Tubing (CTS)*	3/4" Pack Joint for Copper or Plastic Tubing (CTS)*	36.0	526.38
YLBHC147-233-NL	3/4" Pack Joint for Copper or Plastic Tubing (CTS)*	3/4" Pack Joint for PVC/IPS PE Pipe	36.0	544.86
YLBHC171-233-NL	3/4" Pack Joint for PVC/IPS PE	3/4" Female Iron Pipe Threads	36.0	547.55
YLBHC177-233-NL	3/4" Pack Joint for PVC/IPS PE	3/4" Pack Joint for PVC/IPS PE	36.0	574.57

STRAIGHT KEY VALVE INLET - STRAIGHT DUAL CHECK OUTLET

CATALOG NUMBER	DESCRIPTION		APPROX. WT. LBS.	LIST PRICE
	INLET	DUAL CHECK OUTLET		
YLHC121-233-NL	3/4" Flare Copper	3/4" Female Iron Pipe Threads	34.0	\$ 477.45
► YLHC141-233-NL	3/4" Pack Joint for Copper or Plastic Tubing (CTS)*	3/4" Female Iron Pipe Threads	33.9	492.93
YLHC147-233-NL	3/4" Pack Joint for Copper or Plastic Tubing (CTS)*	3/4" Pack Joint for PVC/IPS PE Pipe	39.0	524.62

NOTE: Ford Pack Joints for PVC are recommended for Schedule 40 and Schedule 80 pipe and IPS PE DR9 and DR11 only.

NOTE: Ford Pack, Quick and Grip Joint compression connections, when used on copper, are designed for Type K or Type L copper only.

Ordering Information

Plastic lid option: Insert "-P" into the catalog number for locking plastic lid..... **no additional charge**

Example: YLxxx-xxx-P-NL

Insert "-PB" into the catalog number for locking plastic lid with ERT bracket, add to price..... **\$ 7.86**

Example: YLxxx-xxx-PB-NL

Insert "-PLB" into the catalog number for locking plastic lid with large ERT bracket, add to price **\$ 30.84**

Example: YLxxx-xxx-PLB-NL

* **Grip Joint** for CTS and PEP (3/4" and 1") can be ordered by inserting "-G" into the catalog number. Example: YLB141-233-G-NL

► **Ultra-Tite** is available. Insert "-U-NA" into the catalog number (shipped unassembled). Contact factory for pricing and availability.

Example: YLB141-233-U-NA-NL

** **The double purpose coupling** connects to either 3/4" threaded iron pipe or 3/4" flared copper tubing.

Special expansion connection options are available. See page 22.

Ford Yokeboxes have a locking iron lid as standard. An optional lockless iron lid can be ordered by inserting "-LL" into the catalog number.

Example: YL141-233-LL-NL

Add "**JP**" to the end of the alpha code and insert "**-P**" into the catalog number on a YL Yokebox requiring a plastic enlarged upper section and plastic lid. Example: YLB**JP**xxx-xxx-P-NL. Deduct from price **\$ -15.54**

YOKEBOXES FOR 5/8" X 3/4" METER (CONTINUED)

Shallow Type (center line of meter 8" below grade)

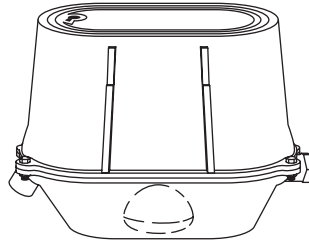

ANGLE KEY VALVE INLET - STRAIGHT OUTLET

CATALOG NUMBER	DESCRIPTION		APPROX. WT. LBS.	LIST PRICE
	INLET	OUTLET		
YL221-233-NL	3/4" Flare Copper	3/4" Female Iron Pipe Threads	35.0	\$ 357.11
YL222-233-NL	3/4" Flare Copper	3/4" Flare Copper	34.0	366.00
▶♦ YL241-233-NL	3/4" Pack Joint for Copper or Plastic Tubing (CTS)*	3/4" Female Iron Pipe Threads	30.5	359.59
YL241-243-NL	1" Pack Joint for Copper or Plastic Tubing (CTS)*	3/4" Female Iron Pipe Threads	30.6	372.96
▶♦ YL242-233-NL	3/4" Pack Joint for Copper or Plastic Tubing (CTS)*	3/4" Flare Copper	35.0	369.12
▶ YL244-233-NL	3/4" Pack Joint for Copper or Plastic Tubing (CTS)*	3/4" Pack Joint for Copper or Plastic Tubing (CTS)*	30.8	375.58
▶ YL261-233-NL	3/4" Pack Joint for PE Pipe*	3/4" Female Iron Pipe Threads	30.6	373.68
YL261-243-NL	1" Pack Joint for PE Pipe*	3/4" Female Iron Pipe Threads	35.0	416.59
▶ YL262-233-NL	3/4" Pack Joint for PE Pipe*	3/4" Flare Copper	35.0	383.05
YL262-243-NL	1" Pack Joint for PE Pipe*	3/4" Flare Copper	35.0	423.49
▶ YL264-233-NL	3/4" Pack Joint for PE Pipe*	3/4" Pack Joint for Copper or Plastic Tubing (CTS)*	35.0	389.59
YL264-243-NL	1" Pack Joint for PE Pipe*	3/4" Pack Joint for Copper or Plastic Tubing (CTS)*	35.0	432.44

ANGLE KEY VALVE INLET - STRAIGHT DUAL CHECK OUTLET

CATALOG NUMBER	DESCRIPTION		APPROX. WT. LBS.	LIST PRICE
	INLET	DUAL CHECK OUTLET		
YLHC221-233-NL	3/4" Flare Copper	3/4" Female Iron Pipe Threads	33.6	\$ 460.22
YLHC222-233-NL	3/4" Flare Copper	3/4" Flare Copper	39.0	469.64
▶♦ YLHC241-233-NL	3/4" Pack Joint for Copper or Plastic Tubing (CTS)*	3/4" Female Iron Pipe Threads	33.5	462.66
▶ YLHC244-233-NL	3/4" Pack Joint for Copper or Plastic Tubing (CTS)*	3/4" Pack Joint for Copper or Plastic Tubing (CTS)*	33.7	478.62
YLHC247-233-NL	3/4" Pack Joint for Copper or Plastic Tubing (CTS)*	3/4" Pack Joint for PVC/IPS PE Pipe	39.0	497.10
▶ YLHC261-233-NL	3/4" Pack Joint for PE Pipe*	3/4" Female Iron Pipe Threads	39.0	476.77
YLHC261-243-NL	1" Pack Joint for PE Pipe*	3/4" Female Iron Pipe Threads	34.0	519.65
YLHC267-233-NL	3/4" Pack Joint for PE Pipe*	3/4" Pack Joint for PVC/IPS PE Pipe	39.0	508.44
YLHC267-243-NL	1" Pack Joint for PE Pipe*	3/4" Pack Joint for PVC/IPS PE Pipe	39.0	551.34

ANGLE KEY VALVE INLET - ANGLE OUTLET

CATALOG NUMBER	DESCRIPTION		APPROX. WT. LBS.	LIST PRICE
	INLET	OUTLET		
YL322-233-NL	3/4" Flare Copper	3/4" Flare Copper	36.0	\$ 367.98
▶♦ YL342-233-NL	3/4" Pack Joint for Copper or Plastic Tubing (CTS)*	3/4" Flare Copper	35.0	369.94
▶ YL344-233-NL	3/4" Pack Joint for Copper or Plastic Tubing (CTS)*	3/4" Pack Joint for Copper or Plastic Tubing (CTS)*	35.0	376.39

NOTE: Ford Pack, Quick and Grip Joint compression connections, when used on copper, are designed for Type K or Type L copper only.

Ordering Information

Plastic lid option: Insert "-P" into the catalog number for locking plastic lid **no additional charge**
 Example: YLxxx-xxx-P-NL
 Insert "-PB" into the catalog number for locking plastic lid with ERT bracket, add to price **\$ 7.86**
 Example: YLxxx-xxx-PB-NL
 Insert "-PLB" into the catalog number for locking plastic lid with large ERT bracket, add to price **\$ 30.84**
 Example: YLxxx-xxx-PLB-NL

* **Grip Joint** for CTS and PEP (3/4" and 1") can be ordered by inserting "-G" into the catalog number. Example: YL241-233-G-NL

♦ **Quick Joint** is available. Insert "-Q" into the catalog number. Example: YLHC241-233-Q-NL

▶ **Ultra-Tite** is available. Insert "-U-NA" into the catalog number (shipped unassembled). Contact factory for pricing and availability.
 Example: YL242-233-U-NA-NL

Special expansion connection options are available. See page 22.

Ford Yokeboxes have a locking iron lid as standard. An optional lockless iron lid can be ordered by inserting "-LL" into the catalog number.

Example: YL221-233-LL-NL

Add "**JP**" to the end of the alpha code and insert "**-P**" into the catalog number on a YL Yokebox requiring a plastic enlarged upper section and plastic lid. Example: YL**JP**xxx-xxx-P-NL. Deduct from price..... **\$ -15.54**

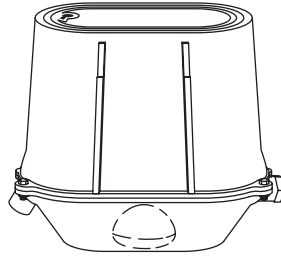
YOKEBOXES FOR 5/8" X 3/4" METER (CONTINUED)*Deep Type (center line of meter 10" below grade)***STRAIGHT BALL VALVE INLET - STRAIGHT OUTLET**

CATALOG NUMBER	DESCRIPTION		APPROX. WT. LBS.	LIST PRICE
	INLET	OUTLET		
YMB111-233-NL	3/4" Female Iron Pipe Threads	3/4" Female Iron Pipe Threads	33.2	\$ 420.13
YMB122-233-NL	3/4" Flare Copper	3/4" Flare Copper	35.0	425.07
► YMB141-233-NL	3/4" Pack Joint for Copper or Plastic Tubing (CTS)*	3/4" Female Iron Pipe Threads	33.6	436.78
► YMB144-233-NL	3/4" Pack Joint for Copper or Plastic Tubing (CTS)*	3/4" Pack Joint for Copper or Plastic Tubing (CTS)*	35.0	452.50
YMB171-233-NL	3/4" Pack Joint for PVC/IPS PE	3/4" Female Iron Pipe Threads	35.0	466.54
YMB177-233-NL	3/4" Pack Joint for PVC/IPS PE	3/4" Pack Joint for PVC/IPS PE	35.0	494.42

STRAIGHT KEY VALVE INLET - STRAIGHT OUTLET

CATALOG NUMBER	DESCRIPTION		APPROX. WT. LBS.	LIST PRICE
	INLET	OUTLET		
YM111-233-NL	3/4" Double Purpose**	3/4" Female Iron Pipe Threads	34.3	\$ 396.38
YM112-233-NL	3/4" Double Purpose**	3/4" Flare Copper	36.0	405.69
► YM141-233-NL	3/4" Pack Joint for Copper or Plastic Tubing (CTS)*	3/4" Female Iron Pipe Threads	33.9	399.15
► YM141-243-NL	1" Pack Joint for Copper or Plastic Tubing (CTS)*	3/4" Female Iron Pipe Threads	34.1	416.83
► YM144-233-NL	3/4" Pack Joint for Copper or Plastic Tubing (CTS)*	3/4" Pack Joint for Copper or Plastic Tubing (CTS)*	36.0	414.89
► YM161-233-NL	3/4" Pack Joint for PE Pipe*	3/4" Female Iron Pipe Threads	34.1	416.83
► YM164-233-NL	3/4" Pack Joint for PE Pipe*	3/4" Pack Joint for Copper or Plastic Tubing (CTS)*	36.0	432.73
YM171-233-NL	3/4" Pack Joint for PVC/IPS PE Pipe	3/4" Female Iron Pipe Threads	36.0	416.83
YM177-233-NL	3/4" Pack Joint for PVC/IPS PE Pipe	3/4" Pack Joint for PVC/IPS PE Pipe	34.6	442.82

STRAIGHT BALL VALVE INLET - STRAIGHT DUAL CHECK OUTLET

CATALOG NUMBER	DESCRIPTION		APPROX. WT. LBS.	LIST PRICE
	INLET	OUTLET		
YMBHC111-233-NL	3/4" Female Iron Pipe Threads	3/4" Female Iron Pipe Threads	36.0	\$ 509.86
YMBHC122-233-NL	3/4" Flare Copper	3/4" Flare Copper	36.0	514.72
► YMBHC141-233-NL	3/4" Pack Joint for Copper or Plastic Tubing (CTS)*	3/4" Female Iron Pipe Threads	35.8	526.45
► YMBHC144-233-NL	3/4" Pack Joint for Copper or Plastic Tubing (CTS)*	3/4" Pack Joint for Copper or Plastic Tubing (CTS)*	36.0	538.88
YMBHC147-233-NL	3/4" Pack Joint for Copper or Plastic Tubing (CTS)*	3/4" Pack Joint for PVC/IPS PE Pipe	36.0	558.81
YMBHC171-233-NL	3/4" Pack Joint for PVC/IPS PE Pipe	3/4" Female Iron Pipe Threads	36.0	556.18
YMBHC177-233-NL	3/4" Pack Joint for PVC/IPS PE Pipe	3/4" Pack Joint for PVC/IPS PE Pipe	36.3	588.50

STRAIGHT KEY VALVE INLET - STRAIGHT DUAL CHECK OUTLET

CATALOG NUMBER	DESCRIPTION		APPROX. WT. LBS.	LIST PRICE
	INLET	DUAL CHECK OUTLET		
YMH141-233-NL	3/4" Pack Joint for Copper or Plastic Tubing (CTS)*	3/4" Female Iron Pipe Threads	40.0	\$ 501.68

NOTE: Ford Pack Joints for PVC are recommended for Schedule 40 and Schedule 80 pipe and IPS PE DR9 and DR11.

NOTE: Ford Pack, Quick and Grip Joint compression connections, when used on copper, are designed for Type K or Type L copper only.

Ordering Information

Plastic lid option: Insert "-P" into the catalog number for locking plastic lid.....no additional charge
 Example: YMxxx-xxx-P-NL
 Insert "-PB" into the catalog number for locking plastic lid with ERT bracket, add to price..... \$ 7.86
 Example: YMxxx-xxx-PB-NL
 Insert "-PLB" into the catalog number for locking plastic lid with large ERT bracket, add to price \$ 30.84
 Example: YMxxx-xxx-PLB-NL

* **Grip Joint** for CTS and PEP (3/4" and 1") can be ordered by inserting "-G" into the catalog number. Example: YMB141-233-G-NL

► **Ultra-Tite** is available. Insert "-U-NA" into the catalog number (shipped unassembled). Contact factory for pricing and availability.
 Example: YMB141-233-U-NA-NL

** **The double purpose coupling** connects to either 3/4" threaded iron pipe or 3/4" flared copper tubing.

Special expansion connection options are available. See page 22.

Ford Yokeboxes have a locking iron lid as standard. An optional lockless iron lid can be ordered by inserting "-LL" into the catalog number.

Example: YMB144-233-LL-NL

Add "**JP**" to the end of the alpha code and insert "**-P**" into the catalog number on a YM Yokebox requiring a plastic enlarged upper section and plastic lid. Example: YMB**JP**xxx-xxx-P-NL. Deduct from price \$ -23.81

YOKEBOXES FOR 5/8" X 3/4" METER (CONTINUED)**Deep Type (center line of meter 10" below grade)****ANGLE KEY VALVE INLET - STRAIGHT OUTLET**

CATALOG NUMBER	DESCRIPTION		APPROX. WT. LBS.	LIST PRICE
	INLET	OUTLET		
YM221-233-NL	3/4" Flare Copper	3/4" Female Iron Pipe Threads	36.0	\$ 379.81
YM222-233-NL	3/4" Flare Copper	3/4" Flare Copper	36.0	389.38
►YM241-233-NL	3/4" Pack Joint for Copper or Plastic Tubing (CTS)*	3/4" Female Iron Pipe Threads	33.6	381.73
YM241-243-NL	1" Pack Joint for Copper or Plastic Tubing (CTS)*	3/4" Female Iron Pipe Threads	33.7	395.86
►YM242-233-NL	3/4" Pack Joint for Copper or Plastic Tubing (CTS)*	3/4" Flare Copper	36.0	391.27
►YM244-233-NL	3/4" Pack Joint for Copper or Plastic Tubing (CTS)*	3/4" Pack Joint for Copper or Plastic Tubing (CTS)*	33.8	398.37
►YM261-233-NL	3/4" Pack Joint for PE Pipe*	3/4" Female Iron Pipe Threads	36.0	396.38
YM261-243-NL	1" Pack Joint for PE Pipe*	3/4" Female Iron Pipe Threads	36.0	439.29
►YM262-233-NL	3/4" Pack Joint for PE Pipe*	3/4" Flare Copper	36.0	405.69
YM262-243-NL	1" Pack Joint for PE Pipe*	3/4" Flare Copper	36.0	448.57
►YM264-233-NL	3/4" Pack Joint for PE Pipe*	3/4" Pack Joint for Copper or Plastic Tubing (CTS)*	36.0	412.15
YM264-243-NL	1" Pack Joint for PE Pipe*	3/4" Pack Joint for Copper or Plastic Tubing (CTS)*	36.0	455.04

ANGLE KEY VALVE INLET - STRAIGHT DUAL CHECK OUTLET

CATALOG NUMBER	DESCRIPTION		APPROX. WT. LBS.	LIST PRICE
	INLET	DUAL CHECK OUTLET		
YMH221-233-NL	3/4" Flare Copper	3/4" Female Iron Pipe Threads	40.0	\$ 482.39
YMH222-233-NL	3/4" Flare Copper	3/4" Flare Copper	40.0	491.80
►YMH241-233-NL	3/4" Pack Joint for Copper or Plastic Tubing (CTS)*	3/4" Female Iron Pipe Threads	36.6	484.86
►YMH244-233-NL	3/4" Pack Joint for Copper or Plastic Tubing (CTS)*	3/4" Pack Joint for Copper or Plastic Tubing (CTS)*	40.0	500.77
YMH247-233-NL	3/4" Pack Joint for Copper or Plastic Tubing (CTS)*	3/4" Pack Joint for PVC Pipe	40.0	519.63
►YMH261-233-NL	3/4" Pack Joint for PE Pipe*	3/4" Female Iron Pipe Threads	40.0	498.87
YMH261-243-NL	1" Pack Joint for PE Pipe	3/4" Female Iron Pipe Threads	40.0	541.78
YMH267-233-NL	3/4" Pack Joint for PE Pipe*	3/4" Pack Joint for PVC/IPS PE Pipe	40.0	531.21
YMH267-243-NL	1" Pack Joint for PE Pipe*	3/4" Pack Joint for PVC/IPS PE Pipe	40.0	573.45

ANGLE KEY VALVE INLET - ANGLE OUTLET

CATALOG NUMBER	DESCRIPTION		APPROX. WT. LBS.	LIST PRICE
	INLET	OUTLET		
YM322-233-NL	3/4" Flare Copper	3/4" Flare Copper	36.0	\$ 390.06
►YM342-233-NL	3/4" Pack Joint for Copper or Plastic Tubing (CTS)*	3/4" Flare Copper	36.0	392.71
►YM344-233-NL	3/4" Pack Joint for Copper or Plastic Tubing (CTS)*	3/4" Pack Joint for Copper or Plastic Tubing (CTS)*	36.0	399.14

NOTE: Ford Pack, Quick and Grip Joint compression connections, when used on copper, are designed for Type K or Type L copper only.

Ordering Information

Plastic lid option: Insert "-P" into the catalog number for locking plastic lid.....no additional charge

Example: YMxxx-xxx-P-NL

Insert "-PB" into the catalog number for locking plastic lid with ERT bracket, add to price \$ 7.86

Example: YMxxx-xxx-PB-NL

Insert "-PLB" into the catalog number for locking plastic lid with large ERT bracket, add to price \$ 30.84

Example: YMxxx-xxx-PLB-NL

* **Grip Joint** for CTS and PEP (3/4" and 1") can be ordered by inserting "-G" into the catalog number. Example: YM342-233-G-NL

► **Ultra-Tite** is available. Insert "-U-NA" into the catalog number (shipped unassembled). Contact factory for pricing and availability.

Example: YM342-233-U-NA-NL

Special expansion connection options are available. See page 22.

Ford Yokeboxes have a locking iron lid as standard. An optional lockless iron lid can be ordered by inserting "-LL" into the catalog number.

Example: YM342-233-LL-NL

Add "**JP**" to the end of the alpha code and insert "**-P**" into the catalog number on a YM Yokebox requiring a plastic enlarged upper section and plastic lid. Example: YMBJPxxx-xxx-P-NL. Deduct from price \$ -23.81

OPTIONS AND ACCESSORIES FOR YOKEBOXES

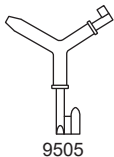
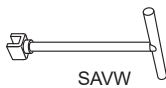

CATALOG NUMBER	DESCRIPTION	LIST PRICE
9501	Grade Adjuster (wt. 8 lb.)	\$ 68.72
YBPR-4	4" Polystyrene Riser with Mounting Hardware	57.24
FYR-8	8" Iron Riser with Mounting Hardware	173.70
PTP	Removable Plastic Plug / Nut for Electronic Meter Reading Lid Hole	11.58
PTP-BR	Removable Plastic Plug for Electronic Meter Reading Lid Hole with ERT Bracket	16.12
PBR-YL-LYL	Plastic ERT Bracket with (3) Stainless Steel Clips (field installation only on plastic lids)	9.68
PLBR-YL-LYL	Plastic Large ERT Bracket with (3) Stainless Steel Clips (field installation only on plastic lids)	32.64
TP	Removable Cast Iron Plug (with cotter pin) for Electronic Meter Reading Module Hole	9.97
SAVV	Ball Valve Yokebox Wrench	20.98
MBVW	Yokebox Valve Wrench	73.33
MBUK	Meter Box Universal Key for Locking Lids, Lockless Lids and Yokebox Valves	60.97
9503	Padlock Plate for Key Valve, Angle or Straight - Lock Open or Closed	4.72
FYBKVLP-AV-SV	Padlock Plate for Angle or Straight Key Valve	13.99
MBLK	Yokebox Lid Key	20.33
9505	Combination Yokebox / Dallas Lid Key	80.13
YEW-1	5/8" Expansion Connection Wrench	20.58
YEW-3	5/8" x 3/4" Expansion Connection Wrench	22.67
9508	Combination Yokebox - Pentagon Bolt Key	102.84
Insert "RL" into Catalog Number	Meter Box Reading Lid (hinged cast iron flap) Instead of Standard Lid, add to price Example: YL241-233-RL-NL	15.71
Insert "P" into Catalog Number	Plastic (ABS) Shallow Type (YL) Upper Section (7") with Anchor Lugs Example: YLP241-233-NL Deduct from Price	-41.96
Insert "PB" into Catalog No.	Locking Plastic Lid with ERT Backet Example: YL241-233-PB-NL	7.86
Add "PLB" to Catalog No.	Locking Plastic Lid with Large ERT Backet	30.84
Insert "PTP" into Catalog Number	Removable Plastic Plug / Nut for Electronic Meter Reading Lid Hole Example: YL241-233-PTP-NL	16.90
Insert "PTP-BR" into Catalog Number	Removable Plastic Plug for Electronic Meter Reading Lid Hole with ERT Bracket Example: YL241-233-PTP-BR-NL	21.45
Insert "T" into Catalog Number	Electronic Meter Read Feature on Lid (2" hole), add to price (see chart on pg. 1) Example: YL241-233-T-NL	5.31
Insert "TP" into Catalog Number	Electronic Meter Read Feature on Lid (2" hole), with Removable Plug, add to price Example: YL241-233-TP-NL	15.30
Insert "RW" into Catalog Number	"Reclaimed Water" Lettering on Locking Yokebox Lid Instead of Standard Lid Example: YL241-233-RW-NL No Charge	0.00
Insert "RWC" into Catalog Number	"Reclaimed Water" Lettering on PURPLE Locking Yokebox Lid Instead of Standard Lid add to price. Example: YL241-233-RWC-NL	28.31
Insert "G" into Catalog No	Grip Joint for CTS and PEP (3/4" and 1") Example: YL241-233-G-NL No Charge	0.00
Insert "P4" into Catalog No	4" Polystyrene Riser Attached Between Base and Upper Section Example: YL241-233-P4-NL	57.24

INSERT INTO THE CATALOG NUMBER	DESCRIPTION	5/8" METER SIZE ADD TO PRICE	5/8" x 3/4" METER SIZE ADD TO PRICE
Insert "XA" into Catalog Number	Locking Expansion Connection without Ford Security Screw Example: YL241-233-XA-NL	\$ 39.03	\$ 44.31
Insert "XB" into Catalog Number	Locking Expansion Connection with Ford Security Screw Example: YL241-233-XB-NL	45.54	50.82
Insert "XC" into Catalog Number	Expansion Connection with Dual Check Valves for Standard Yokeboxes Example: YL241-233-XC-NL	39.53	39.54
Insert "XD" into Catalog Number	Locking Expansion Connection without Ford Security Screw, with Dual Check Valves for Standard Yokeboxes Example: YL241-233-XD-NL	78.59	83.84
Insert "XE" into Catalog Number	Locking Expansion Connection with Ford Security Screw, with Dual Check Valves for Standard Yokeboxes Example: YL241-233-XE-NL	85.09	90.35

EXPANSION CONNECTION OPTIONS FOR 5/8", 5/8" X 3/4", AND 3/4" YOKEBOXES

CATALOG NUMBER	DESCRIPTION	LIST PRICE
EC-1-NL	Expansion Connection for 5/8" Meter	\$ 42.33
EC-1-OR-H2-NL	Expansion Connection for 5/8" Meter, with Dual Check Valves	81.84
ECL-1-NL	Locking Expansion Connection for 5/8" Meter without Security Screw	81.36
ECL-1-SSF-NL	Locking Expansion Connection for 5/8" Meter with Security Screw	87.87
ECL-1-OR-H2-NL	Locking Expansion Connection for 5/8" Meter without Security Screw, with Dual Check Valves	120.92
ECL-1-OR-H2-SSF-NL	Locking Expansion Connection for 5/8" Meter with Security Screw, with Dual Check Valves	127.41
EC-23-NL	Expansion Connection for 5/8" x 3/4" Meter	47.96
EC-23-OR-H2-NL	Expansion Connection for 5/8" x 3/4" Meter, with Dual Check Valves	87.50
ECL-23-NL	Locking Expansion Connection for 5/8" x 3/4" Meter without Security Screw	92.26
ECL-23-SSF-NL	Locking Expansion Connection for 5/8" x 3/4" Meter with Security Screw	98.79
ECL-23-OR-H2-NL	Locking Expansion Connection for 5/8" x 3/4" Meter without Security Screw, with Dual Check Valves	131.78
ECL-23-OR-H2-SSF-NL	Locking Expansion Connection for 5/8" x 3/4" Meter with Security Screw, with Dual Check Valves	138.33
BOLT-800998-SSF	Security Screw (fits all Ford locking expansions)	7.26
KEY-800999-SSF	Security Key / Tip Only for Locking Expansion Connection	83.34
NUT-DR-040072-SSF	Magnetic Nut Driver Less Key / Tip	43.58
EC-1-OR-H2-RK	Check Valve Repair Kit for EC-1-OR-H2-NL	32.36
EC-23-OR-H2-RK	Check Valve Repair Kit for EC-23-OR-H2-NL	32.36
GT-32	5/8" Beveled Expansion Connection Gasket	1.37
GT-33	5/8" x 3/4" Beveled Expansion Connection Gasket	1.67
GT-210	5/8" Flat Expansion Connection Gasket	1.23
GT-196	5/8" x 3/4" Flat Expansion Connection Gasket	1.58

OUTLET PIECES, UPPER SECTIONS, LIDS, AND GASKETS FOR YOKEBOXES

CATALOG NUMBER	DESCRIPTION	LIST PRICE
YL	Iron Locking Lid (Wt. 4.7 lbs.)	\$ 31.18
YL-LUG	Iron Locking Lid with Guide / Alignment Lugs (Wt. 4.9 lbs.)	32.94
YLL	Lockless Iron Lid (Wt. 4.6 lbs.)	31.18
YL-T	Electronic Read Locking Iron Lid with 2" Hole (Wt. 4.7 lbs.)	36.49
YLP	Plastic Standard Yokebox Lid	31.18
YLP-BR	Plastic Standard Yokebox Lid with ERT Bracket	39.05
YLP-LBR	Plastic Standard Yokebox Lid with Large ERT Bracket	61.98
MBRL	Iron Locking Meter Box Reading Lid with Hinged Cast Iron Flap	46.88
YUC-4	Extra Shallow Type (YS) Upper Casting (4") with Anchor Lugs	59.77
YUC-7	Shallow Type (YL) Upper Casting (7") (requires 9500 for installation)	78.30
YUC-7P	Shallow Plastic Type (YL) Upper Section (7") with Anchor Lugs (Wt. 5.1 lbs.)	36.34
YUC-9	Deep Type (YM) Upper Casting (9") (requires 9500 for installation)	96.23
YJLP	Plastic Enlarged Yokebox Lid	39.14
YJLP-BR	Plastic Enlarged Yokebox Lid with ERT Bracket	47.01
YJUC-7P	Plastic Enlarged 7" Upper Section (requires 9500 for installation)	54.82
YJUC-9P	Plastic Enlarged 9" Upper Section (requires 9500 for installation)	64.43
YBSO13-31-NL	Straight Outlet for 5/8" Meter with 3/4" Female Iron Pipe Threads	34.96
YBSO83-31-NL	Straight Outlet for 5/8" Meter with 3/4" Male Iron Pipe Threads	38.20
► YBSO43-31-NL	Straight Outlet for 5/8" Meter with Pack Joint for 3/4" Copper or Plastic Tube (CTS)*	57.59
YBSO23-11-NL	Straight Outlet for 5/8" Meter with 1/2" Flare Copper Connection	43.35
YBSO43-11-NL	Straight Outlet for 5/8" Meter with Pack Joint for 1/2" Copper or Plastic Tube (CTS)	45.52
YBSO23-31-NL	Straight Outlet for 5/8" Meter with 3/4" Flare Copper Connection	48.36
YBSO13-32-NL	Straight Outlet for 5/8" x 3/4" Meter with 3/4" Female Iron Pipe Threads	34.96
YBSO23-32-NL	Straight Outlet for 5/8" x 3/4" Meter with 3/4" Flare Copper Connection	48.36
YBSO83-32-NL	Straight Outlet for 5/8" x 3/4" Meter with 3/4" Male Iron Pipe Threads	38.20
► YBSO43-32-NL	Straight Outlet for 5/8" x 3/4" Meter with Pack Joint for 3/4" Copper or Plastic Tube (CTS)*	57.59
► YBSO43-42-NL	Straight Outlet for 5/8" x 3/4" Meter with Pack Joint for 1" Copper or Plastic Tube (CTS)*	72.01
YBSO73-32-NL	Straight Outlet for 5/8" x 3/4" Meter with Pack Joint for 3/4" PVC/IPS PE	72.01
► YBSO63-32-NL	Straight Outlet for 5/8" x 3/4" Meter with Pack Joint for 3/4" PE Pipe*	72.01
YBAO23-31-NL	Angle Outlet for 5/8" Meter with 3/4" Flare Copper Connection	49.56
YBAO23-32-NL	Angle Outlet for 5/8" x 3/4" Meter with 3/4" Flare Copper Connection	49.56
► YBAO43-32-NL	Angle Outlet for 5/8" x 3/4" Meter with Pack Joint for 3/4" Copper or Plastic Tube (CTS)*	58.81
GT-112	5/8" Rubber Gasket for Valve and Outlet Saddles	0.49
GT-118	5/8" x 3/4" Rubber Gasket for Valve and Outlet Saddles	0.65
9500	Stainless Steel Bolt and Nut for Connecting Upper and Base Castings (4 required)	1.34 ea
9510	Lock Assembly (bolt, spring and rivet)	10.57
BOLT-800122	Stainless Steel Self Tapping Screw for Yokebox Brass Inlet and Outlet Items (2 required)	1.64 ea

INLET VALVES AND BASES FOR KEY VALVE YOKEBOXES

YBC	Base (or bottom) Casting for Yokeboxes without a Cartridge Check Valve (Wt. 11.1 lbs.)	51.97
YBAV23-31-NL	Angle Valve for 5/8" Meter, Inlet for 3/4" Flared Copper	109.38
► YBAV43-31-NL	Angle Valve for 5/8" Meter, Inlet Pack Joint for 3/4" Copper or Plastic Tube (CTS)*	112.89
YBAV43-42-NL	Angle Valve for 5/8" x 3/4" Meter, Inlet Pack Joint for 1" Copper or Plastic Tube (CTS)*	132.61
YBAV23-32-NL	Angle Valve for 5/8" x 3/4" Meter, Inlet for 3/4" Flared Copper	109.38
► YBAV43-32-NL	Angle Valve for 5/8" x 3/4" Meter, Inlet Pack Joint for 3/4" Copper or Plastic Tube (CTS)*	112.89
YBAV43-32-Q-NL	Angle Valve for 5/8" x 3/4" Meter, Inlet Quick Joint for 3/4" Copper or Plastic Tube (CTS)	112.89
► YBAV63-32-NL	Angle Valve for 5/8" x 3/4" Meter, Inlet Pack Joint for 3/4" PE Pipe*	132.61
YBAV63-42-NL	Angle Valve for 5/8" x 3/4" Meter, Inlet for 1" PE Pipe*	189.60
YBSV23-11-NL	Straight Valve for 5/8" Meter, Inlet for 1/2" Flared Copper	121.02
YBSV43-11-NL	Straight Valve for 5/8" Meter, Inlet Pack Joint for 1/2" Copper or Plastic Tube (CTS)	123.17
YBSV13-31-NL	Straight Valve for 5/8" Meter, 3/4" Double Purpose Coupling Inlet	132.99
► YBSV43-31-NL	Straight Valve for 5/8" Meter, Inlet Pack Joint for 3/4" Copper or Plastic Tube (CTS)*	136.70
YBSV13-32-NL	Straight Valve for 5/8" x 3/4" Meter, 3/4" Double Purpose Coupling Inlet	132.99
YBSV23-32-NL	Straight Valve for 5/8" x 3/4" Meter, Inlet for 3/4" Flared Copper	132.71
► YBSV43-32-NL	Straight Valve for 5/8" x 3/4" Meter, Inlet Pack Joint for 3/4" Copper or Plastic Tube (CTS)*	136.70
► YBSV43-42-NL	Straight Valve for 5/8" x 3/4" Meter, Inlet Pack Joint for 1" Copper or Plastic Tube (CTS)*	162.08
► YBSV63-32-NL	Straight Valve for 5/8" x 3/4" Meter, Inlet Pack Joint for 3/4" PE Pipe*	162.08
YBSV73-32-NL	Straight Valve for 5/8" x 3/4" Meter, Inlet Pack Joint for 3/4" PVC/IPS PE Pipe	162.08
YBSV83-32-NL	Straight Valve for 5/8" x 3/4" Meter, Inlet for 3/4" Male Iron Pipe Threads	132.71

INLET VALVES AND BASES FOR BALL VALVE YOKEBOXES

** YBC-BV	Base (or Bottom) Casting for Ball Valve Yokebox	70.58
** YBC-BVHC	Base (or Bottom) Casting for Ball Valve Dual Check Valve Yokebox	78.86
YBBV13-231-NL	5/8" YB Ball Valve for 3/4" Female Iron Pipe	170.45
YBBV13-232-NL	5/8" x 3/4" YB Ball Valve 3/4" Female Iron Pipe	170.45
YBBV13-242-NL	5/8" x 3/4" YB Ball Valve for 1" Female Iron Pipe	188.36
YBBV23-231-NL	5/8" YB Ball Valve for 3/4" Flare Copper	192.34
YBBV23-232-NL	5/8" x 3/4" YB Ball Valve 3/4" Flare Copper	192.34
► YBBV43-231-NL	5/8" YB Ball Valve for 3/4" CTS*	195.52
◆► YBBV43-232-NL	5/8" x 3/4" YB Ball Valve 3/4" CTS*	195.52
YBBV43-241-NL	5/8" YB Ball Valve for 1" CTS*	230.70
► YBBV43-242-NL	5/8" x 3/4" YB Ball Valve for 1" CTS*	230.70
YBBV63-232-NL	Straight 5/8" x 3/4" YB Ball Valve for 3/4" PE Pipe*	230.70
YBBV73-232-NL	5/8" x 3/4" YB Ball Valve for 3/4" PVC/IPS PE	230.70

NOTE: Ford Pack, Quick and Grip Joint compression connections, when used on copper, are designed for Type K or Type L copper only.

◆ **Quick Joint** is available. Insert "-Q" into the catalog number. Example: YBBV43-232-Q-NL

NOTE: Installation screws are included with Yokebox valves and outlet pieces.

* **Grip Joint** can be ordered by inserting "-G" into the catalog number. Example: YBSO43-31-G-NL

► **Ultra-Tite** is available. Insert "-U-NA" into the catalog number (shipped unassembled). Contact factory for pricing and availability. Example: YBSO43-31-U-NA-NL

** Contact factory for pricing and availability.

CHECK VALVES AND BASE FOR DUAL CHECK YOKEBOXES

CATALOG NUMBER	DESCRIPTION	LIST PRICE
** YBC-HC	Base Casting for Dual Check Yokebox	\$ 70.58
** YBC-BVHC	Base Casting for Ball Valve Dual Check Yokebox	78.86
YBHC31-313-NL	5/8" Yokebox Dual Check for 3/4" Female Iron Pipe Thread	147.59
YBHC31-323-NL	5/8" x 3/4" Yokebox Dual Check for 3/4" Female Iron Pipe Thread	147.59
YBHC31-324-NL	5/8" x 3/4" Yokebox Dual Check for 1" Female Iron Pipe Thread	163.95
YBHC32-313-NL	5/8" Yokebox Dual Check for 3/4" Flare Copper	161.09
YBHC32-323-NL	5/8" x 3/4" Yokebox Dual Check for 3/4" Flare Copper	161.09
► YBHC34-313-NL	5/8" Yokebox Dual Check for 3/4" Pack Joint for Copper or Plastic Tube (CTS)*	165.46
► YBHC34-323-NL	5/8" x 3/4" Yokebox Dual Check for 3/4" Pack Joint for Copper or Plastic Tube (CTS)*	165.46
YBHC37-323-NL	5/8" x 3/4" Yokebox Dual Check for 3/4" Pack Joint for PVC*/IPS PE	190.53

NOTE: Ford Pack, Quick and Grip Joint compression connections, when used on copper, are designed for Type K or Type L copper only.

* **Grip Joint** can be ordered by inserting "-G" into the catalog number. Example: YBHC34-313-G-NL

► Ultra-Tite is available. Insert "-U-NA" into the catalog number (shipped unassembled). Contact factory for pricing and availability.

Example: YBHC34-313-U-NA-NL

** Contact factory for pricing and availability.

GOLDEN GATE BOX FOR 3/4" METERS

CATALOG NUMBER	DESCRIPTION		APPROX. WT. LBS.	LIST PRICE
	INLET	OUTLET		
YL221-344-NL	1" Flare Copper	1" Female Iron Pipe Threads	37.0	\$ 441.72
► YL224-344-NL	1" Flare Copper	1" Pack Joint for Copper or Plastic Tubing (CTS)*	37.0	450.90
► YL241-344-NL	1" Pack Joint for Copper or Plastic Tubing (CTS)*	1" Female Iron Pipe Threads	37.0	447.21
► YL244-344-NL	1" Pack Joint for Copper or Plastic Tubing (CTS)*	1" Pack Joint for Copper or Plastic Tubing (CTS)*	37.0	456.35

NOTE: Ford Pack, Quick and Grip Joint compression connections, when used on copper, are designed for Type K or Type L copper only.

OPTION NOTE: All lid and riser options listed on pages 22 and 23 are available for the Golden Gate Box.

► Ultra-Tite is available. Insert "-U-NA" into the catalog number (shipped unassembled). Contact factory for pricing and availability.

Example: YL224-344-U-NA-NL

Options: Insert "-P" into the catalog number for locking plastic lid. Example: YLxxx-xxx-P-NL..... **no additional charge**

Insert "-PB" into the catalog number for locking plastic lid with ERT bracket, add to price. Example: YLxxx-xxx-PB-NL..... **\$ 7.86**

Insert "-PLB" into the catalog number for locking plastic lid with large ERT bracket, add to price. Example: YLxxx-xxx-PLB-NL..... **\$ 30.84**

Add "**JP**" to the end of the alpha code of the catalog number on a YL Yokebox requiring a plastic enlarged upper

section and plastic lid. Example: YL**JP**xxx-xxx-NL. Deduct from price..... **\$ -15.54**

PARTS AND ACCESSORIES FOR GOLDEN GATE BOXES

CATALOG NUMBER	DESCRIPTION	APPROX. WT. LBS.	LIST PRICE
EC-23-SF-NL	2-Part Expansion Connection	0.6	\$ 61.42
GGAV23-343-NL	Inlet Valve for 1" Flare Copper	2.0	134.78
► GGAV43-343-NL	Inlet Valve for 1" Pack Joint (CTS)*	1.6	141.70
GGO13-343-NL	Straight Outlet for 1" Female Iron Pipe	0.8	55.77
► GGO43-343-NL	Straight Outlet for 1" Pack Joint (CTS)*	1.0	68.44
MBVW	Meter Box Valve Wrench (18" long)	1.9	73.33
MBLK	Meter Box Lid Key	0.3	20.33
9505	Combination Yokebox / Dallas Lid Key	0.8	80.13

* **Grip Joint** for CTS can be ordered by inserting "-G" into the catalog number. Example: GGAV43-343-G-NL

► Ultra-Tite is available. Insert "-U-NA" into the catalog number (shipped unassembled). Contact factory for pricing and availability.

Example: GGAV43-343-U-NA-NL

YOKEBOX FOR 1" METER

CATALOG NUMBER	DESCRIPTION		APPROX. WT. LBS.	LIST PRICE
	INLET	OUTLET		
YL111-444-NL	1" Female Iron Pipe	1" Female Iron Pipe	65.3	\$ 791.50

Ford Yokeboxes have a locking iron lid as standard. An optional lockless iron lid can be ordered by inserting "-LL" into the catalog number.

Plastic lid option: Insert "-P" into the catalog number for locking plastic lid. Example: YLxxx-xxx-P-NL..... **no additional charge**

Insert "-PB" into the catalog number for locking plastic lid with ERT bracket, add to price. Example: YLxxx-xxx-PB-NL ... **\$ 7.86**

PARTS AND ACCESSORIES FOR YOKEBOX FOR 1" METER

CATALOG NUMBER	DESCRIPTION	APPROX. WT. LBS.	LIST PRICE
MBVW	Meter Box Valve Wrench (18" long)	1.9	\$ 73.33
MBLK	Meter Box Lid Key	0.3	20.33
9505	Combination Yokebox / Dallas Lid Key	0.8	80.13
YBUC	Upper Casting for YL111-444-NL	26.2	157.49
9635	Base Casting for YL111-444-NL	21.0	151.36
CBLL	Iron Lockless Lid for YL111-444-NL	10.4	53.96
CBLL-T	Iron Lockless Lid with 2" Hole for Electronic Read Module for YL111-444-NL	10.3	59.29
YBL	Locking Iron Lid for YL111-444-NL	10.9	53.96
YBL-T	Electronic Read Locking Iron Lid for YL111-444-NL (2" hole)	10.6	59.29
YBLP	1" Yokebox Plastic Locking Lid	2.4	53.96
YBLP-C-T	1" Yokebox Plastic Locking E-Read Lid with Center Hole	2.5	71.13
YBLP-BR	1" Yokebox Plastic Locking Lid with ERT Bracket	2.6	61.83
CBEO-4-NL	Yokebox Expansion Outlet, 1" Female Iron Pipe	2.9	209.39
CBV-4-NL	Yokebox Valve, 1" Female Iron Pipe Inlet	3.5	239.82
GT-123	Flat Rubber Gaskets for Inlet and Outlet Pieces	-	0.75
9504	Bolt and Nut for YL111-444-NL	-	6.91
PTP	Removable Plastic Plug / Nut for Electronic Meter Reading Lid Hole	-	11.58
PTP-BR	Removable Plastic Plug for Electronic Meter Reading Lid Hole with ERT Bracket	0.1	16.12
TP	Removable Cast Iron Plug (with cotter pin) for Electronic Meter Reading Module Hole	0.5	9.97
CBBV13-344-NL	Crescent Box Ball Valve 1" Female Iron Pipe Inlet	2.1	168.16
* CBBV43-344-NL	Crescent Box Ball Valve 1" Pack Joint for CTS Inlet	2.5	185.67

GULFBOXES FOR 5/8" METER

CATALOG NUMBER	DESCRIPTION		APPROX. WT. LBS.	LIST PRICE
	INLET	OUTLET		
† G122-111-NA-NL	1/2" Flare Copper	1/2" Flare Copper	28.0	\$ 347.52
G122-133-NL	3/4" Flare Copper	3/4" Flare Copper	25.9	311.69
G128-133-NL	3/4" Flare Copper	3/4" Male Iron Pipe Threads	28.0	300.66
► G144-133-NL	3/4" Pack Joint for Copper or Plastic Tubing (CTS)*	3/4" Pack Joint for Copper or Plastic Tubing (CTS)*	28.0	324.70
► G148-133-NL	3/4" Pack Joint for Copper or Plastic Tubing (CTS)*	3/4" Male Iron Pipe Threads	25.6	308.31
G188-133-NL	3/4" Male Iron Pipe Threads	3/4" Male Iron Pipe Threads	25.3	289.43

* **Grip Joint** can be ordered by inserting "-G" into the catalog number. Example: G144-133-G-NL

† Inlet and outlet couplings are shipped unassembled.

- Ultra-Tite is available. Insert "-U-NA" into the catalog number (shipped unassembled). Contact factory for pricing and availability.

Example: G144-133-U-NA-NL

Plastic lid option: Insert "-P" into the catalog number for locking plastic lid **no additional charge**

Example: Gxxx-xxx-P-NL

Insert "-PB" into the catalog number for locking plastic lid with ERT bracket, add to price

Example: Gxxx-xxx-PB-NL \$ 7.86

Insert "-PLB" into the catalog number for locking plastic lid with large ERT bracket, add to price \$ 30.84

Example: Gxxx-xxx-PLB-NL

Ford Gulfboxes have a locking iron lid as standard. An optional lockless iron lid can be ordered by inserting "-LL" into the catalog number.

C

LONG GULFBOXES FOR 5/8" METER WITH DUAL CHECK

CATALOG NUMBER	DESCRIPTION		APPROX. WT. LBS.	LIST PRICE
	INLET	OUTLET		
GHC122-133-NL	3/4" Flare Copper	3/4" Flare Copper	28.0	\$ 556.41
► GHC144-133-NL	3/4" Pack Joint for Copper or Plastic Tubing (CTS)*	3/4" Pack Joint for Copper or Plastic Tubing (CTS)*	28.0	568.71
► GHC148-133-NL	3/4" Pack Joint for Copper or Plastic Tubing (CTS)*	3/4" Male Iron Pipe Threads	28.0	552.42
GHC188-133-NL	3/4" Male Iron Pipe Threads	3/4" Male Iron Pipe Threads	28.0	534.81

* **Grip Joint** can be ordered by inserting "-G" into the catalog number. Example: GHC144-133-G-NL

- Ultra-Tite is available. Insert "-U-NA" into the catalog number (shipped unassembled). Contact factory for pricing and availability.

Example: GHC144-133-U-NA-NL

GULFBOXES FOR 5/8" X 3/4" METER

CATALOG NUMBER	DESCRIPTION		APPROX. WT. LBS.	LIST PRICE
	INLET	OUTLET		
G122-233-NL	3/4" Flare Copper	3/4" Flare Copper	26.2	\$ 316.62
G128-233-NL	3/4" Flare Copper	3/4" Male Iron Pipe Threads	28.0	305.32
► G144-233-NL	3/4" Pack Joint for Copper or Plastic Tubing (CTS)*	3/4" Pack Joint for Copper or Plastic Tubing (CTS)*	26.1	329.43
► G148-233-NL	3/4" Pack Joint for Copper or Plastic Tubing (CTS)*	3/4" Male Iron Pipe Threads	25.8	311.77
G188-233-NL	3/4" Male Iron Pipe Threads	3/4" Male Iron Pipe Threads	25.6	294.27

* **Grip Joint** can be ordered by inserting "-G" into the catalog number. Example: G144-233-G-NL

- Ultra-Tite is available. Insert "-U-NA" into the catalog number (shipped unassembled). Contact factory for pricing and availability.

Example: G144-233-U-NA-NL

Plastic lid option: Insert "-P" into the catalog number for locking plastic lid **no additional charge**

Example: Gxxx-xxx-P-NL

Insert "-PB" into the catalog number for locking plastic lid with ERT bracket, add to price \$ 7.86

Example: Gxxx-xxx-PB-NL

Ford Gulfboxes have a locking iron lid as standard. An optional lockless iron lid can be ordered by inserting "-LL" into the catalog number.

LONG GULFBOXES FOR 5/8" X 3/4" METER WITH DUAL CHECK

CATALOG NUMBER	DESCRIPTION		APPROX. WT. LBS.	LIST PRICE
	INLET	OUTLET		
GHC122-233-NL	3/4" Flare Copper	3/4" Flare Copper	28.0	\$ 560.56
► GHC144-233-NL	3/4" Pack Joint for Copper or Plastic Tubing (CTS)*	3/4" Pack Joint for Copper or Plastic Tubing (CTS)*	28.0	572.86
► GHC148-233-NL	3/4" Pack Joint for Copper or Plastic Tubing (CTS)*	3/4" Male Iron Pipe Threads	28.0	556.51
GHC188-233-NL	3/4" Male Iron Pipe Threads	3/4" Male Iron Pipe Threads	28.0	538.88

* **Grip Joint** can be ordered by inserting "-G" into the catalog number. Example: GHC144-233-G-NL

- Ultra-Tite is available. Insert "-U-NA" into the catalog number (shipped unassembled). Contact factory for pricing and availability.

Example: GHC144-233-U-NA-NL

Special expansion connections are available. See page 26.

NOTE: Ford Pack, Quick and Grip Joint compression connections, when used on copper, are designed for Type K or Type L copper only.

OPTIONS AND ACCESSORIES FOR GULFBOXES

CATALOG NUMBER	DESCRIPTION	LIST PRICE
9501	Grade Adjuster (shown in catalog)	\$ 68.72
MBVW	Gulfbox Valve Wrench (18" long)	73.33
MBLK	Gulfbox Lid Key	20.33
MBUK	Meter Box Universal Key for Locking Lids, Lockless Lids and Meter Valves	60.97
PTP	Removable Plastic Plug / Nut for Electronic Meter Reading Lid Hole	11.58
PTP-BR	Removable Plastic Plug for Electronic Meter Reading Lid Hole with ERT Bracket	16.12
TP	Removable Cast Iron Plug for Electronic Meter Reading Lid Hole (includes cotter pin)	9.97
Insert "-RL" into Catalog Number	Meter Box Reading Lid (hinged cast iron flap) Instead of Standard Lid, insert into price Example: G122-233-RL-NL	15.71
Insert "-P" into Catalog Number	Plastic Locking Lid Example: G122-233-P-NL No Charge	0.00
Insert "-PB" into Catalog Number	Locking Plastic Lid with ERT Bracket Example: G122-233-PB-NL	7.86
Insert "-PTP" into Catalog Number	Removable Plastic Plug / Nut for Electronic Meter Reading Lid Hole Example: G122-233-PTP-NL	16.90
Insert "-PTP-BR" into Catalog Number	Removable Plastic Plug for Electronic Meter Reading Lid Hole with ERT Bracket Example: G122-233-PTP-BR-NL	21.45
Insert "-T" into Catalog Number	Electronic Read Iron Lid (2" hole) insert into price (see chart on page 1) Example: G122-233-T-NL	5.31
Insert "-TP" into Catalog Number	Electronic Read Iron Lid (2" hole), with Removable Plug, insert into price Example: G122-233-TP-NL	15.30
Insert "-RW" into Catalog Number	"Reclaimed Water" Lettering on Locking Yokebox Iron Lid Example: G122-233-RW-NL No Charge	0.00
Insert "-RWC" into Catalog Number	"Reclaimed Water" Lettering on PURPLE Locking Yokebox Iron Lid, insert into price Example: G122-233-RWC-NL	28.31
Insert "-G" into Catalog Number	Grip Joint for CTS (3/4" and 1") Example: G144-233-G-NL No Charge	0.00

INSERT INTO THE CATALOG NUMBER	DESCRIPTION	5/8" METER SIZE INSERT INTO PRICE	5/8" x 3/4" METER SIZE INSERT INTO PRICE
Insert "-XA" into Catalog Number	Locking Expansion Connection without Ford Security Screw Example: G122-233-XA-NL	\$ 39.03	\$ 44.31
Insert "-XB" into Catalog Number	Locking Expansion Connection with Ford Security Screw Example: G122-233-XB-NL	45.54	50.82
Insert "-XC" into Catalog Number	Expansion Connection with Dual Check Valves for Standard Gulfboxes Example: G122-233-XC-NL	39.53	39.54
Insert "-XD" into Catalog Number	Locking Expansion Connection without Ford Security Screw, with Dual Check Valves for Standard Gulfboxes Example: G122-233-XD-NL	78.59	83.84
Insert "-XE" into Catalog Number	Locking Expansion Connection with Ford Security Screw, with Dual Check Valves for Standard Gulfboxes Example: G122-233-XE-NL	85.09	90.35

GULFBOX PARTS

CATALOG NUMBER	DESCRIPTION	LIST PRICE
YL	Iron Locking Lid	\$ 31.18
YLP	Plastic Locking Lid (Wt. 4.7 lbs.)	31.18
YLP-BR	Plastic Locking Lid with ERT Bracket	39.05
YL-LUG	Iron Locking Lid with Guide Lugs	32.94
YL-T	Iron Locking Electronic Read Lid (2" hole) (Wt. 4.7 lbs.)	36.49
MBRL	Iron Locking Electronic Read Lid with Hinged Cast Iron Flap (Wt. 4.7 lbs.)	46.88
YLL	Iron Lockless Lid	31.18
GBIB	Iron Body Casting (Wt. 4.6 lbs.)	82.53
GBO23-31-NL	Outlet for 5/8" Meter with 3/4" Flared Copper Connection	43.78
GBO23-32-NL	Outlet for 5/8" x 3/4" Meter with 3/4" Flared Copper Connection	43.78
► GBO43-31-NL	Outlet for 5/8" Meter with Pack Joint Connection for 3/4" Copper or Plastic Tube (CTS)*	52.60
► GBO43-32-NL	Outlet for 5/8" x 3/4" Meter with Pack Joint Connection for 3/4" Copper or Plastic Tube (CTS)*	52.60
GBO83-31-NL	Outlet for 5/8" Meter with 3/4" Male Iron Pipe Threads	27.98
GBO83-32-NL	Outlet for 5/8" x 3/4" Meter with 3/4" Male Iron Pipe Threads	27.98
GBV23-31-NL	Ball Valve for 5/8" Meter with Inlet for 3/4" Flared Copper	118.20
GBV23-32-NL	Ball Valve for 5/8" x 3/4" Meter with Inlet for 3/4" Flared Copper	118.20
GBV23-32W-NL	Ball Valve for 5/8" x 3/4" Meter with Inlet for 3/4" Flared Copper	123.22
► GBV43-31-NL	Ball Valve for 5/8" Meter with Pack Joint Inlet for 3/4" Copper or Plastic Tube (CTS)*	127.54
► GBV43-32-NL	Ball Valve for 5/8" x 3/4" Meter with Pack Joint Inlet for 3/4" Copper or Plastic Tube (CTS)*	127.54
GBV43-32W-NL	Ball Valve for 5/8" x 3/4" Meter with Pack Joint Inlet for 3/4" Copper or Plastic Tube (CTS)*	132.61
GBV83-31-NL	Ball Valve for 5/8" Meter with 3/4" Male Iron Pipe Thread Inlet	102.47
GBV83-32-NL	Ball Valve for 5/8" x 3/4" Meter with 3/4" Male Iron Pipe Thread Inlet	102.47
GBV83-32W-NL	Ball Valve for 5/8" x 3/4" Meter with 3/4" Male Iron Pipe Thread Inlet	107.49
EC-1-NL	Expansion Connection for 5/8" Meter	42.33
EC-1-OR-H2-NL	Expansion Connection for 5/8" Meter, with Dual Check Valves	81.84
ECL-1-NL	Locking Expansion Connection for 5/8" Meter without Security Screw	81.36
ECL-1-SSF-NL	Locking Expansion Connection for 5/8" Meter with Security Screw	87.87
ECL-1-OR-H2-NL	Locking Expansion Connection for 5/8" Meter without Security Screw, with Dual Check Valves	120.92
ECL-1-OR-H2-SSF-NL	Locking Expansion Connection for 5/8" Meter with Security Screw, with Dual Check Valves	127.41
EC-23-NL	Expansion Connection for 5/8" x 3/4" Meter	47.96
EC-23-OR-H2-NL	Expansion Connection for 5/8" x 3/4" Meter, with Dual Check Valves	87.50
ECL-23-NL	Locking Expansion Connection for 5/8" x 3/4" Meter without Security Screw	92.26
ECL-23-SSF-NL	Locking Expansion Connection for 5/8" x 3/4" Meter with Security Screw	98.79
ECL-23-OR-H2-NL	Locking Expansion Connection for 5/8" x 3/4" Meter without Security Screw, with Dual Check Valves	131.78
ECL-23-OR-H2-SSF-NL	Locking Expansion Connection for 5/8" x 3/4" Meter with Security Screw, with Dual Check Valves	138.33
BOLT-800998-SSF	Security Screw (fits all Ford locking expansions)	7.26
KEY-800999-SSF	Security Key / Tip Only for Locking Expansion Connection	83.34
NUT-DR-040072-SSF	Magnetic Nut Driver Less Key / Tip	43.58
EC-1-OR-H2-RK	Check Valve Repair Kit for EC-1-OR-H2-NL	32.36
EC-23-OR-H2-RK	Check Valve Repair Kit for EC-23-OR-H2-NL	32.36
GT-32	5/8" Beveled Expansion Connection Gasket	1.37
GT-33	5/8" x 3/4" Beveled Expansion Connection Gasket	1.67
GT-210	5/8" Flat Expansion Connection Gasket	1.23
GT-196	5/8" x 3/4" Flat Expansion Connection Gasket	1.58
GT-112	5/8" Rubber Gaskets for Valve and Outlet Saddles	0.49
GT-118	5/8" x 3/4" Rubber Gaskets for Valve and Outlet Saddles	0.65

* **Grip Joint** can be ordered by adding "-G" to the end of the catalog number.

► Ultra-Tite is available. Insert "-U-NA" into the catalog number (shipped unassembled). Contact factory for pricing and availability.

NOTE: Ford Pack, Quick and Grip Joint compression connections, when used on copper, are designed for Type K or Type L copper only.

LONG GULFBOX PARTS

CATALOG NUMBER	DESCRIPTION	LIST PRICE
GBOL23-31-NL	Long Gulfbox Outlet for 5/8" Meter with 3/4" Flared Copper Connection	46.92
GBOL23-32-NL	Long Gulfbox Outlet for 5/8" x 3/4" Meter with 3/4" Flared Copper Connection	46.92
► GBOL43-31-NL	Long Gulfbox Outlet for 5/8" Meter with P.J. Connection for 3/4" Copper or Plastic Tube (CTS)*	55.68
► GBOL43-32-NL	Long Gulfbox Outlet for 5/8" x 3/4" Meter with P.J. Connection for 3/4" Copper or Plastic Tube (CTS)*	55.68
GBOL83-31-NL	Long Gulfbox Outlet for 5/8" Meter with 3/4" Male Iron Pipe Threads	31.01
GBOL83-32-NL	Long Gulfbox Outlet for 5/8" x 3/4" Meter with 3/4" Male Iron Pipe Threads	31.01
HHCI33-311-NL	3/4" Cartridge Style Dual Check for 5/8" Meter	141.10
HHCI33-322-NL	3/4" Cartridge Style Dual Check for 5/8" x 3/4" Meter	141.10

NOTE: Expansion connections and gaskets are listed under Gulfbox Parts on page C-26.

NOTE: Ford Pack, Quick and Grip Joint compression connections, when used on copper, are designed for Type K or Type L copper only.

* **Grip Joint** can be ordered by inserting "-G" into the catalog number. Example: GBOL43-31-G-NL

► Ultra-Tite is available. Insert "-U-NA" into the catalog number (shipped unassembled). Contact factory for pricing and availability.
Example: GBOL43-31-U-NA-NL

C

DOUBLE GULFBOXES FOR 5/8" METERS

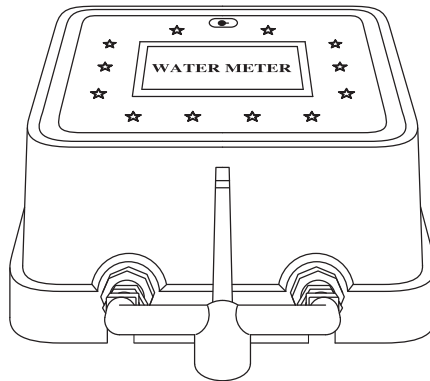

STRAIGHT INLET - STRAIGHT OUTLET

CATALOG NUMBER	DESCRIPTION		APPROX. WT. LBS.	LIST PRICE
	INLET	BOTH OUTLETS		
DG112-143-NL	1" Female Iron Pipe	3/4" Flare Copper	42.0	\$ 680.99
► DG114-143-NL	1" Female Iron Pipe	3/4" Pack Joint for Copper or Plastic Tubing (CTS)*	42.0	693.48
DG118-143-NL	1" Female Iron Pipe	3/4" Male Iron Pipe	42.6	658.67
DG122-143-NL	1" Flare Copper	3/4" Flare Copper	42.0	700.77
► DG124-143-NL	1" Flare Copper	3/4" Pack Joint for Copper or Plastic Tubing (CTS)*	42.0	713.50
DG128-143-NL	1" Flare Copper	3/4" Male Iron Pipe	42.0	678.30
► DG142-143-NL	1" Pack Joint for Copper or Plastic Tubing (CTS)*	3/4" Flare Copper	42.0	711.94
► DG144-143-NL	1" Pack Joint for Copper or Plastic Tubing (CTS)*	3/4" Pack Joint for Copper or Plastic Tubing (CTS)*	43.3	724.98
► DG148-143-NL	1" Pack Joint for Copper or Plastic Tubing (CTS)*	3/4" Male Iron Pipe	43.8	689.82

NOTE: Ford Pack, Quick and Grip Joint compression connections, when used on copper, are designed for Type K or Type L copper only.

* **Grip Joint** can be ordered by inserting "-G" into the catalog number. Example: DG114-143-G-NL

► Ultra-Tite is available. Insert "-U-NA" into the catalog number (shipped unassembled). Contact factory for pricing and availability.
Example: DG114-143-U-NA-NL

DOUBLE GULFBOXES FOR 5/8" METERS (CONTINUED)

ANGLE INLET - STRAIGHT OUTLET

CATALOG NUMBER	DESCRIPTION		APPROX. WT. LBS.	LIST PRICE
	INLET	BOTH OUTLETS		
DG212-143-NL	1" Female Iron Pipe	3/4" Flare Copper	42.0	\$ 710.32
► DG214-143-NL	1" Female Iron Pipe	3/4" Pack Joint for Copper or Plastic Tubing (CTS)*	42.0	722.97
DG218-143-NL	1" Female Iron Pipe	3/4" Male Iron Pipe	42.0	687.99
DG222-143-NL	1" Flare Copper	3/4" Flare Copper	42.0	719.39
► DG224-143-NL	1" Flare Copper	3/4" Pack Joint for Copper or Plastic Tubing (CTS)*	42.0	732.07
DG228-143-NL	1" Flare Copper	3/4" Male Iron Pipe	42.0	696.99
► DG242-143-NL	1" Pack Joint for Copper or Plastic Tubing (CTS)*	3/4" Flare Copper	42.0	714.61
► DG244-143-NL	1" Pack Joint for Copper or Plastic Tubing (CTS)*	3/4" Pack Joint for Copper or Plastic Tubing (CTS)*	42.0	727.51
► DG248-143-NL	1" Pack Joint for Copper or Plastic Tubing (CTS)*	3/4" Male Iron Pipe	42.0	692.36

NOTE: Ford Pack, Quick and Grip Joint compression connections, when used on copper, are designed for Type K or Type L copper only.

* **Grip Joint** can be ordered by inserting "-G" into the catalog number. Example: DG214-143-G-NL

- Ultra-Tite is available. Insert "-U-NA" into the catalog number (shipped unassembled). Contact factory for pricing and availability.
Example: DG214-143-U-NA-NL

C

DOUBLE GULFBOXES FOR 5/8" X 3/4" METERS

STRAIGHT INLET - STRAIGHT OUTLET

CATALOG NUMBER	DESCRIPTION		APPROX. WT. LBS.	LIST PRICE
	INLET	BOTH OUTLETS		
DG112-243-NL	1" Female Iron Pipe	3/4" Flare Copper	42.0	\$ 690.62
► DG114-243-NL	1" Female Iron Pipe	3/4" Pack Joint for Copper or Plastic Tubing (CTS)*	42.0	703.31
DG118-243-NL	1" Female Iron Pipe	3/4" Male Iron Pipe	43.0	668.13
DG122-243-NL	1" Flare Copper	3/4" Flare Copper	42.0	710.32
► DG124-243-NL	1" Flare Copper	3/4" Pack Joint for Copper or Plastic Tubing (CTS)*	42.0	722.97
DG128-243-NL	1" Flare Copper	3/4" Male Iron Pipe	42.0	687.99
► DG142-243-NL	1" Pack Joint for Copper or Plastic Tubing (CTS)*	3/4" Flare Copper	42.0	721.65
► DG144-243-NL	1" Pack Joint for Copper or Plastic Tubing (CTS)*	3/4" Pack Joint for Copper or Plastic Tubing (CTS)*	43.8	734.40
► DG148-243-NL	1" Pack Joint for Copper or Plastic Tubing (CTS)*	3/4" Male Iron Pipe	43.2	699.15

NOTE: Ford Pack, Quick and Grip Joint compression connections, when used on copper, are designed for Type K or Type L copper only.

* **Grip Joint** can be ordered by inserting "-G" into the catalog number. Example: DG142-243-G-NL

- Ultra-Tite is available. Insert "-U-NA" into the catalog number (shipped unassembled). Contact factory for pricing and availability.
Example: DG142-243-U-NA-NL

ANGLE INLET - STRAIGHT OUTLET

CATALOG NUMBER	DESCRIPTION		APPROX. WT. LBS.	LIST PRICE
	INLET	BOTH OUTLETS		
DG212-243-NL	1" Female Iron Pipe	3/4" Flare Copper	42.0	\$ 719.64
► DG214-243-NL	1" Female Iron Pipe	3/4" Pack Joint for Copper or Plastic Tubing (CTS)*	42.0	732.63
DG218-243-NL	1" Female Iron Pipe	3/4" Male Iron Pipe	43.6	697.45
DG222-243-NL	1" Flare Copper	3/4" Flare Copper	42.0	729.00
► DG224-243-NL	1" Flare Copper	3/4" Pack Joint for Copper or Plastic Tubing (CTS)*	42.0	741.59
DG228-243-NL	1" Flare Copper	3/4" Male Iron Pipe	43.9	706.57
► DG242-243-NL	1" Pack Joint for Copper or Plastic Tubing (CTS)*	3/4" Flare Copper	42.0	724.06
► DG244-243-NL	1" Pack Joint for Copper or Plastic Tubing (CTS)*	3/4" Pack Joint for Copper or Plastic Tubing (CTS)*	42.0	736.83
► DG248-243-NL	1" Pack Joint for Copper or Plastic Tubing (CTS)*	3/4" Male Iron Pipe	43.7	701.75

NOTE: Ford Pack, Quick and Grip Joint compression connections, when used on copper, are designed for Type K or Type L copper only.

* **Grip Joint** can be ordered by inserting "-G" into the catalog number. Example: DG242-243-G-NL

- Ultra-Tite is available. Insert "-U-NA" into the catalog number (shipped unassembled). Contact factory for pricing and availability.
Example: DG242-243-U-NA-NL

PARTS FOR DOUBLE GULFBOXES

CATALOG NUMBER	DESCRIPTION	APPROX. WT. LBS.	LIST PRICE
EC-1-NL	Expansion Connection for 5/8" Meter	0.7	\$ 42.33
EC-1-OR-H2-NL	Expansion Connection for 5/8" Meter, with Dual Check Valves	0.7	81.84
ECL-1-NL	Locking Expansion Connection for 5/8" Meter without Security Screw	0.9	81.36
ECL-1-SSF-NL	Locking Expansion Connection for 5/8" Meter with Security Screw	0.9	87.87
ECL-1-OR-H2-NL	Locking Expansion Connection for 5/8" Meter without Security Screw, with Dual Check Valves	0.9	120.92
ECL-1-OR-H2-SSF-NL	Locking Expansion Connection for 5/8" Meter with Security Screw, with Dual Check Valves	0.9	127.41
EC-23-NL	Expansion Connection for 5/8" x 3/4" Meter	0.9	47.96
EC-23-OR-H2-NL	Expansion Connection for 5/8" x 3/4" Meter, with Dual Check Valves	1.0	87.50
ECL-23-NL	Locking Expansion Connection for 5/8" x 3/4" Meter without Security Screw	1.1	92.26
ECL-23-SSF-NL	Locking Expansion Connection for 5/8" x 3/4" Meter with Security Screw	1.2	98.79
ECL-23-OR-H2-NL	Locking Expansion Connection for 5/8" x 3/4" Meter without Security Screw, with Dual Check Valves	1.3	131.78
ECL-23-OR-H2-SSF-NL	Locking Expansion Connection for 5/8" x 3/4" Meter with Security Screw, with Dual Check Valves	1.3	138.33
BOLT-800998-SSF	Security Screw (fits all Ford locking expansions)	-	7.26
KEY-800999-SSF	Security Key / Tip Only for Locking Expansion Connection	-	83.34
NUT-DR-040072-SSF	Magnetic Nut Driver Less Key / Tip	0.3	43.58
EC-1-OR-H2-RK	Check Valve Repair Kit for EC-1-OR-H2-NL	-	32.36
EC-23-OR-H2-RK	Check Valve Repair Kit for EC-23-OR-H2-NL	0.1	32.36
DGBB	Iron Body, Less Lid	27.5	181.90
DGBL	Lid Only for Double Gulfbox	8.6	54.98
DGBL-TT	Double Gulfbox Locking Electronic Meter Reading Lid with Two 2" Holes	11.6	65.62
DGBLL	Lockless Lid Only for Double Gulfbox	7.8	54.98
DGIR-2	2" Iron Riser for Double Gulfbox	10.6	147.99
DGSSBP	Stainless Steel Bottom Plate for Double Gulfbox	2.4	102.60
MBLK	Yokebox Lid Key	0.3	20.33
MBVW	Yokebox Valve Wrench (18" long)	1.9	73.33
GT-112	5/8" Rubber Gaskets for Valve and Outlet Saddles	-	0.49
GT-32	5/8" Beveled Expansion Connection Gasket	-	1.37
GT-33	5/8" x 3/4" Beveled Expansion Connection Gasket	-	1.67
GT-210	5/8" Flat Expansion Connection Gasket	-	1.23
GT-196	5/8" x 3/4" Flat Expansion Connection Gasket	-	1.58
GT-118	5/8" x 3/4" Rubber Gaskets for Valve and Outlet Saddles	-	0.65

Note: Valves available on page 27.

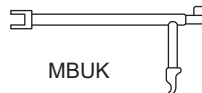
**OPTIONS AND ACCESSORIES FOR DOUBLE GULFBOXES**

CATALOG NUMBER	DESCRIPTION	LIST PRICE
PTP	Removable Plastic Plug / Nut for Electronic Meter Reading Lid Hole	\$ 11.58
PTP-BR	Removable Plastic Plug for Electronic Meter Reading Lid Hole with ERT Bracket	16.12
TP	Removable Cast Iron Plug for Electronic Meter Reading Module Hole (with cotter pin)	9.97
Insert "-PTP" into Catalog Number	Removable Plastic Plug / Nut for Electronic Meter Reading Lid Hole	16.90
Insert "-PTP-BR" into Catalog Number	Removable Plastic Plug for Electronic Meter Reading Lid Hole with ERT Bracket	21.45
Insert "-TT" into Catalog Number	Iron Electronic Meter Read Locking Lid (two 2" holes) Example: DG128-243-TT-NL	10.65
Insert "-TTP" into Catalog Number	Iron Electronic Meter Read Locking Lid (two 2" holes) with Removable Plugs Example: DG128-243-TTP-NL	30.57

INSERT INTO THE CATALOG NUMBER	DESCRIPTION	5/8" METER SIZE ADD TO PRICE	5/8" x 3/4" METER SIZE ADD TO PRICE
Insert "-XA" into Catalog Number	Locking Expansion Connection without Ford Security Screw	\$ 78.06	\$ 88.62
Insert "-XB" into Catalog Number	Locking Expansion Connection with Ford Security Screw	91.08	101.64
Insert "-XC" into Catalog Number	Expansion Connection with Dual Check Valves for Standard Yokeboxes. Example: DG128-243-XC-NL	79.06	79.08
Insert "-XD" into Catalog Number	Locking Expansion Connection without Ford Security Screw with Dual Check Valves for Standard Yokeboxes. Example: DG128-243-XD-NL	157.18	167.68
Insert "-XE" into Catalog Number	Locking Expansion Connection with Ford Security Screw with Dual Check Valves for Standard Yokeboxes. Example: DG128-243-XE-NL	170.18	180.70

NOTE: Dual cartridge check valve repair kits (cartridges, gaskets, etc.) are in catalog section I.

FORD LONG DOUBLE GULFBOXES

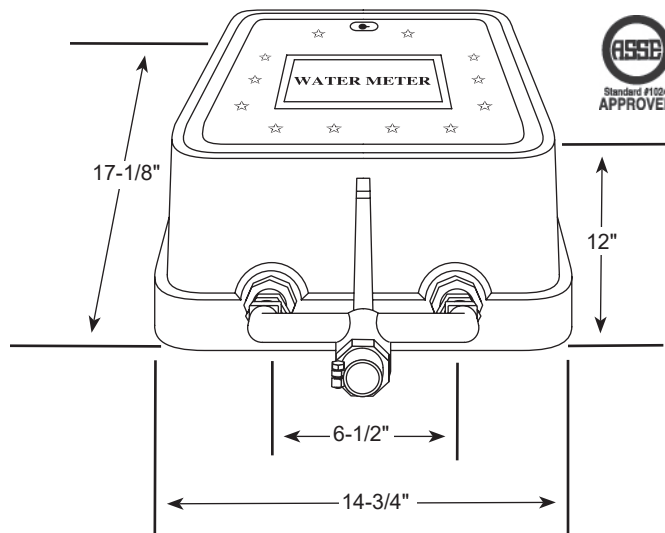

C

FORD LONG DOUBLE GULFBOX FOR TWO 5/8" METERS

STRAIGHT BALL VALVE INLET - STRAIGHT BALL VALVE OUTLET

CATALOG NUMBER	DESCRIPTION		APPROX. WT. LBS.	LIST PRICE
	INLET	BOTH OUTLETS		
DGHC118-143-NL	1" Female Iron Pipe	3/4" Male Iron Pipe	81.8	\$ 1596.94
DGHC128-143-NL	1" Flare Copper	3/4" Male Iron Pipe	70.0	1605.25
► DGHC148-143-NL	1" Pack Joint for Copper or Plastic Tubing (CTS)*	3/4" Male Iron Pipe	70.0	1612.73

FORD LONG DOUBLE GULFBOX FOR TWO 5/8" X 3/4" METERS

STRAIGHT BALL VALVE INLET - STRAIGHT BALL VALVE OUTLET

CATALOG NUMBER	DESCRIPTION		APPROX. WT. LBS.	LIST PRICE
	INLET	BOTH OUTLETS		
DGHC118-243-NL	1" Female Iron Pipe	3/4" Male Iron Pipe	82.5	\$ 1605.42
DGHC128-243-NL	1" Flare Copper	3/4" Male Iron Pipe	70.0	1615.15
► DGHC148-243-NL	1" Pack Joint for Copper or Plastic Tubing (CTS)*	3/4" Male Iron Pipe	82.6	1621.07

NOTE: Ford Pack, Quick and Grip Joint compression connections, when used on copper, are designed for Type K or Type L copper only.

Two ASSE 1024 approved cartridge style dual check valves are contained completely within the Ford Long Double Gulfbox.



Ordering Information

Gaskets are furnished – Flat gaskets for valve and outlet saddles; beveled and flat gaskets for expansion connections.

* **Grip Joint** can be ordered by inserting "-G" into the catalog number. Example: DGHC148-143-G-NL

- Ultra-Tite is available. Insert "-U-NA" into the catalog number (shipped unassembled). Contact factory for pricing and availability. Example: DGHC148-143-U-NA-NL

Available with locking lid only.

See page C-30 for parts, options and accessories.

FORD LONG DOUBLE GULFBOX OPTIONS AND ACCESSORIES FOR 5/8" AND 5/8" X 3/4" LONG DOUBLE GULFBOXES

EXPANSION CONNECTION OPTIONS FOR 5/8", 5/8" X 3/4", AND 3/4" LONG DOUBLE GULFBOXES

CATALOG NUMBER	DESCRIPTION	LIST PRICE
EC-1-NL	Expansion Connection for 5/8" Meter	\$ 42.33
ECL-1-NL	Locking Expansion Connection for 5/8" Meter without Security Screw	81.36
ECL-1-SSF-NL	Locking Expansion Connection for 5/8" Meter with Security Screw	87.87
EC-23-NL	Expansion Connection for 5/8" x 3/4" Meter	47.96
ECL-23-NL	Locking Expansion Connection for 5/8" x 3/4" Meter without Security Screw	92.26
ECL-23-SSF-NL	Locking Expansion Connection for 5/8" x 3/4" Meter with Security Screw	98.79
BOLT-800998-SSF	Security Screw (fits all Ford locking expansions)	7.26
KEY-800999-SSF	Security Key / Tip Only for Locking Expansion Connection	83.34
NUT-DR-040072-SSF	Magnetic Nut Driver Less Key / Tip	43.58
GT-32	5/8" Beveled Expansion Connection Gasket	1.37
GT-33	5/8" x 3/4" Beveled Expansion Connection Gasket	1.67
GT-210	5/8" Flat Expansion Connection Gasket	1.23
GT-196	5/8" x 3/4" Flat Expansion Connection Gasket	1.58

VALVES AND PARTS FOR LONG DOUBLE GULFBOXES

CATALOG NUMBER	DESCRIPTION	APPROX. WT. LBS.	LIST PRICE
DGHCB	Long Double Gulfbox Iron Body Casting	56.2	\$ 676.06
DGHCL	Locking Lid for Long Double Gulfbox	14.9	92.96
DGBV83-31-NL	Ball Valve for 5/8" Meter by 3/4" Male Iron Pipe Thread	1.1	105.07
DGBV83-32-NL	Ball Valve for 5/8" x 3/4" Meter by 3/4" Male Iron Pipe Thread	1.1	102.47
GT-112	5/8" Rubber Gasket for Valve and Outlet Saddles	-	0.49
GT-118	5/8" x 3/4" Rubber Gasket for Valve and Outlet Saddles	-	0.65
HHCI33-311-3-531PE-NL	3/4" Cartridge Style Dual Check Valve for 5/8" Meter	1.4	141.10
HHCI33-322-3-5-PE-NL	3/4" Cartridge Style Dual Check Valve for 5/8" x 3/4" Meter	1.4	141.10
MBLK	Meter Box Lid Key	0.3	20.33
MBUK	Meter Box Universal Key for Locking Lids, Lockless Lids and Yokebox Valves	1.3	60.97

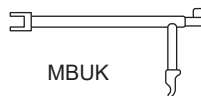

OPTIONS AND ACCESSORIES FOR LONG DOUBLE GULFBOXES

CATALOG NUMBER	DESCRIPTION	LIST PRICE
PTP	Removable Plastic Plug / Nut for Electronic Meter Reading Lid Hole	\$ 11.58
PTP-BR	Removable Plastic Plug for Electronic Meter Reading Lid Hole with ERT Bracket	16.12
TP	Removable Cast Iron Plug for Electronic Meter Reading Module Hole (with cotter pin)	9.97
Insert "-PTP" into Catalog Number	Removable Plastic Plug / Nut for Electronic Meter Reading Lid Hole	16.90
Insert "-PTP-BR" into Catalog Number	Removable Plastic Plug for Electronic Meter Reading Lid Hole with ERT Bracket	21.45
Insert "-TT" into Catalog Number	Iron Electronic Meter Read Locking Lid (two 2" holes) Example: DGHC128-243-TT-NL	10.65
Insert "-TTP" into Catalog Number	Iron Electronic Meter Read Locking Lid (two 2" holes) with Removable Plugs Example: DGHC128-243-TTP-NL	30.57

INSERT INTO THE CATALOG NUMBER	DESCRIPTION	5/8" METER SIZE ADD TO PRICE	5/8" x 3/4" METER SIZE ADD TO PRICE
Insert "-XA" into Catalog Number	Locking Expansion Connection without Ford Security Screw	\$ 78.06	\$ 88.62
Insert "-XB" into Catalog Number	Locking Expansion Connection with Ford Security Screw	91.08	101.64

NOTE: Dual cartridge check valve repair kits (cartridges, gaskets, etc.) are in catalog section I.

PROTECTOR METER BOXES FOR 1-1/2" AND 2" METERS

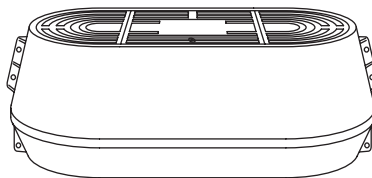

PROTECTOR BOX LESS BRASS FITTINGS

CATALOG NUMBER	DESCRIPTION	APPROX. Wt. LBS.	LIST PRICE
FPMB-7	Protector Box with Standard Finish	117.5	\$ 1222.84
FPMB-7EP	Protector Box with Epoxy Coating	115.2	1667.49
FPMB-7-T	Protector Box with Standard Finish and Electronic Read Feature on Lid	116.6	1228.75

NOTE: Above items DO NOT include brass connections for meters. See table below for valves; see section "H" for complete listing of available meter couplings.

PARTS FOR PROTECTOR METER BOXES

CATALOG NUMBER	DESCRIPTION	APPROX. Wt. LBS.	LIST PRICE
FPMBL-E-7	Protector Box End Lid	6.4	\$ 49.92
FPMBL-C-7	Protector Box Center Lid	13.2	122.13
FPMBL-E-7-T	Protector Box End Electronic Read Lid	5.5	56.39
BFP83-676W-NL	1-1/2" Inlet Valve - 2" Male Iron Pipe by 1-1/2" Meter Flange	8.9	490.99
BFP83-777W-NL	2" Inlet Valve - 2" Male Iron Pipe by 2" Meter Flange	10.8	739.58
BFP83-777W-EXP-NL	2" Inlet Valve - 2" Male Iron Pipe by 2" Expanding Meter Flange	12.4	789.65

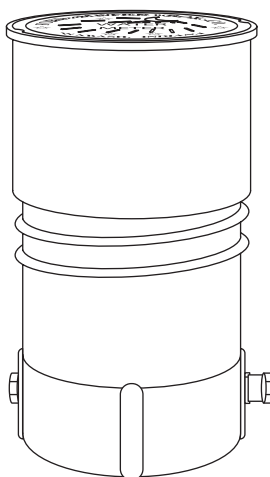

CRESCENT BOXES

CATALOG NUMBER	METER SIZE	DESCRIPTION		APPROX. Wt. LBS.	LIST PRICE
		INLET	OUTLET		
CB111-133-NL	5/8"	3/4" Female Iron Pipe	3/4" Female Iron Pipe	75.7	\$ 752.16
► CB144-133-NL	5/8"	3/4" Pack Joint for Copper or Plastic Tubing (CTS)*	3/4" Pack Joint for Copper or Plastic Tubing (CTS)*	72.0	788.93
CB111-233-NL	5/8" x 3/4"	3/4" Female Iron Pipe	3/4" Female Iron Pipe	75.6	757.05
CB111-333-NL	3/4"	3/4" Female Iron Pipe	3/4" Female Iron Pipe	95.0	927.49
CB111-444-NL	1"	1" Female Iron Pipe	1" Female Iron Pipe	106.8	1091.99

NOTE: Ford Pack, Quick and Grip Joint compression connections, when used on copper, are designed for Type K or Type L copper only.

Note: Iron lockless lids are standard on Crescent Boxes.

- * **Grip Joint** can be ordered by inserting "-G" into the catalog number. Example: CB144-133-G-NL
- Ultra-Tite is available. Insert "-U-NA" into the catalog number (shipped unassembled). Contact factory for pricing and availability. Example: CB144-133-U-NA-NL

Plastic lid option: Insert "-P" into the catalog number for locking plastic lid..... **no additional charge**

Example: CBxxx-xxx-P-NL

Insert "-PB" into the catalog number for locking plastic lid with ERT bracket and add to price..... **\$ 7.86**

Example: CBxxx-xxx-PB-NL

CRESCENT BOX PARTS

CATALOG NUMBER	METER SIZE	DESCRIPTION	APPROX. WT. LBS.	LIST PRICE
CBL	5/8" thru 1"	Iron Locking Lid	10.9	\$ 53.96
CBL-T	5/8" thru 1"	Iron Locking Lid with Electronic Read (2" hole)	10.6	59.29
CBLL	5/8" thru 1"	Iron Lockless Top Lid	10.4	53.96
CBLL-T	5/8" thru 1"	Iron Lockless Lid with Electronic Read (2" hole)	10.3	59.29
CBLP	5/8" thru 1"	Plastic Locking Lid	2.4	53.96
CBLP-BR	5/8" thru 1"	Plastic Locking Lid with ERT Bracket	2.6	61.83
CBLN	5/8" thru 1"	Crescent Box Lock Nut (included with valves and outlets)	-	9.55
CBBA	5/8" thru 1"	Box Inner and Outer Barrel	44.7	310.39
CBB-1	5/8" and 5/8" x 3/4"	Base Piece	17.6	95.55
CBB-3	3/4"	Base Piece	30.2	133.43
CBB-4	1"	Base Piece	34.9	158.28
CBA-3	3/4"	Box Adapter Ring	9.9	51.46
CBA-4	1"	Box Adapter Ring	10.4	68.99
CBUB	5/8" thru 1"	One Piece Upper Barrel	30.4	169.72
CBV-1-NL	5/8"	Crescent Box Key Valve 3/4" Female Iron Pipe Inlet	1.8	146.90
CBV13-231-NL	5/8"	Crescent Box Ball Valve 3/4" Female Iron Pipe Inlet	1.4	145.58
CBV13-232-NL	5/8" x 3/4"	Crescent Box Ball Valve 3/4" Female Iron Pipe Inlet	1.3	147.91
► CBV34-313-NL	5/8"	Crescent Box Key Valve 3/4" Pack Joint for CTS Inlet*	2.1	170.08
CBEO-1-NL	5/8"	Crescent Box Expansion 3/4" Female Iron Pipe Outlet	1.6	101.17
► CBEO-4-13-NL	5/8"	Crescent Box Expansion 3/4" Pack Joint for CTS Outlet*	1.8	122.69
CBV-2-NL	5/8" x 3/4"	Crescent Box Key Valve 3/4" Female Iron Pipe Inlet	1.9	122.10
CBEO-2-NL	5/8" x 3/4"	Crescent Box Expansion 3/4" Female Iron Pipe Outlet	1.5	105.56
CBV-3-NL	3/4"	Crescent Box Key Valve 3/4" Female Iron Pipe Inlet	2.6	161.71
CBEO-3-NL	3/4"	Crescent Box Expansion 3/4" Female Iron Pipe Outlet	2.0	193.04
CBV-4-NL	1"	Crescent Box Key Valve 1" Female Iron Pipe Inlet	3.5	239.82
CBEO-4-NL	1"	Crescent Box Expansion 1" Female Iron Pipe Outlet	2.9	209.39
CBBV13-344-NL	1"	Crescent Box Ball Valve 1" Female Iron Pipe Inlet	2.1	168.16
* CBBV43-344-NL	1"	Crescent Box Ball Valve 1" Pack Joint for CTS Inlet	2.5	185.67

* Grip Joint can be ordered by inserting "-G" into the catalog number. Example: CBV34-313-G-NL

- Ultra-Tite is available. Insert "-U-NA" into the catalog number (shipped unassembled). Contact factory for pricing and availability.
Example: CBV34-313-U-NA-NL

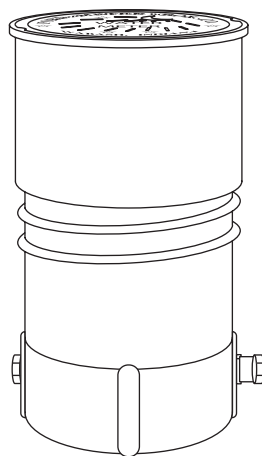

OPTIONS AND ACCESSORIES FOR CRESCENT BOXES

CATALOG NUMBER	DESCRIPTION	LIST PRICE
MBVW	Crescent Box Valve Wrench (18" long)	\$ 73.33
MBLK	Crescent Box Lid Key	20.33
PTP	Removable Plastic Plug / Nut for Electronic Meter Reading Lid Hole	11.58
PTP-BR	Removable Plastic Plug for Electronic Meter Reading Lid Hole with ERT Bracket	16.12
PBR-YJ	Plastic ERT Bracket with (3) Stainless Steel Clips (field installation only)	9.68
TP	Removable Cast Iron Plug for Electronic Meter Reading Module Hole (with cotter pin)	9.97
Insert "-PTP" into Catalog Number	Removable Plastic Plug / Nut for Electronic Meter Reading Lid Hole Example: CB111-233-PTP-NL	16.90
Insert "-PTP-BR" into Catalog Number	Removable Plastic Plug for Electronic Meter Reading Lid Hole with ERT Bracket Example: CB111-233-PTP-BR-NL	21.45
Insert "-T" into Catalog Number	Electronic Meter Read Feature on Iron Lid (2" hole), add to price Example: CB111-233-T-NL	5.31