

# SUBMITTAL INFORMATION

## Adjustable Meter Flange - (CF31-xx-EXP-NL style)

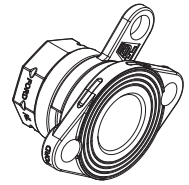

### TELESCOPING METER FLANGE BY FEMALE IRON PIPE THREAD

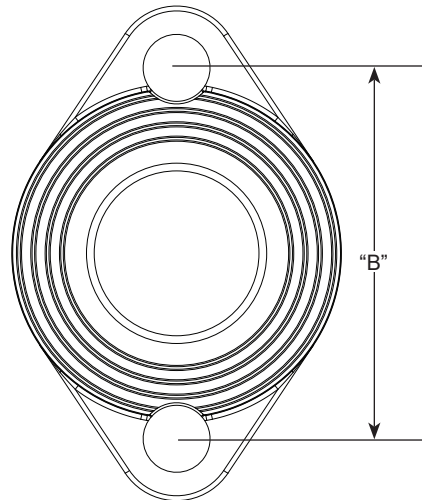
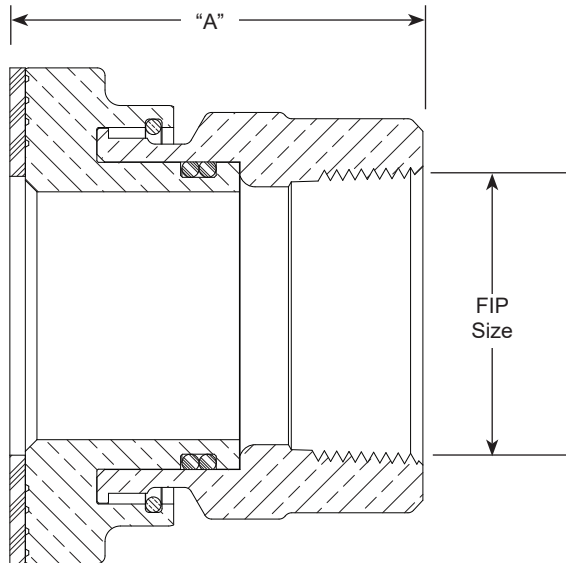

**Expandable Flange  
Patent  
# 18169305**

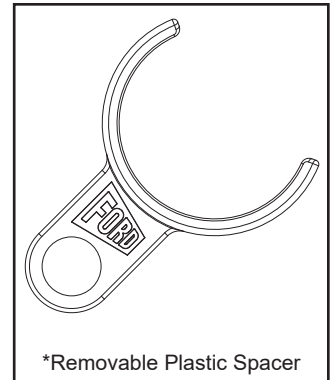

\*Removable Plastic Spacer  
\* Plastic spacer must be installed prior to establishing meter spacing. May be removed after installation.

Due to design variations related to sizing, items may differ from images above.

| DESCRIPTION (IN.)                                       | APPROX.<br>WT.<br>LBS | PART<br>NUMBER | DIMENSION<br>"A" (IN.) |         | BOLT HOLE<br>DIAMETER<br>(IN.) | DIMENSION<br>"B"<br>(IN.) | ✓ SUBMITTED<br>ITEM(S) |
|---|-----------------------|----------------|------------------------|---------|--------------------------------|---------------------------|------------------------|
|   |                       |                | MIN                    | MAX     |                                |                           |                        |
| 1-1/2 Telescoping Meter Flange x 1-1/2 Female IP Thread | 5.1                   | CF31-66-EXP-NL | 3-3/8                  | 3-11/16 | 11/16                          | 4                         |                        |
| 2 Telescoping Meter Flange x 2 Female IP Thread         | 5.4                   | CF31-77-EXP-NL | 3-7/32                 | 3-1/2   | 13/16                          | 4-1/2                     |                        |

### FEATURES

- All brass that comes in contact with potable water conforms to AWWA Standard C800 (ASTM B584, UNS C89833)
- The product has the letters "NL" cast into the main body for lead-free identification
- Certified to NSF/ANSI/CAN Standard 61 and NSF/ANSI/CAN Standard 372 where applicable
- Brass components that do not come in contact with potable water conform to AWWA Standard C800 (ASTM B62 and ASTM B584, UNS C83600, 85-5-5-5)
- Drop-in meter gaskets are included with all meter flanges
- Adjustable meter flange offers flexibility in meter installations or change-outs
- Flange can rotate 360° for installation, will hold position once pressurized

The Ford Meter Box Company considers the information in this submittal form to be correct at the time of publication. Item and option availability, including specifications, are subject to change without notice. Please verify that your product information is current. Our standard warranty applies.



**The Ford Meter Box Company, Inc.**

P.O. Box 443, Wabash, Indiana U.S.A. 46992-0443

Phone: 260-563-3171 / Fax: 800-826-3487

Overseas Fax: 260-563-0167

[www.fordmeterbox.com](http://www.fordmeterbox.com)

09/17/25

Submitted By: