

SUBMITTAL INFORMATION

Fabricated Steel Saddle - (FS202-xxxx-Tap style)

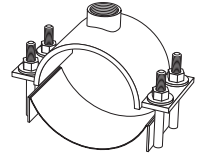

36" THROUGH 54" FABRICATED STEEL SADDLE WITH STAINLESS STEEL BAND

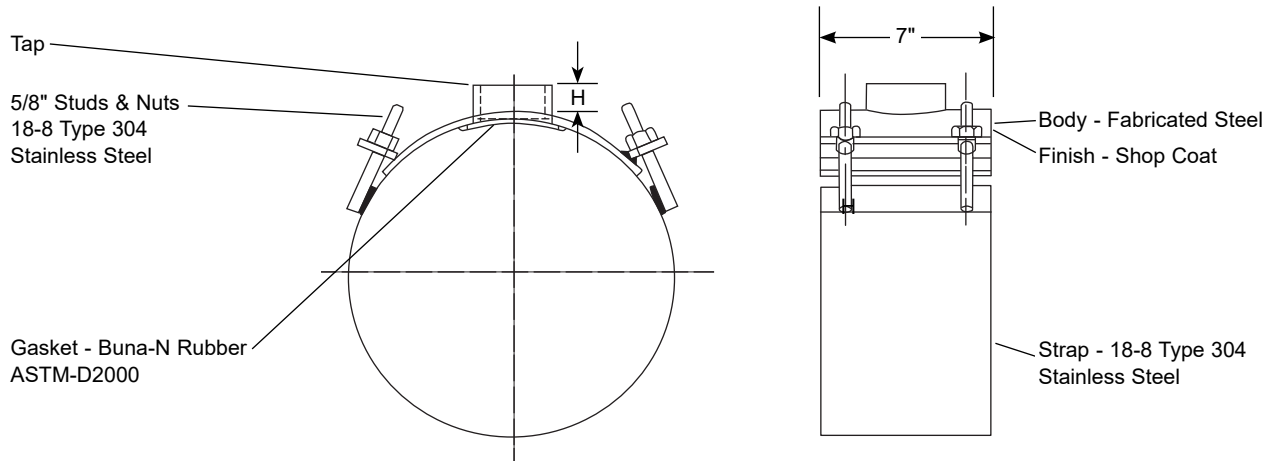

NOM. PIPE SIZE	ACTUAL PIPE O.D.	BOSS HEIGHT H	APPROX. WT. LBS.	CATALOG NUMBER	✓ SUBMITTED ITEM(S)
36"	38.30	1-1/2"	35.0	FS202-3830-Tap	
42"	42.00	1-1/2"	36.0	FS202-4200-Tap	
42"	44.50	1-1/2"	37.0	FS202-4450-Tap	
48"	50.80	1-1/2"	39.0	FS202-5080-Tap	
54"	57.56	1-1/2"	42.0	FS202-5756-Tap	

OUTLET THREAD TAP CODE

CC (AWWA) THREAD			IP THREAD		
THREAD	CODE No.	✓ SUBMITTED ITEM(S)	THREAD	CODE No.	✓ SUBMITTED ITEM(S)
3/4" CC	CC3		3/4" IP	IP3	
1" CC	CC4		1" IP	IP4	
1-1/4" CC	CC5		1-1/4" IP	IP5	
1-1/2" CC	CC6		1-1/2" IP	IP6	
2" CC	CC7		2" IP	IP7	
			2-1/2" IP	IP8	
			3" IP	IP9	
			4" IP	IP11	

FEATURES

- 150 psi working pressure, dependent upon industry standard support and backfill practices

The Ford Meter Box Company considers the information in this submittal form to be correct at the time of publication. Item and option availability, including specifications, are subject to change without notice. Please verify that your product information is current.



The Ford Meter Box Company, Inc.

P.O. Box 443, Wabash, Indiana U.S.A. 46992-0443

Phone: 260-563-3171 / Fax: 800-826-3487

Overseas Fax: 260-563-0167

www.fordmeterbox.com

10/31/16

Submitted By: