

SUBMITTAL INFORMATION

Mechanical Joint Tapping Sleeve - (MJTS-xxx-x-Q style)

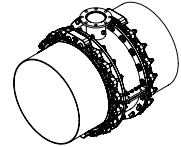

4"-10" MECHANICAL JOINT TAPPING SLEEVE WITH 316 STAINLESS STEEL HARDWARE

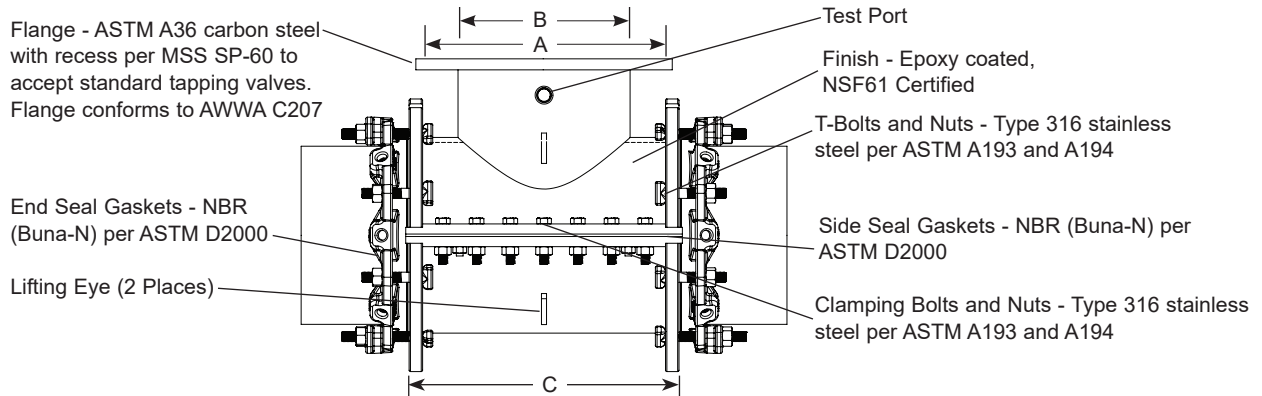

NOM. PIPE SIZE	SLEEVE* O.D. RANGE (IN.)	BY	FLANGED SIZE CODE (IN.)	NOMINAL DIMENSIONS - INCHES			APPROX. WT. (LBS.)	SLEEVE NUMBER***	✓ SUBMITTED ITEM(S)
				A	B	C			
4"	4.80	X	4	5-1/32"	4-1/4"	12"	105	MJTS-480-x-Q	
6"	6.90		4	5-1/32"	4-1/4"	12"	145	MJTS-690-x-Q	
			6	7-1/32"	6-5/16"	12"	153		
8"	9.05	X	4	5-1/32"	4-1/4"	12"	178	MJTS-905-x-Q	
			6	7-1/32"	6-5/16"	12"	186		
			8	9-1/32"	8-1/4"	20"	196		
10"	11.10	X	4	5-1/32"	4-1/4"	12"	219	MJTS-1110-x-Q	
			6	7-1/32"	6-5/16"	12"	227		
			8	9-1/32"	8-1/4"	20"	237		
			10	11-1/32"	10-1/4"	20"	254		

* Sleeve will accommodate AWWA pipe tolerances.

*** To order: Add flange size to the sleeve number. Example: A 4" flange on 4" cast iron pipe would be MJTS-480-4-Q. For MJ outlet, add "-MJ" to the catalog number. Example: MJTS-480-4-MJ-Q.

FEATURES

- Heavy welded steel meeting ASTM A36, 36,000 psi minimum yield
- Alignment pins to ensure proper assembly
- End seal gasket compression achieved by ductile iron MJ glands
- End seal gasket "key-locked" for easy installation
- Rated for 305 psi
- Unique leverage bar sealing system eliminates the need for removing or modifying the side seal gasket during installation

The Ford Meter Box Company considers the information in this submittal form to be correct at the time of publication. Item and option availability, including specifications, are subject to change without notice. Please verify that your product information is current. Our standard warranty applies.



The Ford Meter Box Company, Inc.

P.O. Box 443, Wabash, Indiana U.S.A. 46992-0443

Phone: 260-563-3171 / Fax: 800-826-3487

Overseas Fax: 260-563-0167

www.fordmeterbox.com

10/04/22

Submitted By: