

SUBMITTAL INFORMATION

Mechanical Joint Tapping Sleeve - (MJTS-xxxx-xx-X style)

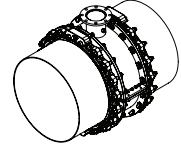

MECHANICAL JOINT TAPPING SLEEVE WITH 304 STAINLESS STEEL HARDWARE

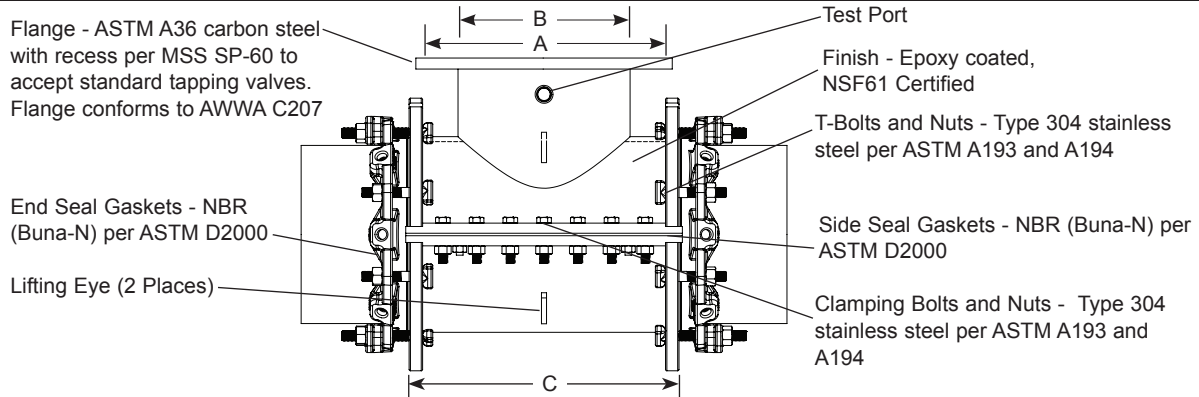

| NOM. PIPE SIZE | SLEEVE* O.D. RANGE (IN.) | FLANGED SIZE CODE (IN.) | NOMINAL DIMENSIONS - INCHES | | | SLEEVE NUMBER*** | ✓ SUBMITTED ITEM(S) |
|-------------------|-----------------------------|----------------------------|-----------------------------|---------|-----|------------------|------------------------|
| | | | A | B | C | | |
| 12" | 13.20 | 4 | 5-3/64" | 4-1/8" | 12" | MJTS-1320-xx-X | |
| | | 6 | 7-3/64" | 6-1/4" | 12" | | |
| | | 8 | 9-3/64" | 8-1/4" | 20" | | |
| | | 10 | 11-3/64" | 10-1/4" | 20" | | |
| | | 12 | 13-3/64" | 12-1/4" | 20" | | |
| 14" | 15.30 | 4 | 5-3/64" | 4-1/8" | 12" | MJTS-1530-xx-X | |
| | | 6 | 7-3/64" | 6-1/4" | 12" | | |
| | | 8 | 9-3/64" | 8-1/4" | 20" | | |
| | | 10 | 11-3/64" | 10-1/4" | 20" | | |
| | | 12 | 13-3/64" | 12-1/4" | 20" | | |
| 16" | 17.40 | 14 | 15-5/16" | 13-1/2" | 27" | MJTS-1740-xx-X | |
| | | 4 | 5-3/64" | 4-1/8" | 12" | | |
| | | 6 | 7-3/64" | 6-1/4" | 12" | | |
| | | 8 | 9-3/64" | 8-1/4" | 20" | | |
| | | 10 | 11-3/64" | 10-1/4" | 20" | | |
| 18" | 19.50 | 12 | 13-3/64" | 12-1/4" | 20" | MJTS-1950-xx-X | |
| | | 14 | 15-5/16" | 13-1/2" | 27" | | |
| | | 16 | 17-5/16" | 15-1/2" | 27" | | |
| | | 4 | 5-3/64" | 4-1/8" | 12" | | |
| | | 6 | 7-3/64" | 6-1/4" | 12" | | |
| | | 8 | 9-3/64" | 8-1/4" | 20" | | |
| | | 10 | 11-3/64" | 10-1/4" | 20" | | |
| | | 12 | 13-3/64" | 12-1/4" | 20" | | |
| | | 14 | 15-5/16" | 13-1/2" | 27" | | |
| | | 16 | 17-5/16" | 15-1/2" | 27" | | |
| | | 18 | 19-17/32" | 17-1/2" | 27" | | |

* Sleeve will accommodate AWWA pipe tolerances.

*** To order: Add flange size to the sleeve number. Example: A 4" flange on 14" cast iron pipe would be MJTS-1530-4-X. For MJ outlet, add "-MJ" to the catalog number. Example: MJTS-1530-4-MJ-X.

FEATURES

- Heavy welded steel meeting ASTM A36, 36,000 psi minimum yield
- Alignment pins to ensure proper assembly
- End seal gasket compression achieved by ductile iron MJ glands
- End seal gasket "key-locked" for easy installation
- Rated for 305 psi
- Unique leverage bar sealing system eliminates the need for removing or modifying the side seal gasket during installation

The Ford Meter Box Company considers the information in this submittal form to be correct at the time of publication. Item and option availability, including specifications, are subject to change without notice. Please verify that your product information is current. Our standard warranty applies.



The Ford Meter Box Company, Inc.

P.O. Box 443, Wabash, Indiana U.S.A. 46992-0443

Phone: 260-563-3171 / Fax: 800-826-3487

Overseas Fax: 260-563-0167

www.fordmeterbox.com

12/21/23

Submitted By: