

SUBMITTAL INFORMATION

Restrained Coupling - (RCPP-x-J-I style)

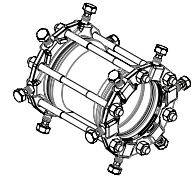

**3" - 12" STYLE RCPP (WITH 316 STAINLESS STEEL) FOR JOINING PIPES
OF THE SAME NOMINAL SIZE**

FOR C900, IPS PVC, STEEL, C909, HDPE AND SDR35 PIPE

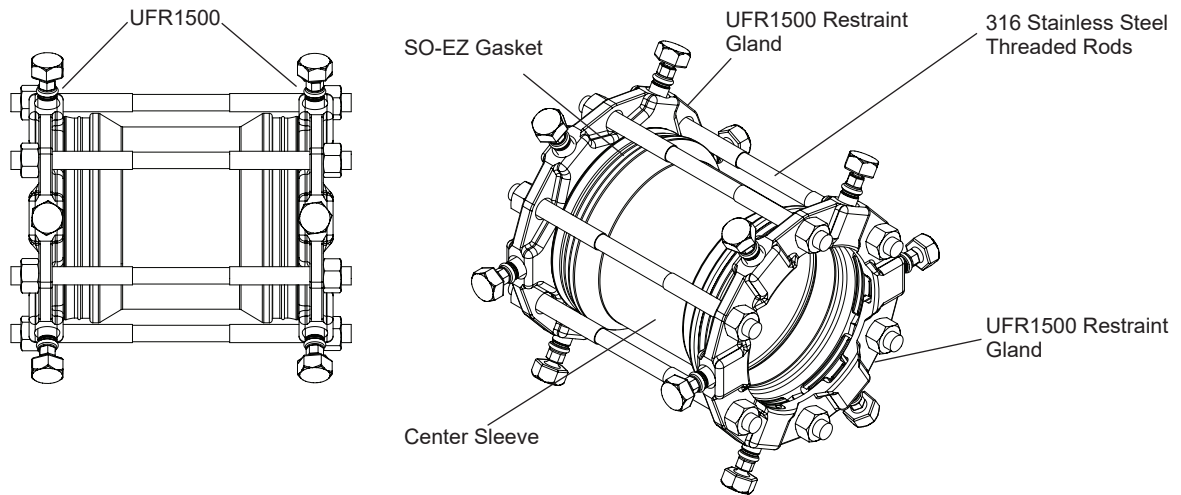

NOMINAL PIPE SIZE	PIPE O.D. RANGE (INCHES)	PIPE O.D. RANGE (MM)	SLEEVE LENGTH	DEGREES DEFLECTION	NO. OF RODS	SIZE OF RODS	APPROX. WT. LBS	PART NUMBER	✓ SUBMITTED ITEM(S)
3"	3.50	88.9	7-1/2"	2°	4	5/8" x 14"	39	RCPP-3-J-I	
4"	4.21 - 4.80	106.9 - 121.9	7-1/2"	5°	4	3/4" x 14"	41	RCPP-4-J-I	
6"	6.27 - 6.90	159.3 - 175.3	7-1/2"	5°	6	3/4" x 14"	59	RCPP-6-J-I	
8"	8.40 - 9.05	213.4 - 229.9	7-1/2"	5°	6	3/4" x 14"	72	RCPP-8-J-I	
10"	10.50 - 11.10	266.7 - 281.9	7-1/2"	5°	8	3/4" x 14"	94	RCPP-10-J-I	
12"	12.50 - 13.20	317.5 - 335.3	7-1/2"	5°	8	3/4" x 14"	106	RCPP-12-J-I	

FEATURES

- Center Sleeve - Ductile iron per ASTM A536, fusion bonded epoxy coated
- Restraint Glands - Ductile iron per ASTM A536, epoxy coated via the e-coat process with red top coat for identification
- Double End Rods & Nuts - Type 316 stainless steel
- Gaskets - SO-EZ gaskets, pre-lubricated NBR (Buna-N) rubber to accommodate listed ranges.
- Stab fit, no disassembly required
- Can be used with any thickness class AWWA C900 and C909 PVC, ASTM D2241 IPS PVC, Steel Pipe or SDR35 Sewer Pipe. Also approved for HDPE pipe when an insert is used
- "Auto-Tork" actuating screws with heads specially designed to twist off at the correct installation torque
- Rated at the same pressure rating on which it is installed with a 2:1 safety factor
- Complies with AWWA C219

The Ford Meter Box Company considers the information in this submittal form to be correct at the time of publication. Item and option availability, including specifications, are subject to change without notice. Please verify that your product information is current. Our standard warranty applies.



The Ford Meter Box Company, Inc.
P.O. Box 443, Wabash, Indiana U.S.A. 46992-0443
Phone: 260-563-3171 / Fax: 800-826-3487
Overseas Fax: 260-563-0167
www.fordmeterbox.com

01/24/22

Submitted By: