

SUBMITTAL INFORMATION

Restrained Coupling for PVC and Steel Pipe - (RCPP-xxxx-xxxxST-E-U style)

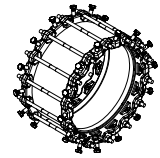

14" - 16" RESTRAINED COUPLING FOR AWWA C905 PVC AND STEEL PIPE

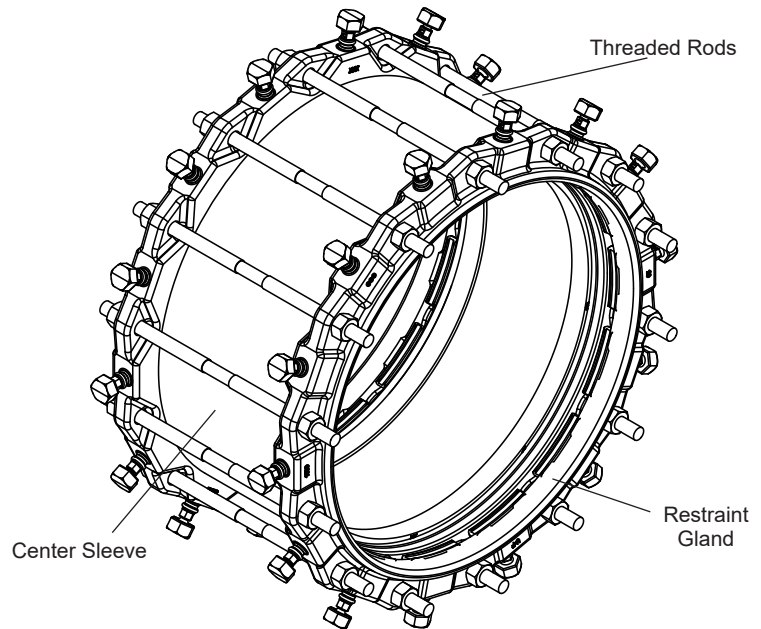
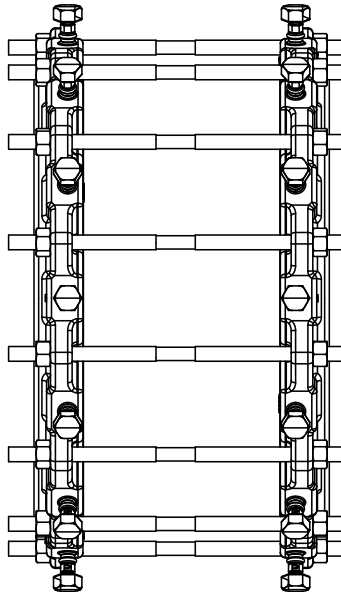

NOMINAL PIPE SIZE	PIPE O.D. RANGE (INCHES)	SLEEVE LENGTH	DEGREES DEFLECTION	NO. OF RODS	SIZE OF RODS	APPROX. WT. LBS	PART NUMBER	✓ SUBMITTED ITEM(S)
14"	15.30	10"	3°	10	3/4" x 17"	185	RCPP-1530-1400ST-E-U	
16"	17.40	10"	3°	12	3/4" x 17"	230	RCPP-1740-1600ST-E-U	

FEATURES

- Center Sleeve - Carbon steel per ASTM A36, fusion bonded epoxy coating
- Restraint Gland Ends - Ductile iron per ASTM A536, e-coat epoxy with red top coat
- Double End Rod & Nuts - High strength, low alloy steel per ASTM A242 and AWWA C111
- Gaskets - SBR rubber per ASTM D2000
- Rated for the same pipe on which is it installed with a 2:1 safety factor
- Complies with AWWA C219

The Ford Meter Box Company considers the information in this submittal form to be correct at the time of publication. Item and option availability, including specifications, are subject to change without notice. Please verify that your product information is current. Our standard warranty applies.



The Ford Meter Box Company, Inc.

P.O. Box 443, Wabash, Indiana U.S.A. 46992-0443

Phone: 260-563-3171 / Fax: 800-826-3487

Overseas Fax: 260-563-0167

www.fordmeterbox.com

02/18/22

Submitted By: